



Asbestos Reassessment

Father Kyran
90 Mulberry Street, Hamilton,
Ontario

Prepared for:

**Hamilton-Wentworth Catholic
District School Board**

90 Mulberry Street
Hamilton, Ontario, L8N 3R9

August 23, 2022

Pinchin File: 303992.004



Asbestos Reassessment

Father Kyran, 90 Mulberry Street, Hamilton, Ontario
Hamilton-Wentworth Catholic District School Board

August 23, 2022
Pinchin File: 303992.004

Issued to: Hamilton-Wentworth Catholic District
School Board

Issued on: August 23, 2022

Pinchin File: 303992.004

Issuing Office: Hamilton, ON

Pinchin Contact: Emily Balfour, Project Manager
365.889.5147
ebalfour@pinchin.com



Hamilton-Wentworth
Catholic District School Board
Believing. Achieving. Serving

Author: _____

Emily Balfour
Project Manager
365.889.5147
ebalfour@pinchin.com

Reviewer: _____

Damian Palus, C.E.T.
Operations Manager
289.678.0694
dpalus@pinchin.com



EXECUTIVE SUMMARY

Hamilton-Wentworth Catholic District School Board (Client) retained Pinchin Ltd. (Pinchin) to conduct an asbestos building materials reassessment at the subject building.

The objective of the reassessment was to evaluate the condition and quantity of previously reported asbestos-containing materials (ACM), and develop corrective action plans as required for the purposes of long-term management. The results of this reassessment are not intended for construction, renovation, demolition or project tendering purposes.

Summary of Recommendations

The following is a summary of significant recommendations; refer to the body of the report for detailed recommendations:

- Perform a reassessment of asbestos materials on an annual basis.
- Perform a pre-construction assessment and remove all asbestos-containing materials (ACM) prior to alteration or maintenance work if ACM may be disturbed by the work.
- Follow appropriate safe work procedures when handling or disturbing asbestos.
- Sample any presumed ACM prior to alteration or maintenance work if presumed ACM may be disturbed by the work.

This Executive Summary is subject to the same standard limitations as contained in the report and must be read in conjunction with the entire report.



Asbestos Reassessment

Father Kyran, 90 Mulberry Street, Hamilton, Ontario
Hamilton-Wentworth Catholic District School Board

August 23, 2022
Pinchin File: 303992.004

TABLE OF CONTENTS

1.0	INTRODUCTION AND SCOPE	1
1.1	Scope of Assessment	1
2.0	BACKGROUND INFORMATION	1
2.1	Building Year of Construction	1
2.2	Existing Reports	1
2.3	Inaccessible Locations	2
3.0	FINDINGS	2
3.1	Excluded Asbestos Materials	2
3.2	Confirmed/Presumed Asbestos-Containing Materials and Confirmed Non-Asbestos Materials	3
4.0	RECOMMENDATIONS	9
4.1	General	9
4.2	Remedial Work	9
4.3	On-going Management and Maintenance	9
5.0	TERMS AND LIMITATIONS	9
6.0	REFERENCES	10

APPENDICES

APPENDIX I	Asbestos Analytical Certificates
APPENDIX II	Location List
APPENDIX III	Hazardous Materials Summary / Sample Log Report
APPENDIX IV	All Data Report
APPENDIX V	Drawings



1.0 INTRODUCTION AND SCOPE

Hamilton-Wentworth Catholic District School Board (Client) retained Pinchin Ltd. (Pinchin) to conduct an asbestos building materials reassessment at Father Kyran Kennedy, located at 90 Mulberry Street, Hamilton, Ontario.

The reassessment was performed by Matthew Pitman, Project Technologist on May 24, 2022.

The objectives of the reassessment were to document the locations, quantities and conditions of previously identified asbestos-containing building materials, and develop corrective action plans as required. This reassessment is only to be used for the purposes of long-term management and routine maintenance. The results of this reassessment are not to be used for construction, renovation, demolition or project tendering purposes.

1.1 Scope of Assessment

The objective of the reassessment was to evaluate the condition and quantity of previously reported asbestos-containing materials (ACM's), and develop corrective action plans as required.

Refer to the Asbestos Building Materials Reassessment Methodology report and Annex A dated 2022, Pinchin File 303992.004, for the methodology used during the reassessment.

2.0 BACKGROUND INFORMATION

2.1 Building Year of Construction

Item	Details
Year of Construction	1965

2.2 Existing Reports

2.2.1 Review of Previous Reports

Pinchin previously prepared the following reports, which have been reviewed and relied upon as part of this assessment:

- Asbestos Assessment, Father Kyran Kennedy, 90 Mulberry Street, Hamilton, Ontario, September 2018, Prepared by Pinchin Ltd., Pinchin File: 224334.
- Asbestos Reassessment, Father Kyran Kennedy, 90 Mulberry Street, Hamilton, Ontario, September 2019, Prepared by Pinchin Ltd., Pinchin File: 243241.
- Asbestos Reassessment, Father Kyran Kennedy, 90 Mulberry Street, Hamilton, Ontario, June 2020, Prepared by Pinchin Ltd., Pinchin File: 272113.



Asbestos Reassessment

Father Kyran, 90 Mulberry Street, Hamilton, Ontario
Hamilton-Wentworth Catholic District School Board

August 23, 2022
Pinchin File: 303992.004

- Asbestos Reassessment, Father Kyran Kennedy, 90 Mulberry Street, Hamilton, Ontario, July 2021, Prepared by Pinchin Ltd., Pinchin File: 286533.001.

2.3 Inaccessible Locations

The following rooms or areas, were not accessible to the surveyor and are therefore not included in the report:

Location and Location #	Reason
Server Room (Location 2007)	Locked, no key available

3.0 FINDINGS

The following section summarizes the findings of the reassessment and provides a general description of the asbestos materials identified. For details on quantities, assessment, sample numbers, friability, condition, and locations of asbestos materials; refer to the Hazardous Materials Summary / Sample Log Report and All Data Report in Appendices III and IV, respectively.

Previous analytical sample results have been relied upon and were included in the original asbestos assessment report completed by MTE Consultants Inc. Additional samples results where collected by Pinchin have been included in Appendix I.

3.1 Excluded Asbestos Materials

A number of materials which might contain asbestos were not sampled during this reassessment due to limitations in scope and methodology. Where present, these materials are assumed to contain asbestos until otherwise proven by sampling and analysis. These materials are not shown on the drawings in Appendix V. Excluded materials presumed to contain asbestos include:



Material	Friability
Roofing, felts and tar	Non-friable
Concrete floor levelling compound	Non-friable
Elevator and lift brakes	Non-friable
Electrical components or wiring within control centers, breakers, motors or lights, insulation on wiring	Non-friable
Vermiculite in concrete block wall cavities	Friable
Adhesives and duct mastics	Non-friable

Material	Friability
Caulking and butyl seals	Non-friable
Fibre reinforced paints and coatings	Non-friable
Paper products	Non-friable
Soffit and fascia boards	Non-friable
Mechanical packing, ropes and gaskets	Non-friable
Vinyl baseboards	Non-friable
Exterior cladding	Non-friable
Fire resistant doors or metal clad finishes	Non-friable
Vibration dampers on HVAC equipment	Non-friable

3.2 Confirmed/Presumed Asbestos-Containing Materials and Confirmed Non-Asbestos Materials

This section includes materials that have been confirmed asbestos-containing by sample analysis or presumed asbestos-containing by visual identification. Refer to the drawings in Appendix V for the locations of confirmed and presumed ACMs indicated via hatching or symbols. The locations of samples from the historical assessments, performed by Pinchin, have been included on the drawings.

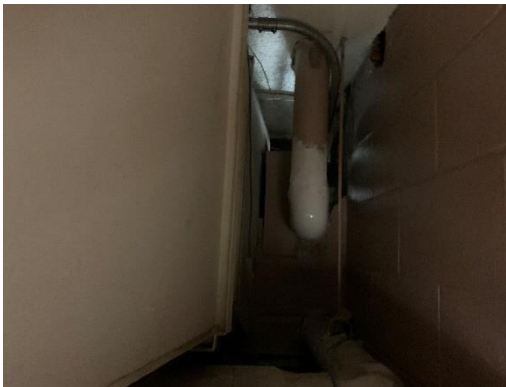
Material and Application	Asbestos Type/Friability	Photo
<p>Texture finish is present on ceilings in the Hearing Room (Location 1001) and the Boardroom (Location 1002).</p> <p>Overspray from the asbestos-containing texture coat is presumed to be present above the ceiling at light fixture openings, on the deck, ducts and within junction boxes.</p>	Chrysotile/Friable	
Non-asbestos texture finish is present on drywall walls in the Chapel (Location 3004).	None	



Material and Application	Asbestos Type/Friability	Photo
<p>Parging cement is present on pipe fittings (elbows, valves, tees, hangers etc.).</p> <p>Pipes insulated with asbestos-containing insulations may be present in inaccessible spaces such as above solid ceilings, in chases, in column enclosures and within shafts</p>	Chrysotile/Friable	
Remaining pipes are either uninsulated or insulated with non-asbestos fibreglass or elastomeric insulation (Armaflex).	None	
Ducts are either uninsulated or insulated with non-asbestos fibreglass.	None	
Mechanical equipment is either uninsulated or insulated with non-asbestos fibreglass.	None	
12"x12" glued-on ceiling tiles, with a fissured pattern are present.	Amosite/Non-friable	
All lay-in ceiling tiles were determined to be non-asbestos by previous sampling or are presumed to be non-asbestos based on	None	

**Asbestos Reassessment**



Father Kyran, 90 Mulberry Street, Hamilton, Ontario
Hamilton-Wentworth Catholic District School Board

August 23, 2022
Pinchin File: 303992.004

Material and Application	Asbestos Type/Friability	Photo
the date of manufacture determined from the date stamp applied to the top of the tiles.		
Textured plaster present on ceilings throughout the basement floor does not contain asbestos.	None	
Rough textured plaster present on columns throughout the basement floor does not contain asbestos.	None	
Smooth plaster present on walls and ceilings throughout the building does not contain asbestos.	None	
Non-asbestos drywall joint compound is present on wall finishes.	None	
Vinyl floor tiles, 9"x9", beige with brown streaks, are present.	Presumed/Non-friable (tile) Presumed/Non-friable (mastic)	

Material and Application	Asbestos Type/Friability	Photo
Vinyl floor tiles, 12"x12", white with brown and black streaks, are present.	Presumed/Non-friable (tile) Presumed/Non-friable (mastic)	
Vinyl floor tiles, 12"x12", grey marble, are present.	Presumed/Non-friable (tile) Presumed/Non-friable (mastic)	
Vinyl floor tiles, 12"x12", white with grey, are present.	Presumed/Non-friable (tile) Presumed/Non-friable (mastic)	

Material and Application	Asbestos Type/Friability	Photo
Vinyl floor tiles, 12"x12", beige marble, are present.	Presumed/Non-friable (tile) Presumed/Non-friable (mastic)	
Vinyl floor tiles, 12"x12", beige with light and dark streaks, are present.	Presumed/Non-friable (tile) Presumed/Non-friable (mastic)	
Vinyl floor tiles, 12"x12", pink marble, are present.	Presumed/Non-friable (tile) Presumed/Non-friable (mastic)	

Material and Application	Asbestos Type/Friability	Photo
Vinyl floor tiles, 12"x12", cream with brown and white specks, are present.	Presumed/Non-friable (tile) Presumed/Non-friable (mastic)	
Vinyl floor tiles, 12"x12", brown with multi-brown fleck, are present.	Presumed/Non-friable (tile) Presumed/Non-friable (mastic)	
Mastic is present on the concrete floor or presumed present under new flooring.	Presumed/Non-friable	
Gold mastic is present as a sink undercoating.	Presumed/Non-friable	

Additional notes on the drywall joint compound discussed above:

- Drywall (gypsum board) and drywall joint compound is present as a wall and ceiling finish throughout the building. As per the methodology, drywall joint compound is sampled at exterior



walls, columns or other locations that are unlikely to have been renovated in an attempt to determine the presence of asbestos in the original drywall compound. A total of 9 samples of drywall joint compound were collected (samples S0004A-C, S0006A-C, S0008A-C, lab reference no. 71921704) and it was found that all samples do not contain asbestos. Therefore, drywall joint compound present on drywall finishes should be considered to be non-asbestos.

4.0 RECOMMENDATIONS

4.1 General

Perform a detailed intrusive assessment prior to building renovation or demolition operations. The assessment should include; destructive testing (i.e. coring and/or removal of building finishes and components), sampling of other hazardous materials (lead, mercury, PCBs, mould, etc.), and materials not tested in this study (i.e. excluded asbestos materials).

4.2 Remedial Work

There is no remedial work recommended.

4.3 On-going Management and Maintenance

The following recommendations are made regarding on-going management and maintenance work involving the asbestos materials identified.

4.3.1 Asbestos

Maintain the Asbestos Management Program (AMP).

Perform a reassessment of asbestos materials on an annual basis.

Remove asbestos-containing materials (ACM) prior to alteration or maintenance work if ACM may be disturbed by the work. Follow appropriate asbestos precautions for the classification of work being performed.

Sample presumed ACM prior to alteration or maintenance work if the presumed ACM may be disturbed by the work.

Update the asbestos inventory report upon completion of any abatement and removal of asbestos-containing materials.

5.0 TERMS AND LIMITATIONS

This work was performed subject to the Terms and Limitations presented or referenced in the proposal for this project.



Information provided by Pinchin is intended for Client use only. Pinchin will not provide results or information to any party unless disclosure by Pinchin is required by law. Any use by a third party of reports or documents authored by Pinchin or any reliance by a third party on or decisions made by a third party based on the findings described in said documents, is the sole responsibility of such third parties. Pinchin accepts no responsibility for damages suffered by any third party as a result of decisions made or actions conducted. No other warranties are implied or expressed.

6.0 REFERENCES

The following legislation and documents were referenced in completing the assessment and this report:

1. Asbestos on Construction Projects and in Buildings and Repair Operations, Ontario Regulation 278/05.
2. Designated Substances, Ontario Regulation 490/09.

J:\303000s\0303992.000 HWCDSB, Various2022Projects, ASB, CONS\0303992.004 HWCDSB, AllFacilities, 2022, ASB, REASSMT\Deliverables\Admin\Father Kyran Kennedy Catholic Education Centre\Report\303992.004 Father Kyran Kennedy CEC ACM Report HWCDSB Aug 23 2022.docx

Template: Master Report for Asbestos Reassessment, HAZ, April 23, 2019

APPENDIX I
Asbestos Analytical Certificates



Pinchin Ltd. Asbestos Laboratory Certificate of Analysis

Project Name: HWCDSB, Father Kryan Kennedy Education Centre
90 Mulberry St Hamilton
Project No.: 0224334.000
Prepared For: F. Rossi / M. Maiorana
Lab Reference No.: b194016
Analyst(s): N. Barinque
Date Received: July 27, 2018 **# Samples submitted:** 6
Date Analyzed: August 3, 2018 **# Phases analyzed:** 14

Method of Analysis:

EPA 600/R-93/116 - Method for the Determination of Asbestos in Bulk Building Materials dated July, 1993

Bulk samples are checked visually and scanned under a stereomicroscope. Slides are prepared and observed under a Polarized Light Microscope (PLM) at magnifications of 40X, 100X or 400X as appropriate. Asbestos fibres are identified by a combination of morphology, colour, refractive index, extinction, sign of elongation, birefringence and dispersion staining colours. A visual estimate is made of the percentage of asbestos present. A reported concentration of less than (<) the regulatory threshold (see chart below) indicates the presence of confirmed asbestos in trace quantities, limited to only a few fibres or fibre bundles in an entire sample. This method complies with provincial regulatory requirements where applicable. Multiple phases within a sample are analyzed and reported separately.

Provincial Jurisdiction	Regulatory Threshold	Provincial Jurisdiction	Regulatory Threshold
Ontario, British Columbia, Nova Scotia	0.5%	Alberta	Undefined
Quebec	0.1%	Saskatchewan	0.5% friable 1% non-friable
PEI, NWT, Yukon, Nunavut, Newfoundland and Labrador, and New Brunswick	1%	Manitoba	0.1% friable 1% non-friable

All bulk samples submitted to this laboratory for asbestos analysis are retained for a minimum of three months. Samples may be retrieved, upon request, for re-examination at any time during that period.

Pinchin Ltd. is accredited by the National Institute of Standards and Technology, National Voluntary Laboratory Accreditation Program (NVLAP Lab Code 101270-0) for the 'EPA-600/M4-82-020: Interim Method for the Determination of Asbestos in Bulk Insulation Samples,' and the 'EPA 600/R-93/116: Method for the Determination of Asbestos in Bulk Building Materials'; and meets all requirements of ISO/IEC 17025:2005.

This report relates only to the items tested.

NOTE: *This test report may not be reproduced, except in full, without the written approval of the laboratory. The client may not use this report to claim product endorsement by NVLAP or any agency of the U.S. Government. This report is valid only when signed in blue ink by the analyst. Vinyl asbestos floor tiles contain very fine fibres of asbestos and may be missed by some laboratories using the PLM method. Internal verification studies performed by Pinchin indicate that the chance of missing asbestos in floor tiles is no higher than about 2%. The vinyl tile study and laboratory documentation on measurement uncertainty is available upon request. The analysis of dust samples by PLM cannot be used as an indicator of past or present airborne asbestos fibre levels.*



Pinchin Ltd. Asbestos Laboratory Certificate of Analysis

Project Name: HWCDSB, Father Kryan Kennedy Education Centre
90 Mulberry St Hamilton
Project No.: 0224334.000
Prepared For: F. Rossi / M. Maiorana

Lab Reference No.: b194016
Date Analyzed: August 3, 2018

BULK SAMPLE ANALYSIS

SAMPLE IDENTIFICATION	SAMPLE DESCRIPTION	% COMPOSITION (VISUAL ESTIMATE)	
		ASBESTOS	OTHER
0001A plaster wall stairwell B014	2 Phases: a) Homogeneous, grey, hard, cementitious, plaster base coat.	None Detected	Perlite 10-25% Other Non-Fibrous > 75%
	b) Homogeneous, white, hard, cementitious, plaster top coat.	None Detected	Non-Fibrous Material > 75%
0001B plaster wall stairwell B014	2 Phases: a) Homogeneous, grey, hard, cementitious, plaster base coat.	None Detected	Perlite 10-25% Other Non-Fibrous > 75%
	b) Homogeneous, white, hard, cementitious, plaster top coat.	None Detected	Non-Fibrous Material > 75%
0001C plaster wall stairwell B014	Homogeneous, white, hard, cementitious plaster.	None Detected	Non-Fibrous Material > 75%
0002A Textured plaster ceiling B001	3 Phases: a) Homogeneous, grey, hard, cementitious, plaster base coat.	None Detected	Non-Fibrous Material > 75%
	b) Homogeneous, white, hard, cementitious, plaster top coat.	None Detected	Non-Fibrous Material > 75%
	c) Homogeneous, grey, finishing or texture coat.	None Detected	Perlite 25-50% Other Non-Fibrous 50-75%



Pinchin Ltd. Asbestos Laboratory
Certificate of Analysis

Project Name: HWCDSB, Father Kryan Kennedy Education Centre
90 Mulberry St Hamilton
Project No.: 0224334.000
Prepared For: F. Rossi / M. Maiorana

Lab Reference No.: b194016
Date Analyzed: August 3, 2018

BULK SAMPLE ANALYSIS

SAMPLE IDENTIFICATION	SAMPLE DESCRIPTION	% COMPOSITION (VISUAL ESTIMATE)	
		ASBESTOS	OTHER
0002B Textured plaster ceiling B001	3 Phases: a) Homogeneous, grey, hard, cementitious, plaster base coat.	None Detected	Non-Fibrous Material > 75%
	b) Homogeneous, white, hard, cementitious, plaster top coat.	None Detected	Non-Fibrous Material > 75%
	c) Homogeneous, grey, finishing or texture coat.	None Detected	Perlite 25-50% Other Non-Fibrous 50-75%
0002C Textured plaster ceiling B001	3 Phases: a) Homogeneous, grey, hard, cementitious, plaster base coat.	None Detected	Non-Fibrous Material > 75%
	b) Homogeneous, white, hard, cementitious, plaster top coat.	None Detected	Non-Fibrous Material > 75%
	c) Homogeneous, grey, finishing or texture coat.	None Detected	Perlite 25-50% Other Non-Fibrous 50-75%

Reviewed by:

Reporting Analyst:



C.C

Analyzed by: MB
Reviewed by: MB
Report Sent by: MB

(14)

Instructions:

**Pinchin Ltd. - Asbestos Laboratory
Internal Asbestos Bulk Sample Chain of Custody**

Client Name:	HWCD SB		Project Address:	90 Mulberry St Hamilton			
Portfolio/Building No:	Father Kryan Kennedy Education Centre		Pinchin File:	224334			
Submitted by:	Frank Rossi		Email:	frossi@pinchin.com			
CC Results to:	Mike Maiorana		CC Email:	mmaiorana@pinchin.com			
Invoice to:	ap@pinchin.com		Invoice Email:				
Date Submitted:	July	26	2018	Required by:	August	3	2018
# of Samples:	6		Priority:	5 Day Turnaround			
Year of Building Construction (Mandatory Field):							
Do NOT Stop on Positive (Sample Numbers):							
Pinchin Group Company (Mandatory Field):				Pinchin			

To be Completed by Lab Personnel Only:

Lab Reference #:	6194016		Time:	24 hour clock		
Received by:	JUL 27 2018 JA		Date:	Month	Day	Year
Name(s) of Analyst(s):	MB 17 08 - 03					

Sample Prefix	Sample No.	Sample Suffix	Sample Description/Location (Mandatory)
	0001	A	plaster wall stairwell B014 a) ND b) ND
	0001	B	plaster wall stairwell B014 a) ND b) ND
	0001	C	plaster wall stairwell B014 ND
	0002	A	Textured plaster ceiling B001 a) ND b) ND c) ND
	0002	B	Textured plaster ceiling B001 a) ND b) ND c) ND
	0002	C	Textured plaster ceiling B001 a) ND b) ND c) ND



Bulk Asbestos Analysis

By Polarized Light Microscopy
EPA Method: 600/R-93/116 and 40 CFR, Part 763, Subpart E,
App.E



Customer: Pinchin Ltd.
6-875 Main St West
Suite 200
Hamilton, Ontario L8S 4P9

Attn: Emily Balfour
Michael Maiorana

Lab Order ID: 71921704
Analysis ID: 71921704_PLM
Date Received: 8/19/2019
Date Reported: 8/23/2019

Project: 230748,90 Mulberry Street, Hamilton, Ontario, Hamilton-Wentworth Catholic School Board, Father Kyran Kennedy

Sample ID	Description	Asbestos	Fibrous Components	Non-Fibrous Components	Attributes
Lab Sample ID	Lab Notes				Treatment
S0002D - A	Textured plaster on ceiling, Print Room, Location 7	None Detected		100% Other	Gray Non Fibrous Heterogeneous
71921704PLM_1	texture				Crushed
S0002D - B	Textured plaster on ceiling, Print Room, Location 7	None Detected		100% Other	White Non Fibrous Homogeneous
71921704PLM_25	finish; no base				Crushed
S0002E - A	Textured plaster on ceiling, Shipping, Location 9	None Detected		100% Other	Gray Non Fibrous Heterogeneous
71921704PLM_2	texture				Crushed
S0002E - B	Textured plaster on ceiling, Shipping, Location 9	None Detected		100% Other	White Non Fibrous Homogeneous
71921704PLM_26	finish				Crushed
S0002E - C	Textured plaster on ceiling, Shipping, Location 9	None Detected		100% Other	Gray Non Fibrous Heterogeneous
71921704PLM_27	base; very small sample				Crushed
S0003A	Textured plaster on column, Boiler Room, Location 13	None Detected		100% Other	Gray Non Fibrous Heterogeneous
71921704PLM_3	single layer plaster; no texture				Crushed
S0003B	Textured plaster on column, Shipping, Location 9	None Detected	10% Cellulose	90% Other	Gray Non Fibrous Heterogeneous
71921704PLM_4	single layer plaster; no texture				Crushed
S0003C	Textured plaster on column, Storage, Location 4	None Detected	10% Cellulose	90% Other	Gray Non Fibrous Heterogeneous
71921704PLM_5	single layer plaster; no texture				Crushed

Disclaimer: Due to the nature of the EPA 600 method, asbestos may not be detected in samples containing low levels of asbestos. We strongly recommend that analysis of floor tiles, vermiculite, and/or heterogeneous soil samples be conducted by TEM for confirmation of "None Detected" by PLM. This report relates only to the samples tested and may not be reproduced, except in full, without the written approval of SAL. This report may not be used by the client to claim product endorsement by NVLAP or any other agency of the U.S. government. Analytical uncertainty available upon request. Scientific Analytical Institute participates in the NVLAP Proficiency Testing program. Unless otherwise noted blank sample correction was not performed. Estimated MDL is 0.1%.

Megan Javonovich (34)

Analyst

Approved Signatory



Bulk Asbestos Analysis

By Polarized Light Microscopy
EPA Method: 600/R-93/116 and 40 CFR, Part 763, Subpart E,
App.E



Customer: Pinchin Ltd. 6-875 Main St West Suite 200 Hamilton, Ontario L8S 4P9	Attn: Emily Balfour Michael Maiorana	Lab Order ID: 71921704 Analysis ID: 71921704_PLM Date Received: 8/19/2019 Date Reported: 8/23/2019
Project: 230748,90 Mulberry Street, Hamilton, Ontario, Hamilton-Wentworth Catholic School Board, Father Kyran Kennedy		

Sample ID	Description	Asbestos	Fibrous Components	Non-Fibrous Components	Attributes
Lab Sample ID	Lab Notes				Treatment
S0004A	Drywall joint compound on wall, Print Room, Location 7	None Detected	5% Cellulose	95% Other	White Fibrous Homogeneous
71921704PLM_6					Crushed
S0004B	Drywall joint compound on wall, Shipping, Location 9	None Detected		100% Other	White Non Fibrous Homogeneous
71921704PLM_7					Crushed
S0004C	Drywall joint compound on wall, Storage, Location 4	None Detected		100% Other	White Non Fibrous Homogeneous
71921704PLM_8					Crushed
S0005A - A	Smooth plaster on wall, Kitchenette, Location 1003	None Detected		100% Other	White Non Fibrous Homogeneous
71921704PLM_9	finish				Crushed
S0005A - B	Smooth plaster on wall, Kitchenette, Location 1003	None Detected		100% Other	Gray Non Fibrous Heterogeneous
71921704PLM_28	base; small sample				Crushed
S0005B - A	Smooth plaster on wall, Women's Washroom, Location 1009	None Detected		100% Other	White Non Fibrous Homogeneous
71921704PLM_10	finish				Crushed
S0005B - B	Smooth plaster on wall, Women's Washroom, Location 1009	None Detected		100% Other	Gray Non Fibrous Heterogeneous
71921704PLM_29	base; small sample				Crushed
S0005C - A	Smooth plaster on wall, Open Office Area, Location 2023	None Detected		100% Other	White Non Fibrous Homogeneous
71921704PLM_11	finish				Crushed

Disclaimer: Due to the nature of the EPA 600 method, asbestos may not be detected in samples containing low levels of asbestos. We strongly recommend that analysis of floor tiles, vermiculite, and/or heterogeneous soil samples be conducted by TEM for confirmation of "None Detected" by PLM. This report relates only to the samples tested and may not be reproduced, except in full, without the written approval of SAI. This report may not be used by the client to claim product endorsement by NVLAP or any other agency of the U.S. government. Analytical uncertainty available upon request. Scientific Analytical Institute participates in the NVLAP Proficiency Testing program. Unless otherwise noted blank sample correction was not performed. Estimated MDL is 0.1%.

Megan Javonovich (34)

Analyst

Approved Signatory



Bulk Asbestos Analysis

By Polarized Light Microscopy
EPA Method: 600/R-93/116 and 40 CFR, Part 763, Subpart E,
App.E



Customer: Pinchin Ltd.
6-875 Main St West
Suite 200
Hamilton, Ontario L8S 4P9

Attn: Emily Balfour
Michael Maiorana

Lab Order ID: 71921704
Analysis ID: 71921704_PLM
Date Received: 8/19/2019
Date Reported: 8/23/2019

Project: 230748,90 Mulberry Street, Hamilton, Ontario, Hamilton-Wentworth Catholic School Board, Father Kyran Kennedy

Sample ID	Description	Asbestos	Fibrous Components	Non-Fibrous Components	Attributes
Lab Sample ID	Lab Notes				Treatment
S0005C - B	Smooth plaster on wall, Open Office Area, Location 2023	None Detected	12% Cellulose	88% Other	Gray Non Fibrous Heterogeneous
71921704PLM_30	base				Crushed
S0005D - A	Smooth plaster on ceiling, Women's Washroom, Location 2019	None Detected		100% Other	White Non Fibrous Homogeneous
71921704PLM_12	finish				Crushed
S0005D - B	Smooth plaster on ceiling, Women's Washroom, Location 2019	None Detected		100% Other	Gray Non Fibrous Heterogeneous
71921704PLM_31	base; small sample				Crushed
S0005E - A	Smooth plaster on wall, Women's Washroom, Location 3010	None Detected		100% Other	White Non Fibrous Homogeneous
71921704PLM_13	finish				Crushed
S0005E - B	Smooth plaster on wall, Women's Washroom, Location 3010	None Detected		100% Other	Gray Non Fibrous Heterogeneous
71921704PLM_32	base; very small sample				Crushed
S0005F - A	Smooth plaster on wall, Office, Location 3013	None Detected		100% Other	White Non Fibrous Homogeneous
71921704PLM_14	finish				Crushed
S0005F - B	Smooth plaster on wall, Office, Location 3013	None Detected		100% Other	Gray Non Fibrous Heterogeneous
71921704PLM_33	base; very small sample				Crushed
S0005G - A	Smooth plaster on wall, Men's Washroom, Location 3008	None Detected		100% Other	White Non Fibrous Homogeneous
71921704PLM_15	finish				Crushed

Disclaimer: Due to the nature of the EPA 600 method, asbestos may not be detected in samples containing low levels of asbestos. We strongly recommend that analysis of floor tiles, vermiculite, and/or heterogeneous soil samples be conducted by TEM for confirmation of "None Detected" by PLM. This report relates only to the samples tested and may not be reproduced, except in full, without the written approval of SAL. This report may not be used by the client to claim product endorsement by NVLAP or any other agency of the U.S. government. Analytical uncertainty available upon request. Scientific Analytical Institute participates in the NVLAP Proficiency Testing program. Unless otherwise noted blank sample correction was not performed. Estimated MDL is 0.1%.

Megan Javonovich (34)

Analyst

Approved Signatory



Bulk Asbestos Analysis

By Polarized Light Microscopy
EPA Method: 600/R-93/116 and 40 CFR, Part 763, Subpart E,
App.E



Customer: Pinchin Ltd.
6-875 Main St West
Suite 200
Hamilton, Ontario L8S 4P9

Attn: Emily Balfour
Michael Maiorana

Lab Order ID: 71921704
Analysis ID: 71921704_PLM
Date Received: 8/19/2019
Date Reported: 8/23/2019

Project: 230748,90 Mulberry Street, Hamilton, Ontario, Hamilton-Wentworth Catholic School Board, Father Kyran Kennedy

Sample ID	Description	Asbestos	Fibrous Components	Non-Fibrous Components	Attributes
Lab Sample ID	Lab Notes				Treatment
S0005G - B	Smooth plaster on wall, Men's Washroom, Location 3008	None Detected		100% Other	Gray Non Fibrous Heterogeneous
71921704PLM_34	base; small sample				Crushed
S0006A	Drywall joint compound on wall, Photography Room, Location 2025	None Detected		100% Other	White Non Fibrous Homogeneous
71921704PLM_16					Crushed
S0006B	Drywall joint compound on wall, Office, Location 2016	None Detected		100% Other	White Non Fibrous Homogeneous
71921704PLM_17					Crushed
S0006C	Drywall joint compound on wall, Staff Room, Location 2012	None Detected		100% Other	White Non Fibrous Homogeneous
71921704PLM_18					Crushed
S0007A	Texture finish on drywall, Chapel, Location 3004	None Detected		100% Other	Beige Non Fibrous Homogeneous
71921704PLM_19	small sample				Crushed
S0007B	Texture finish on drywall, Chapel, Location 3004	None Detected		100% Other	Beige, White Non Fibrous Homogeneous
71921704PLM_20					Crushed
S0007C	Texture finish on drywall, Chapel, Location 3004	None Detected		100% Other	White, Beige Non Fibrous Homogeneous
71921704PLM_21					Crushed
S0008A	Drywall joint compound on wall, Office, Location 3015	None Detected		100% Other	White Non Fibrous Homogeneous
71921704PLM_22	small sample				Crushed

Disclaimer: Due to the nature of the EPA 600 method, asbestos may not be detected in samples containing low levels of asbestos. We strongly recommend that analysis of floor tiles, vermiculite, and/or heterogeneous soil samples be conducted by TEM for confirmation of "None Detected" by PLM. This report relates only to the samples tested and may not be reproduced, except in full, without the written approval of SAI. This report may not be used by the client to claim product endorsement by NVLAP or any other agency of the U.S. government. Analytical uncertainty available upon request. Scientific Analytical Institute participates in the NVLAP Proficiency Testing program. Unless otherwise noted blank sample correction was not performed. Estimated MDL is 0.1%.

Megan Javonovich (34)

Analyst

Approved Signatory



Bulk Asbestos Analysis

By Polarized Light Microscopy
EPA Method: 600/R-93/116 and 40 CFR, Part 763, Subpart E,
App.E



Customer: Pinchin Ltd.
6-875 Main St West
Suite 200
Hamilton, Ontario L8S 4P9

Attn: Emily Balfour
Michael Maiorana

Lab Order ID: 71921704
Analysis ID: 71921704_PLM
Date Received: 8/19/2019
Date Reported: 8/23/2019

Project: 230748,90 Mulberry Street, Hamilton, Ontario, Hamilton-Wentworth Catholic School Board, Father Kyran Kennedy

Sample ID	Description	Asbestos	Fibrous Components	Non-Fibrous Components	Attributes
Lab Sample ID	Lab Notes				Treatment
S0008B	Drywall joint compound on wall, Reception, Location 3005	None Detected		100% Other	White Non Fibrous Homogeneous
71921704PLM_23					Crushed
S0008C	Drywall joint compound on wall, Conference Room, Location 3001	None Detected		100% Other	White Non Fibrous Homogeneous
71921704PLM_24					Crushed

Disclaimer: Due to the nature of the EPA 600 method, asbestos may not be detected in samples containing low levels of asbestos. We strongly recommend that analysis of floor tiles, vermiculite, and/or heterogeneous soil samples be conducted by TEM for confirmation of "None Detected" by PLM. This report relates only to the samples tested and may not be reproduced, except in full, without the written approval of SAI. This report may not be used by the client to claim product endorsement by NVLAP or any other agency of the U.S. government. Analytical uncertainty available upon request. Scientific Analytical Institute participates in the NVLAP Proficiency Testing program. Unless otherwise noted blank sample correction was not performed. Estimated MDL is 0.1%.

Megan Javonovich (34)

Analyst

Approved Signatory

71921704

Version 1-15-2012

Client:	Pinchin Ltd.	<p>*Instructions: Use Column "B" for your contact info</p> <p>To See an Example Click the bottom Example Tab.</p> <p>Enter samples between "<<" and ">>"</p> <p>Begin Samples with a "<<" above the first sample and end with a ">>" below the last sample. Only Enter your data on the first sheet "Sheet1"</p> <p>Note: Data 1 and Data 2 are optional fields that do not show up on the official report, however they will be included in the electronic data returned to you to facilitate your reintegration of the report data.</p>	Invoice to:
Contact:	Emily Balfour		ap@pinchin.com
Address:	6-875 Main Street West, Suite 200, Hamilton ON L8S 4P9		 <p>Scientific Analytical Institute</p>
Phone:	905-577-6206		
Fax:	905-577-6207		
Email:	ebalfour@pinchin.com mmaiorana@pinchin.com		
Project:	230748,90 Mulberry Street, Hamilton, Ontario, Hamilton-Wentworth Catholic School Board, Father Kyran Kennedy		
Client Notes:			
P.O. #.	230748		4604 Dundas Dr.
Date Submitted:	August 16, 2019		Greensboro, NC 27407
Analysis:	PLM - Stop Positive	Phone: 336.292.3888	
TurnAroundTime:	4days	Fax: 336.292.3313	
		Email: lab@sailab.com	

Sample Number	Data 1 (Lab use only)	Sample Description	Data 2 (Lab use only)
<<			
S0002D		Textured plaster on ceiling, Print Room, Location 7	
S0002E		Textured plaster on ceiling, Shipping, Location 9	
S0003A		Textured plaster on column, Boiler Room, Location 13	
S0003B		Textured plaster on column, Shipping, Location 9	
S0003C		Textured plaster on column, Storage, Location 4	
S0004A		Drywall joint compound on wall, Print Room, Location 7	
S0004B		Drywall joint compound on wall, Shipping, Location 9	
S0004C		Drywall joint compound on wall, Storage, Location 4	
S0005A		Smooth plaster on wall, Kitchenette, Location 1003	
S0005B		Smooth plaster on wall, Women's Washroom, Location 1009	
S0005C		Smooth plaster on wall, Open Office Area, Location 2023	
S0005D		Smooth plaster on ceiling, Women's Washroom, Location 2019	
S0005E		Smooth plaster on wall, Women's Washroom, Location 3010	

B. Sullivan
8/19
1030X

Accepted ☒

Rejected ☐

11924704

S0005F

Smooth plaster on wall, Office, Location 3013

S0005G

Smooth plaster on wall, Men's Washroom, Location 3008

S0006A

Drywall joint compound on wall, Photography Room, Location 2025

S0006B

Drywall joint compound on wall, Office, Location 2016

S0006C

Drywall joint compound on wall, Staff Room, Location 2012

S0007A

Texture finish on drywall, Chapel, Location 3004

S0007B

Texture finish on drywall, Chapel, Location 3004

S0007C

Texture finish on drywall, Chapel, Location 3004

S0008A

Drywall joint compound on wall, Office, Location 3015

S0008B

Drywall joint compound on wall, Reception, Location 3005

S0008C

Drywall joint compound on wall, Conference Room, Location 3001

>>



Pinchin Ltd. Asbestos Laboratory *Certificate of Analysis*

Project Name:	Hamilton-Wentworth Catholic School Board, Father Kyran Kennedy, 90 Mulberry Street, Hamilton, Ontario		
Project No.:	0272113.000		
Prepared For:	E. Balfour / M. Maiorana		
Lab Reference No.:	b230643	Date Received:	May 21, 2020
Analyst(s):	K. Cockburn	Date Analyzed:	June 1, 2020
		# Samples submitted:	3
		# Phases analyzed:	1

Method of Analysis:

EPA 600/R-93/116 - Method for the Determination of Asbestos in Bulk Building Materials dated July, 1993

Bulk samples are checked visually and scanned under a stereomicroscope. Slides are prepared and observed under a Polarized Light Microscope (PLM) at magnifications of 40X, 100X or 400X as appropriate. Asbestos fibres are identified by a combination of morphology, colour, refractive index, extinction, sign of elongation, birefringence and dispersion staining colours. A visual estimate is made of the percentage of asbestos present. A reported concentration of less than (<) the regulatory threshold (see chart below) indicates the presence of confirmed asbestos in trace quantities, limited to only a few fibres or fibre bundles in an entire sample. This method complies with provincial regulatory requirements where applicable. Multiple phases within a sample are analyzed and reported separately.

All bulk samples submitted to this laboratory for asbestos analysis are retained for a minimum of three months. Samples may be retrieved, upon request, for re-examination at any time during that period.

The Pinchin Ltd. Mississauga asbestos laboratory is accredited by the National Institute of Standards and Technology, National Voluntary Laboratory Accreditation Program (NVLAP Lab Code 101270-0) for the 'EPA – 40 CFR Appendix E to Subpart E of Part 763, Interim Method of the Determination of Asbestos in Bulk Insulation Samples,' and the 'EPA 600/R-93/116: Method for the Determination of Asbestos in Bulk Building Materials'; and meets all requirements of ISO/IEC 17025:2005.

This report relates only to the items tested.

NOTE: *This test report may not be reproduced, except in full, without the written approval of the laboratory. The client may not use this report to claim product endorsement by NVLAP or any agency of the U.S. Government. This report is valid only when signed in blue ink by the analyst. Vinyl asbestos floor tiles contain very fine fibres of asbestos and may be missed by some laboratories using the PLM method. Internal verification studies performed by Pinchin indicate that the chance of missing asbestos in floor tiles is no higher than about 2%. The vinyl tile study and laboratory documentation on measurement uncertainty is available upon request. The analysis of dust samples by PLM cannot be used as an indicator of past or present airborne asbestos fibre levels.*



Pinchin Ltd. Asbestos Laboratory
Certificate of Analysis

Project Name: Hamilton-Wentworth Catholic School Board, Father Kyran Kennedy,
90 Mulberry Street, Hamilton, Ontario
Project No.: 0272113.000
Prepared For: E. Balfour / M. Maiorana
Lab Reference No.: b230643
Date Analyzed: June 1, 2020

BULK SAMPLE ANALYSIS

SAMPLE IDENTIFICATION	SAMPLE DESCRIPTION	% COMPOSITION (VISUAL ESTIMATE)			
		ASBESTOS		OTHER	
S0009A Parging cement, Lunch Room, Location 1	Homogeneous, grey, soft, parging cement.	Chrysotile	50-75%	Non-Fibrous Material	25-50%
S0009B Parging cement, Lunch Room, Location 1				Not Analyzed	
Comments:	Analysis was stopped due to a previous positive result.				
S0009C Parging cement, Lunch Room, Location 1				Not Analyzed	
Comments:	Analysis was stopped due to a previous positive result.				

Reviewed by:

Reporting Analyst:

Analyzed by: Reviewed by: Report Sent by: **Instructions:****Pinchin Ltd. - Asbestos Laboratory
Internal Asbestos Bulk Sample Chain of Custody**

Client Name:	Hamilton-Wentworth Catholic School Board	Project Address:	90 Mulberry Street, Hamilton, Ontario
Portfolio/Building No:	Father Kyran Kennedy	Pinchin File:	272113
Submitted by:	Emily Balfour	Email:	ebalfour@pinchin.com
CC Results to:	Michael Maiorana	CC Email:	mmaiiorana@pinchin.com
Invoice to:	Accounts Payable	Invoice Email:	ap@pinchin.com
Date Submitted:	May 19 2020	Required by:	May 26 2020
# of Samples:	3	Priority:	5 Day Turnaround
Year of Building Construction (Mandatory Field):		1965	
Do NOT Stop on Positive (Sample Numbers):			
Pinchin Group Company (Mandatory Field):		Pinchin	

To be Completed by Lab Personnel Only:

Lab Reference #:	6230643		Time:	24 hour clock		
Received by:	MAY 21 2020		Date:	Month	Day	Year
Name(s) of Analyst(s): KC 2020/06/01						
Sample Prefix	Sample No.	Sample Suffix	Sample Description/Location (Mandatory)			
	S0009	A	Parging cement, Lunch Room, Location 1 CH 50-757.			
	S0009	B	Parging cement, Lunch Room, Location 1 - NA -			
	S0009	C	Parging cement, Lunch Room, Location 1 - NA -			

APPENDIX II
Location List

Client: Hamilton-Wentworth Catholic District Sch

Site: 90 Mulberry Street, Hamilton, ON

Building Name: Father Kyran Kennedy Catholic Education Centre

Survey Date: 2017-09-08

Last Re-Assessment: 2022-05-24

Location No.	Name or Description	Area ft ²	Floor No.	Bldg. Phase	Notes
0	Exterior / General	0	G	A	
1	Lunch Room, room no. B001	0	B	A	
2	Washroom, room no. B002	0	B	A	
3	Storage, room no. B003	0	B	A	
4	Storage, room no. B004	0	B	A	
5	Print Office, room no. B005	0	B	A	
6	Print Office, room no. B006	0	B	A	
7	Print Room, room no. B007	0	B	A	
8	Corridor, room no. B008	0	B	A	
9	Shipping, room no. B009	0	B	A	
10	Shipping Office, room no. B010	0	B	A	
11	Mechanical, room no. B011	0	B	A	
12	Electrical, room no. B012	0	B	A	
13	Records Storage, room no. B013	0	B	A	
14	Stairwell, room no. B014	0	B	A	
15	Storage, room no. B015	0	b	A	
16	Storage, room no. B016	0	B	A	
17	Storage, room no. B017	0	B	A	
1001	Hearing Room	0	1	A	
1002	Board Room	0	1	A	
1003	Kitchenette	0	1	A	
1004	Washroom	0	1	A	
1005	Office	0	1	A	
1006	Office	0	1	A	
1007	Office	0	1	A	
1008	Office	0	1	A	
1009	Womens Washroom	0	1	A	
1010	Mens Washroom	0	1	A	
1011	Open Office Area	0	1	A	
1012	Vault	0	1	A	
1013	Office	0	1	A	
1014	Office	0	1	A	
1015	Reception	0	1	A	
1016	Stairwell	0	1	A	
1017	Corridor	0	1	A	
2001	Meeting Room	0	2	A	
2002	Office	0	2	A	
2003	Office	0	2	A	
2004	Office	0	2	A	
2005	Office	0	2	A	
2006	Copy Room	0	2	A	
2007	Server Room	0	2	A	NO ACCESS - No Access
2008	Office	0	2	A	
2009	Meeting Room	0	2	A	
2010	Office	0	2	A	
2011	Office	0	2	A	
2012	Staff Room	0	2	A	
2013	Office	0	2	A	
2014	Office	0	2	A	
2015	Office	0	2	A	
2016	Office	0	2	A	
2017	Office	0	2	A	
2018	Stairwell	0	2	A	
2019	Womens Washroom	0	2	A	
2020	Custodian Closet	0	2	A	
2021	First Aid Room	0	2	A	
2022	Storage Closet	0	2	A	
2023	Open Office Area	0	2	A	
2025	Photography Room	0	2	A	
3001	Conference Room	0	3	A	
3002	Office	0	3	A	
3003	Office	0	3	A	

Location No.	Name or Description	Area ft ²	Floor No.	Bldg. Phase	Notes
3004	Chapel	0	3	A	
3005	Reception	0	3	A	
3006	Directors Office	0	3	A	
3007	Meeting Room	0	3	A	
3008	Mens Washroom	0	3	A	
3009	Custodian Room	0	3	A	
3010	Womens Washroom	0	3	A	
3011	Stairwell	0	3	A	
3012	Open Office Area	0	3	A	
3013	Office	0	3	A	
3014	Office	0	3	A	
3015	Office	0	3	A	
3016	File Room	0	3	A	
3017	Office	0	3	A	
3018	Office	0	3	A	
3019	Staff Room	0	3	A	

APPENDIX III

Hazardous Materials Summary / Sample Log Report

Client: Hamilton-Wentworth Catholic District Sch

Site: 90 Mulberry Street, Hamilton, ON

Building Name: Father Kyran Kennedy Catholic Education Centre

Survey Date: 2017-09-08

HAZMAT	Sample No	System/Component/Material/Sample Description	Locations	Bldg. Phase	LF	SF	EA	%	Type	Positive	Friability
Asbestos	S0001 ABC	Wall Plaster	14	A	0	0	0	0	None Detected	No	
Asbestos	S0002 ABCDE	Ceiling Plaster	1,3,4,7,8,9,10,16,17	A	0	0	0	100	None Detected	No	
Asbestos	S0003 ABC	Wall Column Plaster	4,7,9,13	A	0	0	0	100	None Detected	No	
Asbestos	S0004 ABC	Wall Drywall And Joint Compound	4,5,6,7,9,10	A	0	0	0	100	None Detected	No	
Asbestos	S0005 ABCDEFG	Ceiling, Wall, Ceiling, Wall Plaster	14,1003,1004,1005,1006,1007,1008,1009,1010,1011,1012,1013,1014,1015,1016,1017,2001,2002,2003,2004,2005,2006,2008,2009,2010,2011,2012,2013,2014,2015,2016,2017,2018,2019,2020,2021,2022,2023,2025,3001,3002,3003,3004,3005,3006,3007,3008,3009,3010,3011,3012,3013,3014,3015,3016,3017,3018,3019	A	0	0	0	100	None Detected	No	
Asbestos	S0006 ABC	Wall Drywall And Joint Compound	2004,2005,2006,2008,2009,2010,2011,2012,2013,2014,2015,2016,2017,2025	A	0	0	0	0	None Detected	No	
Asbestos	S0007 ABC	Wall Texture Coat	3004	A	0	0	0	100	None Detected	No	
Asbestos	S0008 ABC	Wall Drywall And Joint Compound	3001,3002,3003,3004,3005,3006,3007,3009,3012,3013,3014,3015,3016,3017,3018,3019	A	0	0	0	100	None Detected	No	
Asbestos	S0009 ABC	Piping Parging Cement	1,2025	A	0	0	6	0	Chrysotile	Yes	F
Asbestos	V9000	Ceiling Acoustic Tile Ceiling Tiles (glue-on) 1x1 Fissured (previously Sampled)	1003,3010	A	0	0	0	51	Confirmed Asbestos	Yes	PF
Asbestos	V9000	Ceiling Texture Coat (hwcdsb Sample Parcel 1920269)	1001,1002	A	0	0	0	100	Confirmed Asbestos	Yes	F
Asbestos	V9500	Duct Adhesive/mastic	0	A	0	0	0	100	Presumed Asbestos	Yes	NF
Asbestos	V9500	Floor Adhesive/mastic Vinyl Baseboards	0	A	0	0	0	100	Presumed Asbestos	Yes	NF
Asbestos	V9500	Floor Floor Levelling Compound	0	A	0	0	0	100	Presumed Asbestos	Yes	F
Asbestos	V9500	Floor Mastic	4,1003	A	0	0	0	100	Presumed Asbestos	Yes	NF
Asbestos	V9500	Floor Vinyl Floor Tile And Mastic 9x9 Beige With Brown Streak, 9x9 Beige, Beige Marble, Beige With Light And Dark Streaks, Beige With White And Grey Specks, Brown With Brown And Grey Specks, Brown With Multi-brown Fleck, Cream With Brown And White Speck, Cream With Brown And White Specks, Dark Pink Marble, Grey Marble, Pink Marble, White	1,5,6,7,8,1011,1012,1017,2005,2006,2008,2009,2010,2012,2013,2015,2020,2021,2023,2025,3002,3003,3009,3012,3014,3015,3016,3017,3018,3019	A	0	0	0	100	Presumed Asbestos	Yes	NF

HAZMAT	Sample No	System/Component/Material/Sample Description	Locations	Bldg. Phase	LF	SF	EA	%	Type	Positive	Friability
		With Brown And Black Streaks, White With Grey									
Asbestos	V9500	Mechanical Equipment Switch Gear Cement Product	0	A	0	0	0	100	Presumed Asbestos	Yes	NF
Asbestos	V9500	Mechanical Equipment Gasket Mechanical Packing, Ropes	0	A	0	0	0	100	Presumed Asbestos	Yes	NF
Asbestos	V9500	Other Door, Window Liner Caulking	0	A	0	0	0	100	Presumed Asbestos	Yes	NF
Asbestos	V9500	Other Electrical Wire Fibreglass W/asb. Tex Jacketing	0	A	0	0	0	100	Presumed Asbestos	Yes	NF
Asbestos	V9500	Other Sink Mastic, Gold	1,1003	A	0	0	3	0	Presumed Asbestos	Yes	NF
Asbestos	V9500	Other Paper	0	A	0	0	0	100	Presumed Asbestos	Yes	NF
Asbestos	V9500	Other Heating Ventilating Air Conditioning Unit Textile Elevator And Lift Brakes, Vibration Damper	0	A	0	0	0	100	Presumed Asbestos	Yes	NF
Asbestos	V9500	Other Fire Door Unidentified Material	0	A	0	0	0	100	Presumed Asbestos	Yes	F
Asbestos	V9500	Structure Roof Roofing Material	0	A	0	0	0	100	Presumed Asbestos	Yes	NF
Asbestos	V9500	Wall Vermiculite/concrete Block Walls	0	A	0	0	0	100	Presumed Asbestos	Yes	F
Asbestos	V0000	Ceiling Acoustic Tile Ceiling Tiles (lay-in) 24x48 Pinhole And Fleck (date Stamp 2015)	2025	A	0	0	0	0	Non Asbestos	No	
Asbestos	V0000	Ceiling Acoustic Tile Ceiling Tiles (lay-in) 2x2 Short Fissure And Random Pinhole (date Stamped 05/18/09)	1005,1006,1007,1008,1011,1013,1014,1017,2001 2002,2003,2004,2005,2006,2008,2009,2010,2011 2012,2013,2014,2015,2016,2017,2018,2023,3001 3002,3003,3004,3011,3012,3014,3015,3016,3017 3018,3019	A	0	0	0	83	Non Asbestos	No	
Asbestos	V0000	Ceiling Acoustic Tile Ceiling Tiles (lay-in) 2x2 Short Fissure And Random Pinhole (date Stamped 05/18/19)	3013	A	0	0	0	0	Non Asbestos	No	
Asbestos	V0000	Ceiling Acoustic Tile Ceiling Tiles (lay-in) 2x2 Textured Pattern (previously Sampled)	1015,3005,3006,3007	A	0	0	0	0	Non Asbestos	No	
Asbestos	V0000	Ceiling Acoustic Tile Ceiling Tiles (lay-in) 2x4 Long Fissure And Random Pinhole (date Stamp 2008)	5	A	0	0	0	100	Non Asbestos	No	
Asbestos	V0000	Ceiling Acoustic Tile Ceiling Tiles (lay-in) 2x4 Long Fissure And Random Pinhole (previously Sampled)	6	A	0	0	0	100	Non Asbestos	No	
Asbestos	V0000	Ceiling Acoustic Tile Ceiling Tiles (lay-in) Textured Pattern (previously Sampled)	1016	A	0	0	0	0	Non Asbestos	No	
Asbestos	V0000	Ceiling Plaster Textured, (hwcdsb Sample	11	A	0	0	0	100	Non	No	

HAZMAT	Sample No	System/Component/Material/Sample Description	Locations	Bldg. Phase	LF	SF	EA	%	Type	Positive	Friability
		Parcel 1921079)							Asbestos		
Asbestos	V0000	Wall Drywall And Joint Compound (previously Sampled)	1,8	A	0	0	0	100	Non Asbestos	No	

Legend:

Sample number		Units			
S####	Asbestos sample collected	SF	Square feet	NF	Non Friable material.
L####	Paint sample collected	LF	Linear feet	F	Friable material
P####	PCB sample collected	EA	Each	PF	Potentially Friable material
M####	Mould sample collected	%	Percentage		
V####	Material visually similar to numbered sample collected				
V0000	Known non Hazardous Material				
V9000	Material is visually identified as Hazardous Material				
V9500	Material is presumed to be Hazardous Material				
[Loc. No.]	Abated Material				

APPENDIX IV
All Data Report

ALL DATA REPORT

Client: Hamilton-Wentworth Catholic District Sch **Site:** Admin

Building Name: Father Kyran Kennedy Catholic Education Centre

Location: #0 : Exterior / General

Floor: G

Room #:

Area (sqft): 0

Survey Date: 2017-09-08

Last Re-Assessment: 2022-05-24

ASBESTOS																
System	Component	Material	Item	Covering	A*	V*	AP*	Good	Fair	Poor	Unit	Sample	Asbestos Type	Amount	Hazard	Friable
Duct		Adhesive/mastic			C	N		100			%	V9500	Presumed Asbestos		Presumed Asbestos	NF
Floor		Adhesive/mastic, vinyl baseboards			D	N		100			%	V9500	Presumed Asbestos		Presumed Asbestos	NF
Floor		Floor Levelling Compound			D	N		100			%	V9500	Presumed Asbestos		Presumed Asbestos	F
Mechanical Equipment		Gasket, mechanical packing, ropes			D	N		100			%	V9500	Presumed Asbestos		Presumed Asbestos	NF
Mechanical Equipment	Switch Gear	Cement Product			C	Y		100			%	V9500	Presumed Asbestos		Presumed Asbestos	NF
Other		Paper			D	N		100			%	V9500	Presumed Asbestos		Presumed Asbestos	NF
Other		Textile, elevator and lift brakes			C	N		100			%	V9500	Presumed Asbestos		Presumed Asbestos	NF
Other	Door	Caulking	Perimeter		A	Y		100			%	V9500	Presumed Asbestos		Presumed Asbestos	NF
Other	Electrical Wire	Fibreglass w/Asb. Tex Jacketing	Insulation		C	Y		100			%	V9500	Presumed Asbestos		Presumed Asbestos	NF
Other	Fire Door	Unidentified Material			D	N		100			%	V9500	Presumed Asbestos		Presumed Asbestos	F
Other	Heating Ventilating Air Conditioning Unit	Textile, vibration damper			C	N		100			%	V9500	Presumed Asbestos		Presumed Asbestos	NF
Other	Window Liner	Caulking	Perimeter		A	Y		100			%	V9500	Presumed Asbestos		Presumed Asbestos	NF
Structure	Roof	Roofing material			C	Y		100			%	V9500	Presumed Asbestos		Presumed Asbestos	NF
Wall		Vermiculite/concrete block walls			A	Y		100			%	V9500	Presumed Asbestos		Presumed Asbestos	F
Wall	Exterior	Masonry, Exterior Brick Cladding			A	Y										

ALL DATA REPORT

Client: Hamilton-Wentworth Catholic District Sch **Site:** Admin
Location: #1 : Lunch Room **Floor:** B
Survey Date: 2017-09-08

Building Name: Father Kyran Kennedy Catholic Education Centre
Room #: B001 **Area (sqft):** 0
Last Re-Assessment: 2022-05-24

ASBESTOS																
System	Component	Material	Item	Covering	A*	V*	AP*	Good	Fair	Poor	Unit	Sample	Asbestos Type	Amount	Hazard	Friable
Ceiling		Plaster, Textured			C	Y						S0002ABC	None Detected	N.D.	None	
Floor		Vinyl Floor Tile and Mastic, White with Brown and Black Streaks			A	Y		100			%	V9500	Presumed Asbestos		Presumed Asbestos	NF
Other	Sink	Mastic, Gold			A	N		2			EA	V9500	Presumed Asbestos		Presumed Asbestos	NF
Piping		Fibreglass	Insulation		C	Y										
Piping		Parging Cement	Fitting		C	Y		3			EA	S0009ABC	Chrysotile	50-75%	Confirmed Asbestos	F
Wall		Drywall and joint compound, (previously sampled)	ALL		A	Y		100			%	V0000	Non-Asbestos		None	
Wall		Masonry			A	Y										

Client: Hamilton-Wentworth Catholic District Sch **Site:** Admin
Location: #2 : Washroom **Floor:** B
Survey Date: 2017-09-08

Building Name: Father Kyran Kennedy Catholic Education Centre
Room #: B002 **Area (sqft):** 0
Last Re-Assessment: 2022-05-24

ASBESTOS																
System	Component	Material	Item	Covering	A*	V*	AP*	Good	Fair	Poor	Unit	Sample	Asbestos Type	Amount	Hazard	Friable
Floor		Terrazzo			A	Y										
Structure	Deck	Steel			C	Y										
Wall		Masonry, concrete block			A	Y										

ALL DATA REPORT

Client: Hamilton-Wentworth Catholic District Sch **Site:** Admin
Location: #3 : Storage **Floor:** B
Survey Date: 2017-09-08

Building Name: Father Kyran Kennedy Catholic
Education Centre
Room #: B003 **Area (sqft):** 0
Last Re-Assessment: 2022-05-24

ASBESTOS																
System	Component	Material	Item	Covering	A*	V*	AP*	Good	Fair	Poor	Unit	Sample	Asbestos Type	Amount	Hazard	Friable
Ceiling		Plaster			C	Y		100			%	V0002	None Detected	N.D.	None	
Floor		Concrete (poured)			A	Y										
Wall		Concrete (poured)			A	Y										

Client: Hamilton-Wentworth Catholic District Sch **Site:** Admin
Location: #4 : Storage **Floor:** B
Survey Date: 2017-09-08

Building Name: Father Kyran Kennedy Catholic
Education Centre
Room #: B004 **Area (sqft):** 0
Last Re-Assessment: 2022-05-24

ASBESTOS																
System	Component	Material	Item	Covering	A*	V*	AP*	Good	Fair	Poor	Unit	Sample	Asbestos Type	Amount	Hazard	Friable
Ceiling		Plaster, textured			C	Y		100			%	V0002	None Detected	N.D.	None	
Floor		Concrete (poured)			A	Y										
Floor		Mastic			A	Y		100			%	V9500	Presumed Asbestos		Presumed Asbestos	NF
Wall		Drywall and joint compound			A	Y						S0004C	None Detected		None	
Wall		Masonry			A	Y										
Wall	Column	Plaster, textured			A	Y						S0003C	None Detected	N.D.	None	

ALL DATA REPORT

Client: Hamilton-Wentworth Catholic District Sch **Site:** Admin
Location: #5 : Print Office **Floor:** B
Survey Date: 2017-09-08

Building Name: Father Kyran Kennedy Catholic
Education Centre
Room #: B005 **Area (sqft):** 0
Last Re-Assessment: 2022-05-24

ASBESTOS																
System	Component	Material	Item	Covering	A*	V*	AP*	Good	Fair	Poor	Unit	Sample	Asbestos Type	Amount	Hazard	Friable
Ceiling	Acoustic Tile	Ceiling Tiles (lay-in), 2x4 Long Fissure and Random Pinhole (date stamp 2008)			C	Y		100			%	V0000	Non-Asbestos		None	
Floor		Vinyl Floor Tile and Mastic, Grey Marble			A	Y		100			%	V9500	Presumed Asbestos		Presumed Asbestos	NF
Piping		Fibreglass	Insulation		C	Y										
Wall		Drywall and joint compound			A	Y						V0004	None Detected		None	

Client: Hamilton-Wentworth Catholic District Sch **Site:** Admin
Location: #6 : Print Office **Floor:** B
Survey Date: 2017-09-08

Building Name: Father Kyran Kennedy Catholic
Education Centre
Room #: B006 **Area (sqft):** 0
Last Re-Assessment: 2022-05-24

ASBESTOS																
System	Component	Material	Item	Covering	A*	V*	AP*	Good	Fair	Poor	Unit	Sample	Asbestos Type	Amount	Hazard	Friable
Ceiling	Acoustic Tile	Ceiling Tiles (lay-in), 2x4 Long Fissure and Random Pinhole (previously sampled)			C	Y		100			%	V0000	Non-Asbestos		None	
Floor		Vinyl Floor Tile and Mastic, Grey Marble			A	Y		100			%	V9500	Presumed Asbestos		Presumed Asbestos	NF
Piping		Fibreglass	Insulation		C	Y										
Wall		Drywall and joint compound			A	Y		100			%	V0004	None Detected		None	

ALL DATA REPORT

Client: Hamilton-Wentworth Catholic District Sch **Site:** Admin

Location: #7 : Print Room

Survey Date: 2017-09-08

Floor: B

Building Name: Father Kyran Kennedy Catholic Education Centre

Room #: B007

Last Re-Assessment: 2022-05-24

Area (sqft): 0

ASBESTOS																
System	Component	Material	Item	Covering	A*	V*	AP*	Good	Fair	Poor	Unit	Sample	Asbestos Type	Amount	Hazard	Friable
Ceiling		Plaster, Textured			C	Y						S0002D	None Detected	N.D.	None	
Floor		Vinyl Floor Tile and Mastic, Grey Marble			A	Y		100			%	V9500	Presumed Asbestos		Presumed Asbestos	NF
Floor		Vinyl Floor Tile and Mastic, White with Brown and Black Streaks			A	Y		100			%	V9500	Presumed Asbestos		Presumed Asbestos	NF
Floor		Vinyl Floor Tile and Mastic, White with Grey			A	Y		100			%	V9500	Presumed Asbestos		Presumed Asbestos	NF
Floor		Vinyl Floor Tile and Mastic, Beige Marble			A	Y		100			%	V9500	Presumed Asbestos		Presumed Asbestos	NF
Piping		Fibreglass	Insulation		C	Y										
Wall		Drywall and joint compound			A	Y		100			%	S0004A	None Detected		None	
Wall		Masonry			A	Y										
Wall	Column	Plaster			A	Y		100			%	V0003	None Detected	N.D.	None	

ALL DATA REPORT

Client: Hamilton-Wentworth Catholic District Sch **Site:** Admin
Location: #8 : Corridor **Floor:** B
Survey Date: 2017-09-08

Building Name: Father Kyran Kennedy Catholic
Education Centre
Room #: B008 **Area (sqft):** 0
Last Re-Assessment: 2022-05-24

ASBESTOS																
System	Component	Material	Item	Covering	A*	V*	AP*	Good	Fair	Poor	Unit	Sample	Asbestos Type	Amount	Hazard	Friable
Ceiling		Plaster, textured			C	Y		100			%	V0002	None Detected	N.D.	None	
Floor		Vinyl Floor Tile and Mastic, White with Brown and Black Streaks			A	Y		100			%	V9500	Presumed Asbestos		Presumed Asbestos	NF
Floor		Vinyl Floor Tile and Mastic, White with Grey			A	Y		100			%	V9500	Presumed Asbestos		Presumed Asbestos	NF
Wall		Drywall and joint compound, (previously sampled)			A	Y		100			%	V0000	Non-Asbestos		None	
Wall		Masonry			A	Y										

Client: Hamilton-Wentworth Catholic District Sch **Site:** Admin
Location: #9 : Shipping **Floor:** B
Survey Date: 2017-09-08

Building Name: Father Kyran Kennedy Catholic
Education Centre
Room #: B009 **Area (sqft):** 0
Last Re-Assessment: 2022-05-24

ASBESTOS																
System	Component	Material	Item	Covering	A*	V*	AP*	Good	Fair	Poor	Unit	Sample	Asbestos Type	Amount	Hazard	Friable
Ceiling		Plaster, Textured			C	Y						S0002E	None Detected	N.D.	None	
Floor		Concrete (poured)			A	Y										
Piping		Fibreglass	Insulation		C	Y										
Wall		Drywall and joint compound			A	Y						S0004B	None Detected		None	
Wall		Masonry			A	Y										
Wall	Column	Plaster			A	Y						S0003B	None Detected	N.D.	None	

ALL DATA REPORT

Client: Hamilton-Wentworth Catholic District Sch **Site:** Admin
Location: #10 : Shipping Office **Floor:** B
Survey Date: 2017-09-08

Building Name: Father Kyran Kennedy Catholic Education Centre
Room #: B010 **Area (sqft):** 0
Last Re-Assessment: 2022-05-24

ASBESTOS																
System	Component	Material	Item	Covering	A*	V*	AP*	Good	Fair	Poor	Unit	Sample	Asbestos Type	Amount	Hazard	Friable
Ceiling		Plaster, textured			C	Y						V0002	None Detected	N.D.	None	
Floor		Concrete (poured)			A	Y										
Wall		Drywall and joint compound			A	Y						V0004	None Detected		None	

Client: Hamilton-Wentworth Catholic District Sch **Site:** Admin
Location: #11 : Mechanical **Floor:** B
Survey Date: 2017-09-08

Building Name: Father Kyran Kennedy Catholic Education Centre
Room #: B011 **Area (sqft):** 0
Last Re-Assessment: 2022-05-24

ASBESTOS																
System	Component	Material	Item	Covering	A*	V*	AP*	Good	Fair	Poor	Unit	Sample	Asbestos Type	Amount	Hazard	Friable
Ceiling		Plaster, textured, (HWCDDB sample PARACEL 1921079)			C	Y		100			%	V0000	Non-Asbestos		None	
Floor		Concrete (poured)			A	Y										
Piping		Fibreglass	Insulation		C	Y										
Wall		Masonry			A	Y										

ALL DATA REPORT

Client: Hamilton-Wentworth Catholic District Sch **Site:** Admin
Location: #12 : Electrical **Floor:** B
Survey Date: 2017-09-08

Building Name: Father Kyran Kennedy Catholic Education Centre
Room #: B012 **Area (sqft):** 0
Last Re-Assessment: 2022-05-24

ASBESTOS																
System	Component	Material	Item	Covering	A*	V*	AP*	Good	Fair	Poor	Unit	Sample	Asbestos Type	Amount	Hazard	Friable
Ceiling		Concrete (poured)			C	Y										
Floor		Concrete (poured)			A	Y										
Wall		Masonry			A	Y										

Client: Hamilton-Wentworth Catholic District Sch **Site:** Admin
Location: #13 : Records Storage **Floor:** B
Survey Date: 2017-09-08

Building Name: Father Kyran Kennedy Catholic Education Centre
Room #: B013 **Area (sqft):** 0
Last Re-Assessment: 2022-05-24

ASBESTOS																
System	Component	Material	Item	Covering	A*	V*	AP*	Good	Fair	Poor	Unit	Sample	Asbestos Type	Amount	Hazard	Friable
Ceiling		Concrete (poured)			C	Y										
Floor		Concrete (poured)			A	Y										
Piping		Fibreglass	Insulation		C	Y										
Wall		Masonry			A	Y										
Wall	Column	Plaster			A	Y						S0003A	None Detected	N.D.	None	

ALL DATA REPORT

Client: Hamilton-Wentworth Catholic District Sch **Site:** Admin
Location: #14 : Stairwell **Floor:** B
Survey Date: 2017-09-08

Building Name: Father Kyran Kennedy Catholic
Education Centre
Room #: B014 **Area (sqft):** 0
Last Re-Assessment: 2022-05-24

ASBESTOS																
System	Component	Material	Item	Covering	A*	V*	AP*	Good	Fair	Poor	Unit	Sample	Asbestos Type	Amount	Hazard	Friable
Ceiling		Plaster			C	Y						V0005	None Detected	N.D.	None	
Floor		Terrazzo			A	Y										
Wall		Plaster			A	Y						S0001ABC	None Detected	N.D.	None	

Client: Hamilton-Wentworth Catholic District Sch **Site:** Admin
Location: #15 : Storage **Floor:** b
Survey Date: 2017-09-08

Building Name: Father Kyran Kennedy Catholic
Education Centre
Room #: B015 **Area (sqft):** 0
Last Re-Assessment: 2022-05-24

ASBESTOS																
System	Component	Material	Item	Covering	A*	V*	AP*	Good	Fair	Poor	Unit	Sample	Asbestos Type	Amount	Hazard	Friable
Ceiling		Concrete (poured)			C	Y										
Floor		Concrete (poured)			A	Y										
Wall		Masonry			A	Y										

ALL DATA REPORT

Client: Hamilton-Wentworth Catholic District Sch **Site:** Admin
Location: #16 : Storage **Floor:** B
Survey Date: 2017-09-08

Building Name: Father Kyran Kennedy Catholic
Education Centre
Room #: B016 **Area (sqft):** 0
Last Re-Assessment: 2022-05-24

ASBESTOS																
System	Component	Material	Item	Covering	A*	V*	AP*	Good	Fair	Poor	Unit	Sample	Asbestos Type	Amount	Hazard	Friable
Ceiling		Plaster, textured			C	Y		100			%	V0002	None Detected	N.D.	None	
Floor		Concrete (poured)			A	Y										
Wall		Masonry			A	Y										

Client: Hamilton-Wentworth Catholic District Sch **Site:** Admin
Location: #17 : Storage **Floor:** B
Survey Date: 2017-09-08

Building Name: Father Kyran Kennedy Catholic
Education Centre
Room #: B017 **Area (sqft):** 0
Last Re-Assessment: 2022-05-24

ASBESTOS																
System	Component	Material	Item	Covering	A*	V*	AP*	Good	Fair	Poor	Unit	Sample	Asbestos Type	Amount	Hazard	Friable
Ceiling		Plaster			C	Y		100			%	V0002	None Detected	N.D.	None	
Floor		Concrete (poured)			A	Y										
Wall		Masonry			A	Y										

ALL DATA REPORT

Client: Hamilton-Wentworth Catholic District Sch **Site:** Admin
Location: #1001 : Hearing Room **Floor:** 1
Survey Date: 2017-09-08

Building Name: Father Kyran Kennedy Catholic Education Centre
Room #: **Area (sqft):** 0
Last Re-Assessment: 2022-05-24

ASBESTOS																
System	Component	Material	Item	Covering	A*	V*	AP*	Good	Fair	Poor	Unit	Sample	Asbestos Type	Amount	Hazard	Friable
Ceiling		Texture Coat, (HWCDSD sample PARACEL 1920269)			C	Y		100			%	V9000	Confirmed Asbestos		Confirmed Asbestos	F
Floor		Carpet			A	Y										
Structure	Beam	Wood			C	Y										
Wall		Wood, Wood Paneling			A	Y										

Client: Hamilton-Wentworth Catholic District Sch **Site:** Admin
Location: #1002 : Board Room **Floor:** 1
Survey Date: 2017-09-08

Building Name: Father Kyran Kennedy Catholic Education Centre
Room #: **Area (sqft):** 0
Last Re-Assessment: 2022-05-24

ASBESTOS																
System	Component	Material	Item	Covering	A*	V*	AP*	Good	Fair	Poor	Unit	Sample	Asbestos Type	Amount	Hazard	Friable
Ceiling		Texture Coat, (HWCDSD sample PARACEL 1920269)			C	Y		100			%	V9000	Confirmed Asbestos		Confirmed Asbestos	F
Floor		Carpet			A	Y										
Wall		Wood, Wood Paneling			A	Y										

Client: Hamilton-Wentworth Catholic District Sch **Site:** Admin
Location: #1003 : Kitchenette **Floor:** 1
Survey Date: 2017-09-08

Building Name: Father Kyran Kennedy Catholic Education Centre
Room #: **Area (sqft):** 0
Last Re-Assessment: 2022-05-24

ASBESTOS																
System	Component	Material	Item	Covering	A*	V*	AP*	Good	Fair	Poor	Unit	Sample	Asbestos Type	Amount	Hazard	Friable
Ceiling	Acoustic Tile	Ceiling tiles (glue-on), 1x1 Fissured (previously sampled)			C	Y		1			%	V9000	Confirmed Asbestos		Confirmed Asbestos	PF
Floor		Laminate			A	Y										
Floor		Mastic			D	N		100			%	V9500	Presumed Asbestos		Presumed Asbestos	NF
Other	Sink	Mastic, Gold			A	N		1			EA	V9500	Presumed Asbestos		Presumed Asbestos	NF
Wall		Plaster			A	Y		100			%	S0005A	None Detected	N.D.	None	

Client: Hamilton-Wentworth Catholic District Sch **Site:** Admin
Location: #1004 : Washroom **Floor:** 1
Survey Date: 2017-09-08

Building Name: Father Kyran Kennedy Catholic Education Centre
Room #: **Area (sqft):** 0
Last Re-Assessment: 2022-05-24

ASBESTOS																
System	Component	Material	Item	Covering	A*	V*	AP*	Good	Fair	Poor	Unit	Sample	Asbestos Type	Amount	Hazard	Friable
Ceiling		Plaster			C	Y		100			%	V0005	None Detected	N.D.	None	
Floor		Terrazzo			A	Y										
Wall		Plaster			A	Y		100			%	V0005	None Detected	N.D.	None	

ALL DATA REPORT

Client: Hamilton-Wentworth Catholic District Sch **Site:** Admin
Location: #1005 : Office **Floor:** 1
Survey Date: 2017-09-08

Building Name: Father Kyran Kennedy Catholic Education Centre
Room #: **Area (sqft):** 0
Last Re-Assessment: 2022-05-24

ASBESTOS																
System	Component	Material	Item	Covering	A*	V*	AP*	Good	Fair	Poor	Unit	Sample	Asbestos Type	Amount	Hazard	Friable
Ceiling	Acoustic Tile	Ceiling Tiles (lay-in), 2x2 Short Fissure and Random Pinhole (date stamped 05/18/09)			C	Y		100			%	V0000	Non-Asbestos		None	
Floor		Carpet			A	Y										
Piping		Fibreglass	Insulation		C	Y										
Wall		Plaster			A	Y		100			%	V0005	None Detected	N.D.	None	

Client: Hamilton-Wentworth Catholic District Sch **Site:** Admin
Location: #1006 : Office **Floor:** 1
Survey Date: 2017-09-08

Building Name: Father Kyran Kennedy Catholic Education Centre
Room #: **Area (sqft):** 0
Last Re-Assessment: 2022-05-24

ASBESTOS																
System	Component	Material	Item	Covering	A*	V*	AP*	Good	Fair	Poor	Unit	Sample	Asbestos Type	Amount	Hazard	Friable
Ceiling	Acoustic Tile	Ceiling Tiles (lay-in), 2x2 Short Fissure and Random Pinhole (date stamped 05/18/09)			C	Y		100			%	V0000	Non-Asbestos		None	
Floor		Carpet			A	Y										
Piping		Fibreglass			C	Y										
Wall		Plaster			A	Y		100			%	V0005	None Detected	N.D.	None	

ALL DATA REPORT

Client: Hamilton-Wentworth Catholic District Sch **Site:** Admin
Location: #1007 : Office **Floor:** 1
Survey Date: 2017-09-08

Building Name: Father Kyran Kennedy Catholic Education Centre
Room #: **Area (sqft):** 0
Last Re-Assessment: 2022-05-24

ASBESTOS																
System	Component	Material	Item	Covering	A*	V*	AP*	Good	Fair	Poor	Unit	Sample	Asbestos Type	Amount	Hazard	Friable
Ceiling	Acoustic Tile	Ceiling Tiles (lay-in), 2x2 Short Fissure and Random Pinhole (date stamped 05/18/09)			C	Y		100			%	V0000	Non-Asbestos		None	
Floor		Carpet			A	Y										
Piping		Fibreglass	Insulation		C	Y										
Wall		Plaster			A	Y		100			%	V0005	None Detected	N.D.	None	

Client: Hamilton-Wentworth Catholic District Sch **Site:** Admin
Location: #1008 : Office **Floor:** 1
Survey Date: 2017-09-08

Building Name: Father Kyran Kennedy Catholic Education Centre
Room #: **Area (sqft):** 0
Last Re-Assessment: 2022-05-24

ASBESTOS																
System	Component	Material	Item	Covering	A*	V*	AP*	Good	Fair	Poor	Unit	Sample	Asbestos Type	Amount	Hazard	Friable
Ceiling	Acoustic Tile	Ceiling Tiles (lay-in), 2x2 Short Fissure and Random Pinhole (date stamped 05/18/09)			C	Y		100			%	V0000	Non-Asbestos		None	
Floor		Carpet			A	Y										
Piping		Fibreglass	Insulation		C	Y										
Wall		Plaster			A	Y		100			%	V0005	None Detected	N.D.	None	

ALL DATA REPORT

Client: Hamilton-Wentworth Catholic District Sch **Site:** Admin
Location: #1009 : Womens Washroom **Floor:** 1
Survey Date: 2017-09-08

Building Name: Father Kyran Kennedy Catholic Education Centre
Room #: **Area (sqft):** 0
Last Re-Assessment: 2022-05-24

ASBESTOS																
System	Component	Material	Item	Covering	A*	V*	AP*	Good	Fair	Poor	Unit	Sample	Asbestos Type	Amount	Hazard	Friable
Ceiling		Plaster			C	Y		100			%	V0005	None Detected	N.D.	None	
Floor		Terrazzo			A	Y										
Wall		Plaster			A	Y		100			%	S0005B	None Detected	N.D.	None	

Client: Hamilton-Wentworth Catholic District Sch **Site:** Admin
Location: #1010 : Mens Washroom **Floor:** 1
Survey Date: 2017-09-08

Building Name: Father Kyran Kennedy Catholic Education Centre
Room #: **Area (sqft):** 0
Last Re-Assessment: 2022-05-24

ASBESTOS																
System	Component	Material	Item	Covering	A*	V*	AP*	Good	Fair	Poor	Unit	Sample	Asbestos Type	Amount	Hazard	Friable
Ceiling		Plaster			C	Y		100			%	V0005	None Detected	N.D.	None	
Floor		Terrazzo			A	Y										
Wall		Plaster			A	Y		100			%	V0005	None Detected	N.D.	None	

ALL DATA REPORT

Client: Hamilton-Wentworth Catholic District Sch **Site:** Admin
Location: #1011 : Open Office Area **Floor:** 1
Survey Date: 2017-09-08

Building Name: Father Kyran Kennedy Catholic Education Centre
Room #: **Area (sqft):** 0
Last Re-Assessment: 2022-05-24

ASBESTOS																
System	Component	Material	Item	Covering	A*	V*	AP*	Good	Fair	Poor	Unit	Sample	Asbestos Type	Amount	Hazard	Friable
Ceiling	Acoustic Tile	Ceiling Tiles (lay-in), 2x2 Short Fissure and Random Pinhole (date stamped 05/18/09)			C	Y		100			%	V0000	Non-Asbestos		None	
Floor		Vinyl Floor Tile and Mastic, Beige with Light and Dark Streaks			A	Y		100			%	V9500	Presumed Asbestos		Presumed Asbestos	NF
Piping		Fibreglass	Insulation		C	Y										
Wall		Wood, Wood Paneling			A	Y										
Wall		Plaster			A	Y		100			%	V0005	None Detected	N.D.	None	
Wall		Masonry			A	Y										

Client: Hamilton-Wentworth Catholic District Sch **Site:** Admin
Location: #1012 : Vault **Floor:** 1
Survey Date: 2017-09-08

Building Name: Father Kyran Kennedy Catholic Education Centre
Room #: **Area (sqft):** 0
Last Re-Assessment: 2022-05-24

ASBESTOS																
System	Component	Material	Item	Covering	A*	V*	AP*	Good	Fair	Poor	Unit	Sample	Asbestos Type	Amount	Hazard	Friable
Ceiling		Plaster			C	Y		100			%	V0005	None Detected	N.D.	None	
Floor		Vinyl Floor Tile and Mastic, 9x9 Beige with Brown Streak			A	Y		100			%	V9500	Presumed Asbestos		Presumed Asbestos	NF
Wall		Plaster			A	Y		100			%	V0005	None Detected	N.D.	None	

ALL DATA REPORT

Client: Hamilton-Wentworth Catholic District Sch **Site:** Admin
Location: #1013 : Office **Floor:** 1
Survey Date: 2017-09-08

Building Name: Father Kyran Kennedy Catholic Education Centre
Room #: **Area (sqft):** 0
Last Re-Assessment: 2022-05-24

ASBESTOS																
System	Component	Material	Item	Covering	A*	V*	AP*	Good	Fair	Poor	Unit	Sample	Asbestos Type	Amount	Hazard	Friable
Ceiling	Acoustic Tile	Ceiling Tiles (lay-in), 2x2 Short Fissure and Random Pinhole (date stamped 05/18/09)			C	Y		100			%	V0000	Non-Asbestos		None	
Floor		Carpet			A	Y										
Piping		Fibreglass	Insulation		C	Y										
Wall		Plaster			A	Y		100			%	V0005	None Detected	N.D.	None	

Client: Hamilton-Wentworth Catholic District Sch **Site:** Admin
Location: #1014 : Office **Floor:** 1
Survey Date: 2017-09-08

Building Name: Father Kyran Kennedy Catholic Education Centre
Room #: **Area (sqft):** 0
Last Re-Assessment: 2022-05-24

ASBESTOS																
System	Component	Material	Item	Covering	A*	V*	AP*	Good	Fair	Poor	Unit	Sample	Asbestos Type	Amount	Hazard	Friable
Ceiling	Acoustic Tile	Ceiling Tiles (lay-in), 2x2 Short Fissure and Random Pinhole (date stamped 05/18/09)			C	Y		100			%	V0000	Non-Asbestos		None	
Floor		Carpet			A	Y										
Piping		Fibreglass			C	Y										
Wall		Plaster			A	Y		100			%	V0005	None Detected	N.D.	None	

ALL DATA REPORT

Client: Hamilton-Wentworth Catholic District Sch **Site:** Admin
Location: #1015 : Reception **Floor:** 1
Survey Date: 2017-09-08

Building Name: Father Kyran Kennedy Catholic Education Centre
Room #: **Area (sqft):** 0
Last Re-Assessment: 2022-05-24

ASBESTOS																
System	Component	Material	Item	Covering	A*	V*	AP*	Good	Fair	Poor	Unit	Sample	Asbestos Type	Amount	Hazard	Friable
Ceiling	Acoustic Tile	Ceiling Tiles (lay-in), 2x2 Textured Pattern (previously sampled)			C	Y						V0000	Non-Asbestos		None	
Floor		Marble			A	Y										
Wall		Concrete (poured), Decorative Pebbled			A	Y										
Wall		Plaster			A	Y		100			%	V0005	None Detected	N.D.	None	

Client: Hamilton-Wentworth Catholic District Sch **Site:** Admin
Location: #1016 : Stairwell **Floor:** 1
Survey Date: 2017-09-08

Building Name: Father Kyran Kennedy Catholic Education Centre
Room #: **Area (sqft):** 0
Last Re-Assessment: 2022-05-24

ASBESTOS																
System	Component	Material	Item	Covering	A*	V*	AP*	Good	Fair	Poor	Unit	Sample	Asbestos Type	Amount	Hazard	Friable
Ceiling	Acoustic Tile	Ceiling Tiles (lay-in), Textured Pattern (previously sampled)			C	Y						V0000	Non-Asbestos		None	
Floor		Marble			A	Y										
Wall		Plaster			A	Y		100			%	V0005	None Detected	N.D.	None	

ALL DATA REPORT

Client: Hamilton-Wentworth Catholic District Sch **Site:** Admin

Location: #1017 : Corridor

Survey Date: 2017-09-08

Floor: 1

Building Name: Father Kyran Kennedy Catholic Education Centre

Room #:

Last Re-Assessment: 2022-05-24

Area (sqft): 0

ASBESTOS																
System	Component	Material	Item	Covering	A*	V*	AP*	Good	Fair	Poor	Unit	Sample	Asbestos Type	Amount	Hazard	Friable
Ceiling	Acoustic Tile	Ceiling Tiles (lay-in), 2x2 Short Fissure and Random Pinhole (date stamped 05/18/09)			C	Y		100			%	V0000	Non-Asbestos		None	
Floor		Vinyl Floor Tile and Mastic, Beige with White and Grey Specks			A	Y		100			%	V9500	Presumed Asbestos		Presumed Asbestos	NF
Floor		Vinyl Floor Tile and Mastic, Brown with Brown and Grey Specks			A	Y		100			%	V9500	Presumed Asbestos		Presumed Asbestos	NF
Piping		Fibreglass	Insulation		C	Y										
Wall		Plaster			A	Y		100			%	V0005	None Detected	N.D.	None	

Client: Hamilton-Wentworth Catholic District Sch **Site:** Admin

Location: #2001 : Meeting Room

Survey Date: 2017-09-08

Floor: 2

Building Name: Father Kyran Kennedy Catholic Education Centre

Room #:

Last Re-Assessment: 2022-05-24

Area (sqft): 0

ASBESTOS																
System	Component	Material	Item	Covering	A*	V*	AP*	Good	Fair	Poor	Unit	Sample	Asbestos Type	Amount	Hazard	Friable
Ceiling	Acoustic Tile	Ceiling Tiles (lay-in), 2x2 Short Fissure and Random Pinhole (date stamped 05/18/09)			C	Y						V0000	Non-Asbestos		None	
Floor		Carpet			A	Y										
Piping		Fibreglass	Insulation		C	Y										
Wall		Plaster			A	Y		100			%	V0005	None Detected	N.D.	None	

ALL DATA REPORT

Client: Hamilton-Wentworth Catholic District Sch **Site:** Admin
Location: #2002 : Office **Floor:** 2
Survey Date: 2017-09-08

Building Name: Father Kyran Kennedy Catholic Education Centre
Room #: **Area (sqft):** 0
Last Re-Assessment: 2022-05-24

ASBESTOS																
System	Component	Material	Item	Covering	A*	V*	AP*	Good	Fair	Poor	Unit	Sample	Asbestos Type	Amount	Hazard	Friable
Ceiling	Acoustic Tile	Ceiling Tiles (lay-in), 2x2 Short Fissure and Random Pinhole (date stamped 05/18/09)			C	Y						V0000	Non-Asbestos		None	
Floor		Carpet			A	Y										
Piping		Fibreglass			C	Y										
Wall		Plaster			A	Y		100			%	V0005	None Detected	N.D.	None	

Client: Hamilton-Wentworth Catholic District Sch **Site:** Admin
Location: #2003 : Office **Floor:** 2
Survey Date: 2017-09-08

Building Name: Father Kyran Kennedy Catholic Education Centre
Room #: **Area (sqft):** 0
Last Re-Assessment: 2022-05-24

ASBESTOS																
System	Component	Material	Item	Covering	A*	V*	AP*	Good	Fair	Poor	Unit	Sample	Asbestos Type	Amount	Hazard	Friable
Ceiling	Acoustic Tile	Ceiling Tiles (lay-in), 2x2 Short Fissure and Random Pinhole (date stamped 05/18/09)			C	Y					%	V0000	Non-Asbestos		None	
Floor		Carpet			A	Y										
Piping		Fibreglass	Insulation		C	Y										
Wall		Plaster			A	Y		100			%	V0005	None Detected	N.D.	None	

ALL DATA REPORT

Client: Hamilton-Wentworth Catholic District Sch **Site:** Admin
Location: #2004 : Office **Floor:** 2
Survey Date: 2017-09-08

Building Name: Father Kyran Kennedy Catholic Education Centre
Room #: **Area (sqft):** 0
Last Re-Assessment: 2022-05-24

ASBESTOS																
System	Component	Material	Item	Covering	A*	V*	AP*	Good	Fair	Poor	Unit	Sample	Asbestos Type	Amount	Hazard	Friable
Ceiling	Acoustic Tile	Ceiling Tiles (lay-in), 2x2 Short Fissure and Random Pinhole (date stamped 05/18/09)			C	Y						V0000	Non-Asbestos		None	
Floor		Carpet			A	Y										
Piping		Fibreglass	Insulation		C	Y										
Wall		Drywall and joint compound			A	Y						V0006	None Detected	N.D.	None	
Wall		Plaster			A	Y		100			%	V0005	None Detected	N.D.	None	

Client: Hamilton-Wentworth Catholic District Sch **Site:** Admin
Location: #2005 : Office **Floor:** 2
Survey Date: 2017-09-08

Building Name: Father Kyran Kennedy Catholic Education Centre
Room #: **Area (sqft):** 0
Last Re-Assessment: 2022-05-24

ASBESTOS																
System	Component	Material	Item	Covering	A*	V*	AP*	Good	Fair	Poor	Unit	Sample	Asbestos Type	Amount	Hazard	Friable
Ceiling	Acoustic Tile	Ceiling Tiles (lay-in), 2x2 Short Fissure and Random Pinhole (date stamped 05/18/09)			C	Y						V0000	Non-Asbestos		None	
Floor		Vinyl Floor Tile and Mastic, Pink Marble			A	Y		100			%	V9500	Presumed Asbestos		Presumed Asbestos	NF
Piping		Fibreglass	Insulation		C	Y										
Wall		Drywall and joint compound			A	Y						V0006	None Detected	N.D.	None	
Wall		Plaster			A	Y		100			%	V0005	None Detected	N.D.	None	

ALL DATA REPORT

Client: Hamilton-Wentworth Catholic District Sch **Site:** Admin
Location: #2006 : Copy Room **Floor:** 2
Survey Date: 2017-09-08

Building Name: Father Kyran Kennedy Catholic Education Centre
Room #: **Area (sqft):** 0
Last Re-Assessment: 2022-05-24

ASBESTOS																
System	Component	Material	Item	Covering	A*	V*	AP*	Good	Fair	Poor	Unit	Sample	Asbestos Type	Amount	Hazard	Friable
Ceiling	Acoustic Tile	Ceiling Tiles (lay-in), 2x2 Short Fissure and Random Pinhole (date stamped 05/18/09)			C	Y						V0000	Non-Asbestos		None	
Floor		Vinyl Floor Tile and Mastic, Pink Marble			A	Y		100			%	V9500	Presumed Asbestos		Presumed Asbestos	NF
Piping		Fibreglass	Insulation		C	Y										
Wall		Drywall and joint compound			A	Y						V0006	None Detected	N.D.	None	
Wall		Plaster			A	Y		100			%	V0005	None Detected	N.D.	None	

Client: Hamilton-Wentworth Catholic District Sch **Site:** Admin
Location: #2007 : Server Room **Floor:** 2
Survey Date: 2017-09-08

Building Name: Father Kyran Kennedy Catholic Education Centre
Room #: **Area (sqft):** 0
Last Re-Assessment: 2022-05-24

ASBESTOS - NO ACCESS																
System	Component	Material	Item	Covering	A*	V*	AP*	Good	Fair	Poor	Unit	Sample	Asbestos Type	Amount	Hazard	Friable

No Access

ALL DATA REPORT

Client: Hamilton-Wentworth Catholic District Sch **Site:** Admin
Location: #2008 : Office **Floor:** 2
Survey Date: 2017-09-08

Building Name: Father Kyran Kennedy Catholic Education Centre
Room #: **Area (sqft):** 0
Last Re-Assessment: 2022-05-24

ASBESTOS																
System	Component	Material	Item	Covering	A*	V*	AP*	Good	Fair	Poor	Unit	Sample	Asbestos Type	Amount	Hazard	Friable
Ceiling	Acoustic Tile	Ceiling Tiles (lay-in), 2x2 Short Fissure and Random Pinhole (date stamped 05/18/09)			C	Y						V0000	Non-Asbestos		None	
Floor		Vinyl Floor Tile and Mastic, Pink Marble			A	Y		100			%	V9500	Presumed Asbestos		Presumed Asbestos	NF
Piping		Fibreglass	Insulation		C	Y										
Wall		Drywall and joint compound			A	Y						V0006	None Detected	N.D.	None	
Wall		Plaster			A	Y		100			%	V0005	None Detected	N.D.	None	

Client: Hamilton-Wentworth Catholic District Sch **Site:** Admin
Location: #2009 : Meeting Room **Floor:** 2
Survey Date: 2017-09-08

Building Name: Father Kyran Kennedy Catholic Education Centre
Room #: **Area (sqft):** 0
Last Re-Assessment: 2022-05-24

ASBESTOS																
System	Component	Material	Item	Covering	A*	V*	AP*	Good	Fair	Poor	Unit	Sample	Asbestos Type	Amount	Hazard	Friable
Ceiling	Acoustic Tile	Ceiling Tiles (lay-in), 2x2 Short Fissure and Random Pinhole (date stamped 05/18/09)			C	Y						V0000	Non-Asbestos		None	
Floor		Vinyl Floor Tile and Mastic, Pink Marble			A	Y		100			%	V9500	Presumed Asbestos		Presumed Asbestos	NF
Piping		Fibreglass	Insulation		C	Y										
Wall		Drywall and joint compound			A	Y						V0006	None Detected	N.D.	None	
Wall		Plaster			A	Y		100			%	V0005	None Detected	N.D.	None	

ALL DATA REPORT

Client: Hamilton-Wentworth Catholic District Sch **Site:** Admin

Location: #2010 : Office

Survey Date: 2017-09-08

Floor: 2

Building Name: Father Kyran Kennedy Catholic

Education Centre

Room #:

Last Re-Assessment: 2022-05-24

Area (sqft): 0

ASBESTOS																
System	Component	Material	Item	Covering	A*	V*	AP*	Good	Fair	Poor	Unit	Sample	Asbestos Type	Amount	Hazard	Friable
Ceiling	Acoustic Tile	Ceiling Tiles (lay-in), 2x2 Short Fissure and Random Pinhole (date stamped 05/18/09)			C	Y						V0000	Non-Asbestos		None	
Floor		Vinyl Floor Tile and Mastic, Pink Marble			A	Y		100			%	V9500	Presumed Asbestos		Presumed Asbestos	NF
Piping		Fibreglass	Insulation		C	Y										
Wall		Drywall and joint compound			A	Y						V0006	None Detected	N.D.	None	
Wall		Plaster			A	Y		100			%	V0005	None Detected	N.D.	None	

Client: Hamilton-Wentworth Catholic District Sch **Site:** Admin

Location: #2011 : Office

Survey Date: 2017-09-08

Floor: 2

Building Name: Father Kyran Kennedy Catholic

Education Centre

Room #:

Last Re-Assessment: 2022-05-24

Area (sqft): 0

ASBESTOS																
System	Component	Material	Item	Covering	A*	V*	AP*	Good	Fair	Poor	Unit	Sample	Asbestos Type	Amount	Hazard	Friable
Ceiling	Acoustic Tile	Ceiling Tiles (lay-in), 2x2 Short Fissure and Random Pinhole (date stamped 05/18/09)			C	Y						V0000	Non-Asbestos		None	
Floor		Carpet			A	Y										
Piping		Fibreglass	Insulation		C	Y										
Wall		Drywall and joint compound			A	Y						V0006	None Detected	N.D.	None	
Wall		Plaster			A	Y		100			%	V0005	None Detected	N.D.	None	

ALL DATA REPORT

Client: Hamilton-Wentworth Catholic District Sch **Site:** Admin
Location: #2012 : Staff Room **Floor:** 2
Survey Date: 2017-09-08

Building Name: Father Kyran Kennedy Catholic Education Centre
Room #: **Area (sqft):** 0
Last Re-Assessment: 2022-05-24

ASBESTOS																
System	Component	Material	Item	Covering	A*	V*	AP*	Good	Fair	Poor	Unit	Sample	Asbestos Type	Amount	Hazard	Friable
Ceiling	Acoustic Tile	Ceiling Tiles (lay-in), 2x2 Short Fissure and Random Pinhole (date stamped 05/18/09)			C	Y						V0000	Non-Asbestos		None	
Floor		Vinyl Floor Tile and Mastic, Pink Marble			A	Y		100			%	V9500	Presumed Asbestos		Presumed Asbestos	NF
Piping		Fibreglass	Insulation		C	Y										
Wall		Drywall and joint compound			A	Y						S0006C	None Detected	N.D.	None	
Wall		Plaster			A	Y		100			%	V0005	None Detected	N.D.	None	

Client: Hamilton-Wentworth Catholic District Sch **Site:** Admin
Location: #2013 : Office **Floor:** 2
Survey Date: 2017-09-08

Building Name: Father Kyran Kennedy Catholic Education Centre
Room #: **Area (sqft):** 0
Last Re-Assessment: 2022-05-24

ASBESTOS																
System	Component	Material	Item	Covering	A*	V*	AP*	Good	Fair	Poor	Unit	Sample	Asbestos Type	Amount	Hazard	Friable
Ceiling	Acoustic Tile	Ceiling Tiles (lay-in), 2x2 Short Fissure and Random Pinhole (date stamped 05/18/09)			C	Y						V0000	Non-Asbestos		None	
Floor		Vinyl Floor Tile and Mastic, Pink Marble			A	Y		100			%	V9500	Presumed Asbestos		Presumed Asbestos	NF
Piping		Fibreglass	Insulation		C	Y										
Wall		Drywall and joint compound			A	Y						V0006	None Detected	N.D.	None	
Wall		Plaster			A	Y		100			%	V0005	None Detected	N.D.	None	

ALL DATA REPORT

Client: Hamilton-Wentworth Catholic District Sch **Site:** Admin
Location: #2014 : Office **Floor:** 2
Survey Date: 2017-09-08

Building Name: Father Kyran Kennedy Catholic Education Centre
Room #: **Area (sqft):** 0
Last Re-Assessment: 2022-05-24

ASBESTOS																
System	Component	Material	Item	Covering	A*	V*	AP*	Good	Fair	Poor	Unit	Sample	Asbestos Type	Amount	Hazard	Friable
Ceiling	Acoustic Tile	Ceiling Tiles (lay-in), 2x2 Short Fissure and Random Pinhole (date stamped 05/18/09)			C	Y						V0000	Non-Asbestos		None	
Floor		Carpet			A	Y										
Piping		Fibreglass	Insulation		C	Y										
Wall		Drywall and joint compound			A	Y						V0006	None Detected	N.D.	None	
Wall		Plaster			A	Y		100			%	V0005	None Detected	N.D.	None	

Client: Hamilton-Wentworth Catholic District Sch **Site:** Admin
Location: #2015 : Office **Floor:** 2
Survey Date: 2017-09-08

Building Name: Father Kyran Kennedy Catholic Education Centre
Room #: **Area (sqft):** 0
Last Re-Assessment: 2022-05-24

ASBESTOS																
System	Component	Material	Item	Covering	A*	V*	AP*	Good	Fair	Poor	Unit	Sample	Asbestos Type	Amount	Hazard	Friable
Ceiling	Acoustic Tile	Ceiling Tiles (lay-in), 2x2 Short Fissure and Random Pinhole (date stamped 05/18/09)			C	Y						V0000	Non-Asbestos		None	
Floor		Vinyl Floor Tile and Mastic, Pink Marble			A	Y		100			%	V9500	Presumed Asbestos		Presumed Asbestos	NF
Piping		Fibreglass	Insulation		C	Y										
Wall		Drywall and joint compound			A	Y						V0006	None Detected	N.D.	None	
Wall		Plaster			A	Y		100			%	V0005	None Detected	N.D.	None	

ALL DATA REPORT

Client: Hamilton-Wentworth Catholic District Sch **Site:** Admin
Location: #2016 : Office **Floor:** 2
Survey Date: 2017-09-08

Building Name: Father Kyran Kennedy Catholic Education Centre
Room #: **Area (sqft):** 0
Last Re-Assessment: 2022-05-24

ASBESTOS																
System	Component	Material	Item	Covering	A*	V*	AP*	Good	Fair	Poor	Unit	Sample	Asbestos Type	Amount	Hazard	Friable
Ceiling	Acoustic Tile	Ceiling Tiles (lay-in), 2x2 Short Fissure and Random Pinhole (date stamped 05/18/09)			C	Y						V0000	Non-Asbestos		None	
Floor		Carpet			A	Y										
Piping		Fibreglass	Insulation		C	Y										
Wall		Drywall and joint compound			A	Y						S0006B	None Detected	N.D.	None	
Wall		Plaster			A	Y		100			%	V0005	None Detected	N.D.	None	

Client: Hamilton-Wentworth Catholic District Sch **Site:** Admin
Location: #2017 : Office **Floor:** 2
Survey Date: 2017-09-08

Building Name: Father Kyran Kennedy Catholic Education Centre
Room #: **Area (sqft):** 0
Last Re-Assessment: 2022-05-24

ASBESTOS																
System	Component	Material	Item	Covering	A*	V*	AP*	Good	Fair	Poor	Unit	Sample	Asbestos Type	Amount	Hazard	Friable
Ceiling	Acoustic Tile	Ceiling Tiles (lay-in), 2x2 Short Fissure and Random Pinhole (date stamped 05/18/09)			C	Y						V0000	Non-Asbestos		None	
Floor		Carpet			A	Y										
Piping		Fibreglass	Insulation		C	Y										
Wall		Drywall and joint compound			A	Y						V0006	None Detected	N.D.	None	
Wall		Plaster			A	Y		100			%	V0005	None Detected	N.D.	None	

ALL DATA REPORT

Client: Hamilton-Wentworth Catholic District Sch **Site:** Admin
Location: #2018 : Stairwell **Floor:** 2
Survey Date: 2017-09-08

Building Name: Father Kyran Kennedy Catholic Education Centre
Room #: **Area (sqft):** 0
Last Re-Assessment: 2022-05-24

ASBESTOS																
System	Component	Material	Item	Covering	A*	V*	AP*	Good	Fair	Poor	Unit	Sample	Asbestos Type	Amount	Hazard	Friable
Ceiling	Acoustic Tile	Ceiling Tiles (lay-in), 2x2 Short Fissure and Random Pinhole (date stamped 05/18/09)			C	Y						V0000	Non-Asbestos		None	
Floor		Terrazzo			A	Y										
Wall		Plaster			A	Y		100			%	V0005	None Detected	N.D.	None	

Client: Hamilton-Wentworth Catholic District Sch **Site:** Admin
Location: #2019 : Womens Washroom **Floor:** 2
Survey Date: 2017-09-08

Building Name: Father Kyran Kennedy Catholic Education Centre
Room #: **Area (sqft):** 0
Last Re-Assessment: 2022-05-24

ASBESTOS																
System	Component	Material	Item	Covering	A*	V*	AP*	Good	Fair	Poor	Unit	Sample	Asbestos Type	Amount	Hazard	Friable
Ceiling		Plaster			C	Y		100			%	S0005D	None Detected	N.D.	None	
Floor		Terrazzo			A	Y										
Wall		Plaster			A	Y		100			%	V0005	None Detected	N.D.	None	

ALL DATA REPORT

Client: Hamilton-Wentworth Catholic District Sch **Site:** Admin

Location: #2020 : Custodian Closet

Survey Date: 2017-09-08

Floor: 2

Building Name: Father Kyran Kennedy Catholic Education Centre

Room #:

Last Re-Assessment: 2022-05-24

Area (sqft): 0

ASBESTOS																
System	Component	Material	Item	Covering	A*	V*	AP*	Good	Fair	Poor	Unit	Sample	Asbestos Type	Amount	Hazard	Friable
Ceiling		Plaster			C	Y		100			%	V0005	None Detected	N.D.	None	
Floor		Vinyl Floor Tile and Mastic, Pink Marble			A	Y		100			%	V9500	Presumed Asbestos		Presumed Asbestos	NF
Wall		Plaster			A	Y		100			%	V0005	None Detected	N.D.	None	

Client: Hamilton-Wentworth Catholic District Sch **Site:** Admin

Location: #2021 : First Aid Room

Survey Date: 2017-09-08

Floor: 2

Building Name: Father Kyran Kennedy Catholic Education Centre

Room #:

Last Re-Assessment: 2022-05-24

Area (sqft): 0

ASBESTOS																
System	Component	Material	Item	Covering	A*	V*	AP*	Good	Fair	Poor	Unit	Sample	Asbestos Type	Amount	Hazard	Friable
Ceiling		Plaster			C	Y		100			%	V0005	None Detected	N.D.	None	
Floor		Vinyl Floor Tile and Mastic, Pink Marble			A	Y		100			%	V9500	Presumed Asbestos		Presumed Asbestos	NF
Wall		Plaster			A	Y		100			%	V0005	None Detected	N.D.	None	

ALL DATA REPORT

Client: Hamilton-Wentworth Catholic District Sch **Site:** Admin

Location: #2022 : Storage Closet

Survey Date: 2017-09-08

Floor: 2

Building Name: Father Kyran Kennedy Catholic Education Centre

Room #:

Last Re-Assessment: 2022-05-24

Area (sqft): 0

ASBESTOS																
System	Component	Material	Item	Covering	A*	V*	AP*	Good	Fair	Poor	Unit	Sample	Asbestos Type	Amount	Hazard	Friable
Ceiling		Plaster			C	Y		100			%	V0005	None Detected	N.D.	None	
Floor		Terrazzo			A	Y										
Wall		Plaster			A	Y		100			%	V0005	None Detected	N.D.	None	

Client: Hamilton-Wentworth Catholic District Sch **Site:** Admin

Location: #2023 : Open Office Area

Survey Date: 2017-09-08

Floor: 2

Building Name: Father Kyran Kennedy Catholic Education Centre

Room #:

Last Re-Assessment: 2022-05-24

Area (sqft): 0

ASBESTOS																
System	Component	Material	Item	Covering	A*	V*	AP*	Good	Fair	Poor	Unit	Sample	Asbestos Type	Amount	Hazard	Friable
Ceiling	Acoustic Tile	Ceiling Tiles (lay-in), 2x2 Short Fissure and Random Pinhole (date stamped 05/18/09)			C	Y						V0000	Non-Asbestos		None	
Floor		Vinyl Floor Tile and Mastic, Dark Pink Marble			A	Y		100			%	V9500	Presumed Asbestos		Presumed Asbestos	NF
Floor		Vinyl Floor Tile and Mastic, Pink Marble			A	Y		100			%	V9500	Presumed Asbestos		Presumed Asbestos	NF
Piping		Fibreglass	Insulation		C	Y										
Wall		Wood, Wood Paneling			A	Y										
Wall		Plaster			A	Y		100			%	S0005C	None Detected	N.D.	None	

ALL DATA REPORT

Client: Hamilton-Wentworth Catholic District Sch **Site:** Admin
Location: #2025 : Photography Room **Floor:** 2
Survey Date: 2017-09-08

Building Name: Father Kyran Kennedy Catholic Education Centre
Room #: **Area (sqft):** 0
Last Re-Assessment: 2022-05-24

ASBESTOS																
System	Component	Material	Item	Covering	A*	V*	AP*	Good	Fair	Poor	Unit	Sample	Asbestos Type	Amount	Hazard	Friable
Ceiling	Acoustic Tile	Ceiling Tiles (lay-in), 24x48 pinhole and fleck (date stamp 2015)			C	Y						V0000	Non-Asbestos		None	
Floor		Vinyl Floor Tile and Mastic, 9x9 beige		Carpet	D	N		100			%	V9500	Presumed Asbestos		Presumed Asbestos	NF
Floor		Carpet			A	Y										
Piping		Parging Cement	Fitting		C	N		3			EA	V0009	Chrysotile	50-75%	Confirmed Asbestos	F
Wall		Drywall and joint compound			A	Y						S0006A	None Detected	N.D.	None	
Wall		Plaster			A	Y		100			%	V0005	None Detected	N.D.	None	

Client: Hamilton-Wentworth Catholic District Sch **Site:** Admin
Location: #3001 : Conference Room **Floor:** 3
Survey Date: 2017-09-08

Building Name: Father Kyran Kennedy Catholic Education Centre
Room #: **Area (sqft):** 0
Last Re-Assessment: 2022-05-24

ASBESTOS																
System	Component	Material	Item	Covering	A*	V*	AP*	Good	Fair	Poor	Unit	Sample	Asbestos Type	Amount	Hazard	Friable
Ceiling	Acoustic Tile	Ceiling Tiles (lay-in), 2x2 Short Fissure and Random Pinhole (date stamped 05/18/09)			C	Y						V0000	Non-Asbestos		None	
Floor		Carpet			A	Y										
Piping		Fibreglass	Insulation		C	Y										
Wall		Drywall and joint compound			A	Y		100			%	S0008C	None Detected	N.D.	None	
Wall		Plaster			A	Y		100			%	V0005	None Detected	N.D.	None	

ALL DATA REPORT

Client: Hamilton-Wentworth Catholic District Sch **Site:** Admin

Location: #3002 : Office

Survey Date: 2017-09-08

Floor: 3

Building Name: Father Kyran Kennedy Catholic

Education Centre

Room #:

Last Re-Assessment: 2022-05-24

Area (sqft): 0

ASBESTOS																
System	Component	Material	Item	Covering	A*	V*	AP*	Good	Fair	Poor	Unit	Sample	Asbestos Type	Amount	Hazard	Friable
Ceiling	Acoustic Tile	Ceiling Tiles (lay-in), 2x2 Short Fissure and Random Pinhole (date stamped 05/18/09)			C	Y						V0000	Non-Asbestos		None	
Floor		Vinyl Floor Tile and Mastic, Cream with Brown and White Specks			A	Y		100			%	V9500	Presumed Asbestos		Presumed Asbestos	NF
Floor		Vinyl Floor Tile and Mastic, Brown with Multi-Brown Fleck			A	Y		100			%	V9500	Presumed Asbestos		Presumed Asbestos	NF
Piping		Fibreglass	Insulation		C	Y										
Wall		Drywall and joint compound			A	Y		100			%	V0008	None Detected	N.D.	None	
Wall		Plaster			A	Y		100			%	V0005	None Detected	N.D.	None	

Client: Hamilton-Wentworth Catholic District Sch **Site:** Admin

Location: #3003 : Office

Survey Date: 2017-09-08

Floor: 3

Building Name: Father Kyran Kennedy Catholic

Education Centre

Room #:

Last Re-Assessment: 2022-05-24

Area (sqft): 0

ASBESTOS																
System	Component	Material	Item	Covering	A*	V*	AP*	Good	Fair	Poor	Unit	Sample	Asbestos Type	Amount	Hazard	Friable
Ceiling	Acoustic Tile	Ceiling Tiles (lay-in), 2x2 Short Fissure and Random Pinhole (date stamped 05/18/09)			C	Y		100			%	V0000	Non-Asbestos		None	
Floor		Vinyl Floor Tile and Mastic, Cream with Brown and White Specks			A	Y		100			%	V9500	Presumed Asbestos		Presumed Asbestos	NF
Floor		Vinyl Floor Tile and Mastic, Brown with Multi-Brown Fleck			A	Y		100			%	V9500	Presumed Asbestos		Presumed Asbestos	NF
Piping		Fibreglass	Insulation		C	Y										
Wall		Drywall and joint compound			A	Y		100			%	V0008	None Detected	N.D.	None	
Wall		Plaster			A	Y		100			%	V0005	None Detected	N.D.	None	

ALL DATA REPORT

Client: Hamilton-Wentworth Catholic District Sch **Site:** Admin
Location: #3004 : Chapel **Floor:** 3
Survey Date: 2017-09-08

Building Name: Father Kyran Kennedy Catholic Education Centre
Room #: **Area (sqft):** 0
Last Re-Assessment: 2022-05-24

ASBESTOS																
System	Component	Material	Item	Covering	A*	V*	AP*	Good	Fair	Poor	Unit	Sample	Asbestos Type	Amount	Hazard	Friable
Ceiling	Acoustic Tile	Ceiling Tiles (lay-in), 2x2 Short Fissure and Random Pinhole (date stamped 05/18/09)			C	Y						V0000	Non-Asbestos		None	
Floor		Carpet			A	Y										
Piping		Fibreglass	Insulation		C	Y										
Wall		Drywall and joint compound			A	Y		100			%	V0008	None Detected	N.D.	None	
Wall		Plaster			A	Y		100			%	V0005	None Detected	N.D.	None	
Wall		Texture Coat			A	Y		100			%	S0007ABC	None Detected	N.D.	None	

Client: Hamilton-Wentworth Catholic District Sch **Site:** Admin
Location: #3005 : Reception **Floor:** 3
Survey Date: 2017-09-08

Building Name: Father Kyran Kennedy Catholic Education Centre
Room #: **Area (sqft):** 0
Last Re-Assessment: 2022-05-24

ASBESTOS																
System	Component	Material	Item	Covering	A*	V*	AP*	Good	Fair	Poor	Unit	Sample	Asbestos Type	Amount	Hazard	Friable
Ceiling	Acoustic Tile	Ceiling Tiles (lay-in), 2x2 Textured Pattern (previously sampled)			C	Y						V0000	Non-Asbestos		None	
Floor		Carpet			A	Y										
Piping		Fibreglass	Insulation		C	Y										
Wall		Drywall and joint compound			A	Y		100			%	S0008B	None Detected	N.D.	None	
Wall		Plaster			A	Y		100			%	V0005	None Detected	N.D.	None	

Client: Hamilton-Wentworth Catholic District Sch **Site:** Admin
Location: #3006 : Directors Office **Floor:** 3
Survey Date: 2017-09-08

Building Name: Father Kyran Kennedy Catholic Education Centre
Room #: **Area (sqft):** 0
Last Re-Assessment: 2022-05-24

ASBESTOS																
System	Component	Material	Item	Covering	A*	V*	AP*	Good	Fair	Poor	Unit	Sample	Asbestos Type	Amount	Hazard	Friable
Ceiling	Acoustic Tile	Ceiling Tiles (lay-in), 2x2 Textured Pattern (previously sampled)			C	Y						V0000	Non-Asbestos		None	
Floor		Carpet			A	Y										
Piping		Fibreglass	Insulation		C	Y										
Wall		Drywall and joint compound			A	Y		100			%	V0008	None Detected	N.D.	None	
Wall		Plaster			A	Y		100			%	V0005	None Detected	N.D.	None	

Client: Hamilton-Wentworth Catholic District Sch **Site:** Admin
Location: #3007 : Meeting Room **Floor:** 3
Survey Date: 2017-09-08

Building Name: Father Kyran Kennedy Catholic Education Centre
Room #: **Area (sqft):** 0
Last Re-Assessment: 2022-05-24

ASBESTOS																
System	Component	Material	Item	Covering	A*	V*	AP*	Good	Fair	Poor	Unit	Sample	Asbestos Type	Amount	Hazard	Friable
Ceiling	Acoustic Tile	Ceiling Tiles (lay-in), 2x2 Textured Pattern (previously sampled)			C	Y						V0000	Non-Asbestos		None	
Floor		Carpet			A	Y										
Piping		Fibreglass	Insulation		C	Y										
Wall		Drywall and joint compound			A	Y		100			%	V0008	None Detected	N.D.	None	
Wall		Plaster			A	Y		100			%	V0005	None Detected	N.D.	None	

ALL DATA REPORT

Client: Hamilton-Wentworth Catholic District Sch **Site:** Admin
Location: #3008 : Mens Washroom **Floor:** 3
Survey Date: 2017-09-08

Building Name: Father Kyran Kennedy Catholic Education Centre
Room #: **Area (sqft):** 0
Last Re-Assessment: 2022-05-24

ASBESTOS																
System	Component	Material	Item	Covering	A*	V*	AP*	Good	Fair	Poor	Unit	Sample	Asbestos Type	Amount	Hazard	Friable
Ceiling		Plaster			C	Y		100			%	V0005	None Detected	N.D.	None	
Floor		Terrazzo			A	Y										
Wall		Plaster			A	Y		100			%	S0005G	None Detected	N.D.	None	

Client: Hamilton-Wentworth Catholic District Sch **Site:** Admin
Location: #3009 : Custodian Room **Floor:** 3
Survey Date: 2017-09-08

Building Name: Father Kyran Kennedy Catholic Education Centre
Room #: **Area (sqft):** 0
Last Re-Assessment: 2022-05-24

ASBESTOS																
System	Component	Material	Item	Covering	A*	V*	AP*	Good	Fair	Poor	Unit	Sample	Asbestos Type	Amount	Hazard	Friable
Ceiling	Skylight	Metal			C	Y										
Floor		Vinyl Floor Tile and Mastic, Cream with Brown and White Speck			A	Y		100			%	V9500	Presumed Asbestos		Presumed Asbestos	NF
Floor		Vinyl Floor Tile and Mastic, Brown with Multi-Brown Fleck			A	Y		100			%	V9500	Presumed Asbestos		Presumed Asbestos	NF
Wall		Drywall and joint compound			A	Y		100			%	V0008	None Detected	N.D.	None	
Wall		Plaster			A	Y		100			%	V0005	None Detected	N.D.	None	

ALL DATA REPORT

Client: Hamilton-Wentworth Catholic District Sch **Site:** Admin
Location: #3010 : Womens Washroom **Floor:** 3
Survey Date: 2017-09-08

Building Name: Father Kyran Kennedy Catholic Education Centre
Room #: **Area (sqft):** 0
Last Re-Assessment: 2022-05-24

ASBESTOS																
System	Component	Material	Item	Covering	A*	V*	AP*	Good	Fair	Poor	Unit	Sample	Asbestos Type	Amount	Hazard	Friable
Ceiling	Acoustic Tile	Ceiling tiles (glue-on), 1x1 Fissured (previously sampled)			C	Y		100			%	V9000	Confirmed Asbestos		Confirmed Asbestos	PF
Floor		Terrazzo			A	Y										
Wall		Plaster			A	Y		100			%	S0005E	None Detected	N.D.	None	

Client: Hamilton-Wentworth Catholic District Sch **Site:** Admin
Location: #3011 : Stairwell **Floor:** 3
Survey Date: 2017-09-08

Building Name: Father Kyran Kennedy Catholic Education Centre
Room #: **Area (sqft):** 0
Last Re-Assessment: 2022-05-24

ASBESTOS																
System	Component	Material	Item	Covering	A*	V*	AP*	Good	Fair	Poor	Unit	Sample	Asbestos Type	Amount	Hazard	Friable
Ceiling	Acoustic Tile	Ceiling Tiles (lay-in), 2x2 Short Fissure and Random Pinhole (date stamped 05/18/09)			C	Y						V0000	Non-Asbestos		None	
Floor		Terrazzo			A	Y										
Wall		Plaster			A	Y		100			%	V0005	None Detected	N.D.	None	

ALL DATA REPORT

Client: Hamilton-Wentworth Catholic District Sch **Site:** Admin
Location: #3012 : Open Office Area **Floor:** 3
Survey Date: 2017-09-08

Building Name: Father Kyran Kennedy Catholic Education Centre
Room #: **Area (sqft):** 0
Last Re-Assessment: 2022-05-24

ASBESTOS																
System	Component	Material	Item	Covering	A*	V*	AP*	Good	Fair	Poor	Unit	Sample	Asbestos Type	Amount	Hazard	Friable
Ceiling	Acoustic Tile	Ceiling Tiles (lay-in), 2x2 Short Fissure and Random Pinhole (date stamped 05/18/09)			C	Y						V0000	Non-Asbestos		None	
Floor		Vinyl Floor Tile and Mastic, Cream with Brown and White Specks			A	Y		100			%	V9500	Presumed Asbestos		Presumed Asbestos	NF
Floor		Vinyl Floor Tile and Mastic, Brown with Multi-Brown Fleck			A	Y		100			%	V9500	Presumed Asbestos		Presumed Asbestos	NF
Piping		Fibreglass	Insulation		C	Y										
Wall		Wood, Wood Paneling			A	Y										
Wall		Drywall and joint compound			A	Y		100			%	V0008	None Detected	N.D.	None	
Wall		Plaster			A	Y		100			%	V0005	None Detected	N.D.	None	

Client: Hamilton-Wentworth Catholic District Sch **Site:** Admin
Location: #3013 : Office **Floor:** 3
Survey Date: 2017-09-08

Building Name: Father Kyran Kennedy Catholic Education Centre
Room #: **Area (sqft):** 0
Last Re-Assessment: 2022-05-24

ASBESTOS																
System	Component	Material	Item	Covering	A*	V*	AP*	Good	Fair	Poor	Unit	Sample	Asbestos Type	Amount	Hazard	Friable
Ceiling	Acoustic Tile	Ceiling Tiles (lay-in), 2x2 Short Fissure and Random Pinhole (date stamped 05/18/19)			C	Y					%	V0000	Non-Asbestos		None	
Floor		Carpet			A	Y										
Piping		Fibreglass	Insulation		C	Y										
Wall		Drywall and joint compound			A	Y		100			%	V0008	None Detected	N.D.	None	
Wall		Plaster			A	Y		100			%	S0005F	None Detected	N.D.	None	

ALL DATA REPORT

Client: Hamilton-Wentworth Catholic District Sch **Site:** Admin

Location: #3014 : Office

Survey Date: 2017-09-08

Floor: 3

Building Name: Father Kyran Kennedy Catholic

Education Centre

Room #:

Last Re-Assessment: 2022-05-24

Area (sqft): 0

ASBESTOS																
System	Component	Material	Item	Covering	A*	V*	AP*	Good	Fair	Poor	Unit	Sample	Asbestos Type	Amount	Hazard	Friable
Ceiling	Acoustic Tile	Ceiling Tiles (lay-in), 2x2 Short Fissure and Random Pinhole (date stamped 05/18/09)			C	Y					%	V0000	Non-Asbestos		None	
Floor		Vinyl Floor Tile and Mastic, Cream with Brown and White Specks			A	Y		100			%	V9500	Presumed Asbestos		Presumed Asbestos	NF
Floor		Vinyl Floor Tile and Mastic, Brown with Multi-Brown Fleck			A	Y		100			%	V9500	Presumed Asbestos		Presumed Asbestos	NF
Piping		Fibreglass	Insulation		C	Y										
Wall		Drywall and joint compound			A	Y		100			%	V0008	None Detected	N.D.	None	
Wall		Plaster			A	Y		100			%	V0005	None Detected	N.D.	None	

Client: Hamilton-Wentworth Catholic District Sch **Site:** Admin

Location: #3015 : Office

Survey Date: 2017-09-08

Floor: 3

Building Name: Father Kyran Kennedy Catholic

Education Centre

Room #:

Last Re-Assessment: 2022-05-24

Area (sqft): 0

ASBESTOS																
System	Component	Material	Item	Covering	A*	V*	AP*	Good	Fair	Poor	Unit	Sample	Asbestos Type	Amount	Hazard	Friable
Ceiling	Acoustic Tile	Ceiling Tiles (lay-in), 2x2 Short Fissure and Random Pinhole (date stamped 05/18/09)			C	Y						V0000	Non-Asbestos		None	
Floor		Vinyl Floor Tile and Mastic, Cream with Brown and White Specks			A	Y		100			%	V9500	Presumed Asbestos		Presumed Asbestos	NF
Floor		Vinyl Floor Tile and Mastic, Brown with Multi-Brown Fleck			A	Y		100			%	V9500	Presumed Asbestos		Presumed Asbestos	NF
Piping		Fibreglass	Insulation		C	Y										
Wall		Drywall and joint compound			A	Y		100			%	S0008A	None Detected	N.D.	None	
Wall		Plaster			A	Y		100			%	S0005	None Detected	N.D.	None	

ALL DATA REPORT

Client: Hamilton-Wentworth Catholic District Sch **Site:** Admin

Location: #3016 : File Room

Survey Date: 2017-09-08

Floor: 3

Building Name: Father Kyran Kennedy Catholic Education Centre

Room #:

Last Re-Assessment: 2022-05-24

Area (sqft): 0

ASBESTOS																
System	Component	Material	Item	Covering	A*	V*	AP*	Good	Fair	Poor	Unit	Sample	Asbestos Type	Amount	Hazard	Friable
Ceiling	Acoustic Tile	Ceiling Tiles (lay-in), 2x2 Short Fissure and Random Pinhole (date stamped 05/18/09)			C	Y						V0000	Non-Asbestos		None	
Floor		Vinyl Floor Tile and Mastic, Cream with Brown and White Specks			A	Y		100			%	V9500	Presumed Asbestos		Presumed Asbestos	NF
Floor		Vinyl Floor Tile and Mastic, Brown with Multi-Brown Fleck			A	Y		100			%	V9500	Presumed Asbestos		Presumed Asbestos	NF
Piping		Fibreglass	Insulation		C	Y										
Wall		Drywall and joint compound			A	Y		100			%	V0008	None Detected	N.D.	None	
Wall		Plaster			A	Y		100			%	V0005	None Detected	N.D.	None	

Client: Hamilton-Wentworth Catholic District Sch **Site:** Admin

Location: #3017 : Office

Survey Date: 2017-09-08

Floor: 3

Building Name: Father Kyran Kennedy Catholic Education Centre

Room #:

Last Re-Assessment: 2022-05-24

Area (sqft): 0

ASBESTOS																
System	Component	Material	Item	Covering	A*	V*	AP*	Good	Fair	Poor	Unit	Sample	Asbestos Type	Amount	Hazard	Friable
Ceiling	Acoustic Tile	Ceiling Tiles (lay-in), 2x2 Short Fissure and Random Pinhole (date stamped 05/18/09)			C	Y						V0000	Non-Asbestos		None	
Floor		Vinyl Floor Tile and Mastic, Cream with Brown and White Specks			A	Y		100			%	V9500	Presumed Asbestos		Presumed Asbestos	NF
Floor		Vinyl Floor Tile and Mastic, Brown with Multi-Brown Fleck			A	Y		100			%	V9500	Presumed Asbestos		Presumed Asbestos	NF
Piping		Fibreglass	Insulation		C	Y										
Wall		Drywall and joint compound			A	Y		100			%	V0008	None Detected	N.D.	None	
Wall		Plaster			A	Y		100			%	V0005	None Detected	N.D.	None	

ALL DATA REPORT

Client: Hamilton-Wentworth Catholic District Sch **Site:** Admin
Location: #3018 : Office **Floor:** 3
Survey Date: 2017-09-08

Building Name: Father Kyran Kennedy Catholic Education Centre
Room #: **Area (sqft):** 0
Last Re-Assessment: 2022-05-24

ASBESTOS																
System	Component	Material	Item	Covering	A*	V*	AP*	Good	Fair	Poor	Unit	Sample	Asbestos Type	Amount	Hazard	Friable
Ceiling	Acoustic Tile	Ceiling Tiles (lay-in), 2x2 Short Fissure and Random Pinhole (date stamped 05/18/09)			C	Y		100			%	V0000	Non-Asbestos		None	
Floor		Vinyl Floor Tile and Mastic, Cream with Brown and White Specks			A	Y		100			%	V9500	Presumed Asbestos		Presumed Asbestos	NF
Floor		Vinyl Floor Tile and Mastic, Brown with Multi-Brown Fleck			A	Y		100			%	V9500	Presumed Asbestos		Presumed Asbestos	NF
Piping		Fibreglass	Insulation		C	Y										
Wall		Drywall and joint compound			A	Y		100			%	V0008	None Detected	N.D.	None	
Wall		Plaster			A	Y		100			%	V0005	None Detected	N.D.	None	

Client: Hamilton-Wentworth Catholic District Sch **Site:** Admin
Location: #3019 : Staff Room **Floor:** 3
Survey Date: 2017-09-08

Building Name: Father Kyran Kennedy Catholic Education Centre
Room #: **Area (sqft):** 0
Last Re-Assessment: 2022-05-24

ASBESTOS																
System	Component	Material	Item	Covering	A*	V*	AP*	Good	Fair	Poor	Unit	Sample	Asbestos Type	Amount	Hazard	Friable
Ceiling	Acoustic Tile	Ceiling Tiles (lay-in), 2x2 Short Fissure and Random Pinhole (date stamped 05/18/09)			C	Y						V0000	Non-Asbestos		None	
Floor		Vinyl Floor Tile and Mastic, Cream with Brown and White Specks			A	Y		100			%	V9500	Presumed Asbestos		Presumed Asbestos	NF
Floor		Vinyl Floor Tile and Mastic, Brown with Multi-Brown Fleck			A	Y		100			%	V9500	Presumed Asbestos		Presumed Asbestos	NF
Piping		Fibreglass	Insulation		C	Y										
Wall		Drywall and joint compound			A	Y		100			%	V0008	None Detected	N.D.	None	
Wall		Plaster			A	Y		100			%	V0005	None Detected	N.D.	None	

Legend:



Sample number		Units		Other	
S####	Asbestos sample collected	SF	Square feet	A	Access
V####	Material visually similar to numbered sample collected	LF	Linear feet	V	Visible
V0000	Known non-asbestos material	EA	Each	AP	Air Plenum
V9000	Visually identified as an asbestos material	%	Percentage	F	Friable material
V9500	Material is presumed to be an asbestos material			NF	Non Friable material
				PF	Potentially Friable material

Access	
A	Accessible to all building occupants
B	Accessible to maintenance and operations staff without a ladder
C	Accessible to maintenance and operations staff with a ladder. Also rarely entered, locked areas
D	Not normally accessible

Condition	
Good	No visible damage or deterioration
Fair	Minor, repairable damage, cracking, delamination or deterioration
Poor	Irreparable damage or deterioration with exposed and missing material

Visible	
Y	The material is visible when standing on the floor of the room, without the removal or opening of other building components (e.g. ceiling tiles or access panels).
N	The material is not visible to view when standing on the floor of the room and requires the removal of a building component (e.g. ceilings tiles or access panels) to view and access. Includes rarely entered crawlspaces, attic spaces, etc. Observations will be limited to the extent visible from the access points.

Air Plenum	
Yes or No	The material is in a return air plenum or in a direct airstream or there is evidence of air erosion (e.g. duct for heating or cooling blowing directly on or across an ACM). This field is only completed where Air Plenum consideration is required by regulation.

Colour Coding	
	The material is known to contain regulated concentrations of asbestos; either by analytical results or visible identification (use of the V9000 code).
	The material is presumed to contain asbestos; based on visual appearances; typically a material known to historically contain asbestos; however, not sampled due to limited access or the destructive nature of the sampling.

APPENDIX V
Drawings

PIPES INSULATED WITH ASBESTOS-CONTAINING INSULATIONS MAY BE PRESENT IN INACCESSIBLE SPACES SUCH AS ABOVE SOLID CEILINGS, IN CHASES, IN COLUMN ENCLOSURES AND WITHIN SHAFTS.

NOT ALL KNOWN OR SUSPECTED ASBESTOS BUILDING MATERIALS MAY BE DEPICTED ON THE DRAWING. REFER TO THE ASBESTOS REASSESSMENT REPORT FOR A COMPLETE LIST OF KNOWN AND SUSPECTED ASBESTOS BUILDING MATERIALS.

LEGEND IS COLOUR DEPENDENT. NON-COLOUR COPIES MAY ALTER INTERPRETATION.

BASE PLAN PROVIDED BY CLIENT.

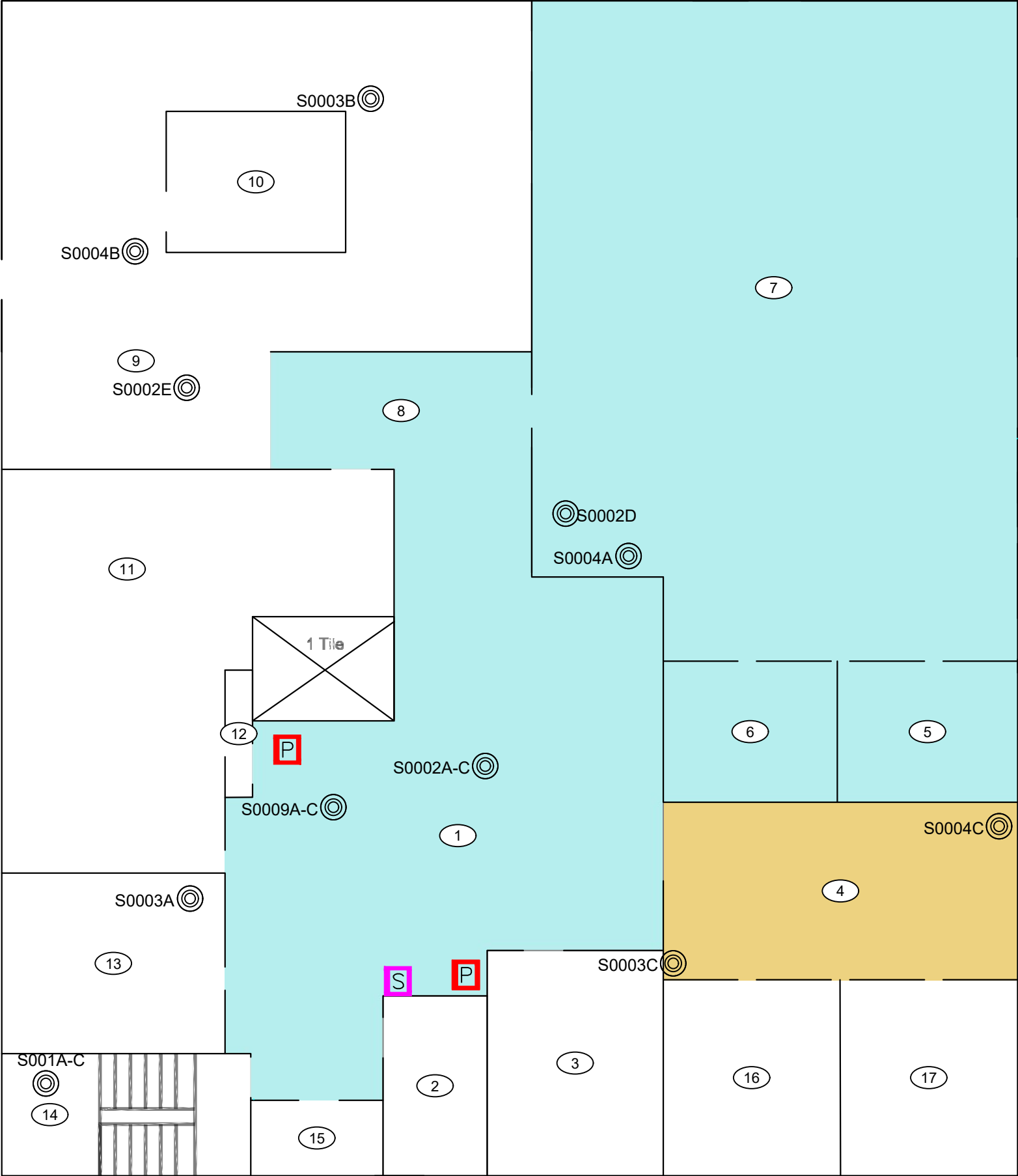

905-577-6206 www.pinchin.com

LEGEND:

- (X) LOCATION NUMBER
- ⊙ ASBESTOS BULK SAMPLE

ASBESTOS-CONTAINING MATERIALS:

- P PIPE INSULATION
- S SINK UNDERCOATING
- GLUE ON TILES
- TEXTURE FINISH CEILING
- VINYL FLOOR TILES AND MASTIC
- MASTIC

CLIENT:



LOCATION:
FATHER KYRAN KENNEDY
90 MULBERRY STREET
HAMILTON, ONTARIO

TITLE:
ASBESTOS REASSESSMENT
BASEMENT LEVEL

DATE: AUGUST 2022 PROJECT # : 303992.004

DRAWN BY: EB
CHECKED BY: EB
SCALE: NTS
DRAWING:
1 OF 4

PIPES INSULATED WITH ASBESTOS-CONTAINING INSULATIONS MAY BE PRESENT IN INACCESSIBLE SPACES SUCH AS ABOVE SOLID CEILINGS, IN CHASES, IN COLUMN ENCLOSURES AND WITHIN SHAFTS.

NOT ALL KNOWN OR SUSPECTED ASBESTOS BUILDING MATERIALS MAY BE DEPICTED ON THE DRAWING. REFER TO THE ASBESTOS REASSESSMENT REPORT FOR A COMPLETE LIST OF KNOWN AND SUSPECTED ASBESTOS BUILDING MATERIALS.

LEGEND IS COLOUR DEPENDENT. NON-COLOUR COPIES MAY ALTER INTERPRETATION.

BASE PLAN PROVIDED BY CLIENT.

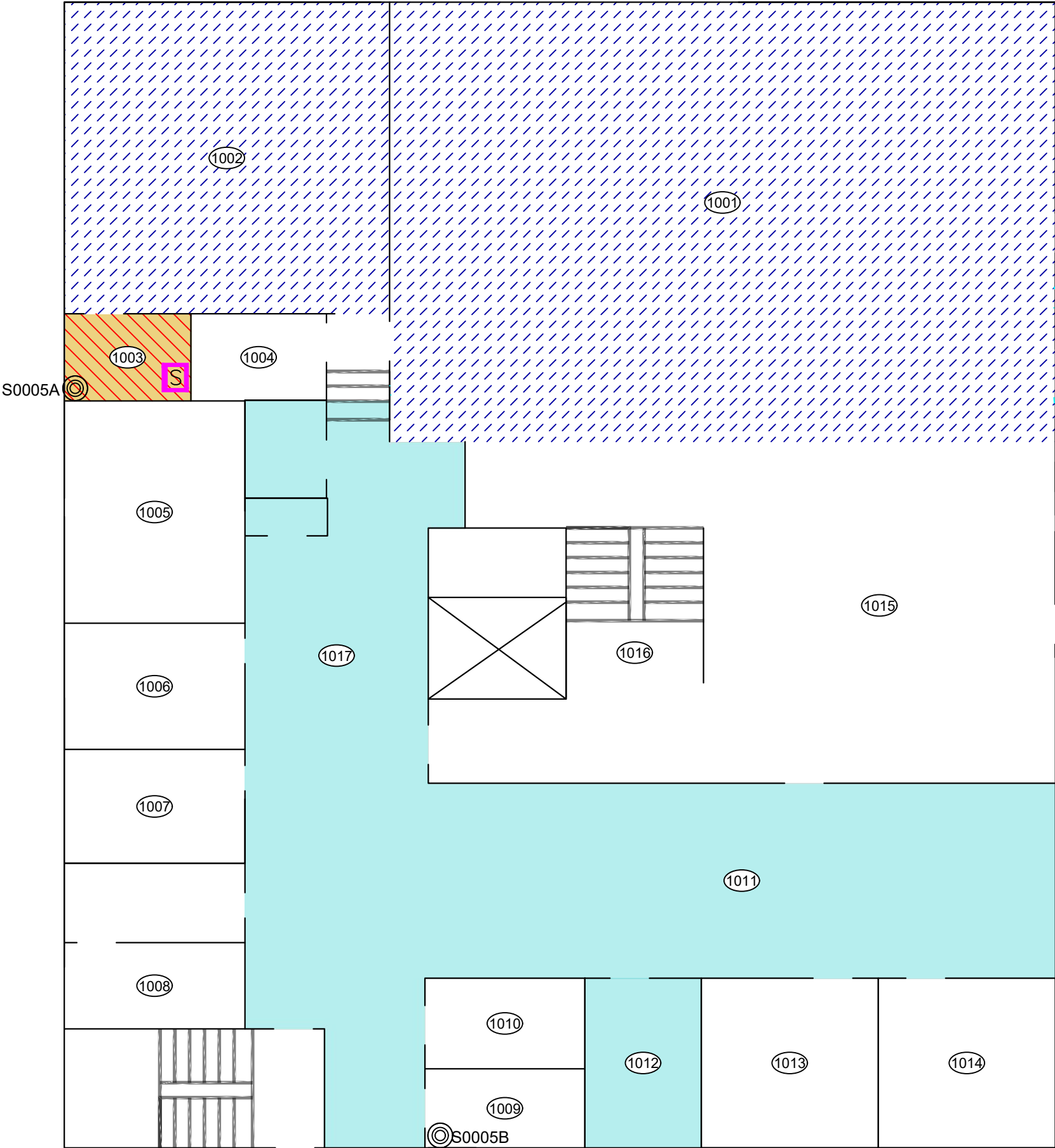

905-577-6206 www.pinchin.com

LEGEND:

- (X) LOCATION NUMBER
- ⊙ ASBESTOS BULK SAMPLE

ASBESTOS-CONTAINING MATERIALS:

- P PIPE INSULATION
- S SINK UNDERCOATING
- GLUE ON TILES
- TEXTURE FINISH CEILING
- VINYL FLOOR TILES AND MASTIC
- MASTIC

CLIENT:



LOCATION:
FATHER KYRAN KENNEDY
90 MULBERRY STREET
HAMILTON, ONTARIO

TITLE:

ASBESTOS REASSESSMENT
FLOOR LEVEL 1

DATE: AUGUST 2022	PROJECT # : 303992.004
DRAWN BY: EB	DRAWING: 2 OF 4
CHECKED BY: EB	
SCALE: NTS	

PIPES INSULATED WITH ASBESTOS-CONTAINING INSULATIONS MAY BE PRESENT IN INACCESSIBLE SPACES SUCH AS ABOVE SOLID CEILINGS, IN CHASES, IN COLUMN ENCLOSURES AND WITHIN SHAFTS.

NOT ALL KNOWN OR SUSPECTED ASBESTOS BUILDING MATERIALS MAY BE DEPICTED ON THE DRAWING. REFER TO THE ASBESTOS REASSESSMENT REPORT FOR A COMPLETE LIST OF KNOWN AND SUSPECTED ASBESTOS BUILDING MATERIALS.

LEGEND IS COLOUR DEPENDENT. NON-COLOUR COPIES MAY ALTER INTERPRETATION.

BASE PLAN PROVIDED BY CLIENT.

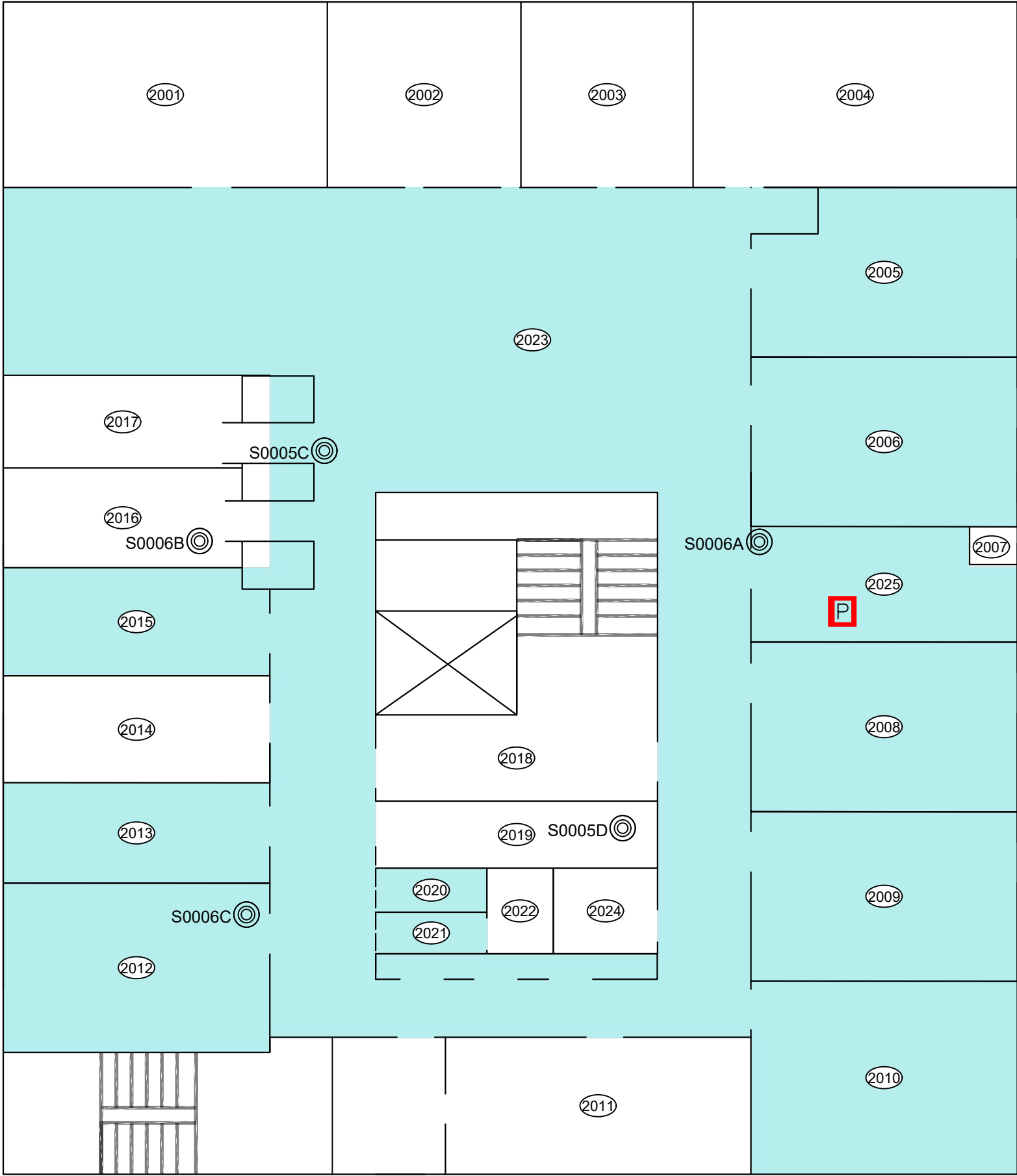

905-577-6206 www.pinchin.com

LEGEND:

- (X) LOCATION NUMBER
- (●) ASBESTOS BULK SAMPLE

ASBESTOS-CONTAINING MATERIALS:

- [P] PIPE INSULATION
- [S] SINK UNDERCOATING
- [Hatched] GLUE ON TILES
- [Dotted] TEXTURE FINISH CEILING
- [Light Blue] VINYL FLOOR TILES AND MASTIC
- [Yellow] MASTIC

CLIENT:



LOCATION:
FATHER KYRAN KENNEDY
90 MULBERRY STREET
HAMILTON, ONTARIO

TITLE:

ASBESTOS REASSESSMENT
FLOOR LEVEL 2

DATE: AUGUST 2022	PROJECT # : 303992.004
DRAWN BY: EB	DRAWING: 3 OF 4
CHECKED BY: EB	
SCALE: NTS	

PIPES INSULATED WITH ASBESTOS-CONTAINING INSULATIONS MAY BE PRESENT IN INACCESSIBLE SPACES SUCH AS ABOVE SOLID CEILINGS, IN CHASES, IN COLUMN ENCLOSURES AND WITHIN SHAFTS.

NOT ALL KNOWN OR SUSPECTED ASBESTOS BUILDING MATERIALS MAY BE DEPICTED ON THE DRAWING. REFER TO THE ASBESTOS REASSESSMENT REPORT FOR A COMPLETE LIST OF KNOWN AND SUSPECTED ASBESTOS BUILDING MATERIALS.

LEGEND IS COLOUR DEPENDENT. NON-COLOUR COPIES MAY ALTER INTERPRETATION.

BASE PLAN PROVIDED BY CLIENT.

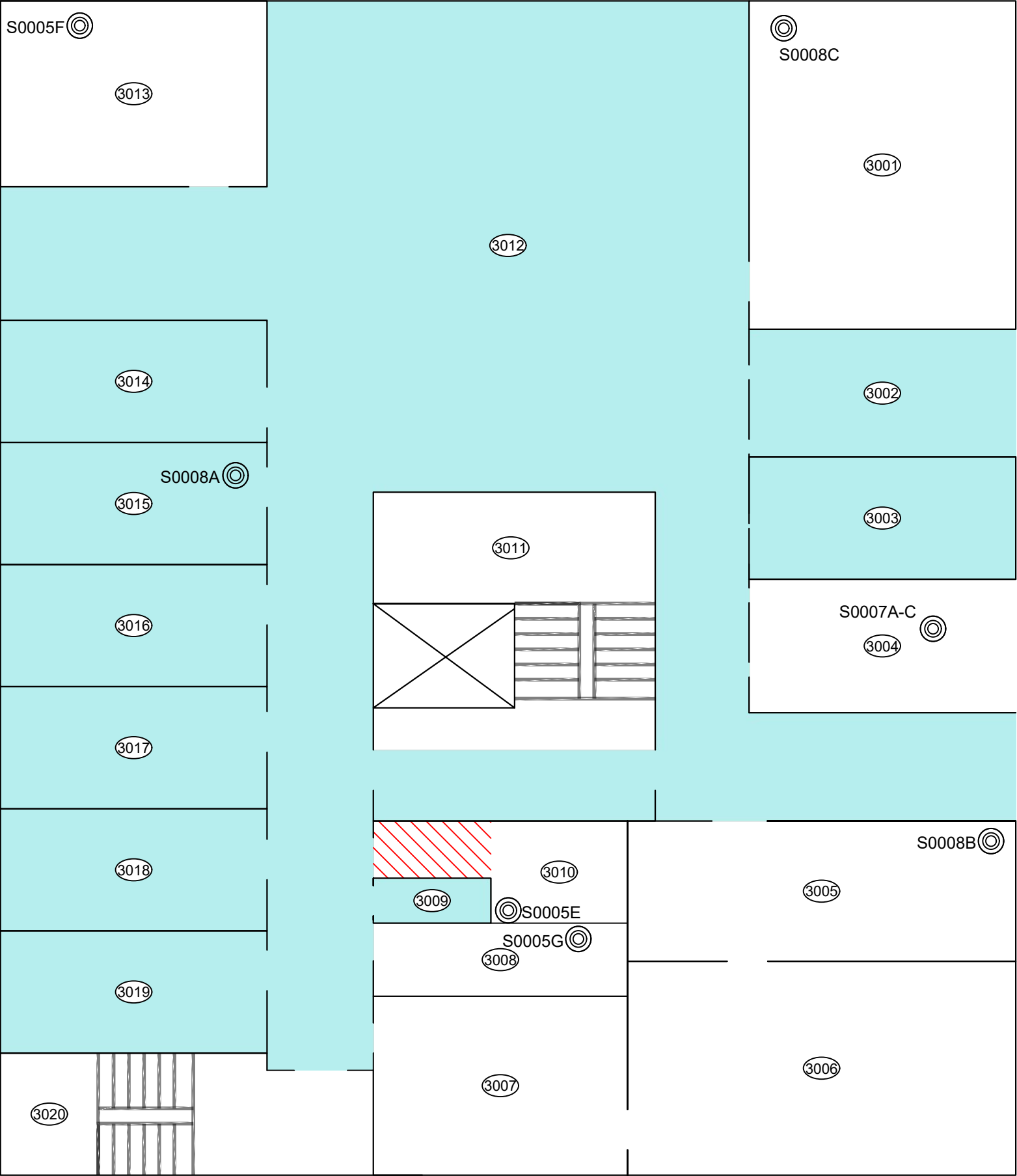

905-577-6206 www.pinchin.com

- LEGEND:
- (X) LOCATION NUMBER
 - ⊙ ASBESTOS BULK SAMPLE

ASBESTOS-CONTAINING MATERIALS:

- P PIPE INSULATION
- S SINK UNDERCOATING
- GLUE ON TILES
- TEXTURE FINISH CEILING
- VINYL FLOOR TILES AND MASTIC
- MASTIC

CLIENT:



**Hamilton-Wentworth
Catholic District School Board**
Believing. Achieving. Serving

LOCATION:
FATHER KYRAN KENNEDY
90 MULBERRY STREET
HAMILTON, ONTARIO

TITLE:

ASBESTOS REASSESSMENT
FLOOR LEVEL 3

DATE: AUGUST 2022	PROJECT # : 303992.004
DRAWN BY: EB	DRAWING: 4 OF 4
CHECKED BY: EB	
SCALE: NTS	