



Asbestos Reassessment

Blessed Sacrament
315 East 37th Street, Hamilton,
Ontario

Prepared for:

**Hamilton-Wentworth Catholic
District School Board**

90 Mulberry Street
Hamilton, Ontario, L8N 3R9

August 18, 2022

Pinchin File: 303992.004



Asbestos Reassessment

Blessed Sacrament, 315 East 37th Street, Hamilton, Ontario
Hamilton-Wentworth Catholic District School Board

August 18, 2022
Pinchin File: 303992.004

Issued to: Hamilton-Wentworth Catholic District
School Board

Issued on: August 18, 2022

Pinchin File: 303992.004

Issuing Office: Hamilton, ON

Pinchin Contact: Emily Balfour, Project Manager
365.889.5147
ebalfour@pinchin.com



Hamilton-Wentworth
Catholic District School Board
Believing, Achieving, Serving

Author: _____
Emily Balfour
Project Manager
365.889.5147
ebalfour@pinchin.com

Reviewer: _____
Damian Palus, C.E.T.
Operations Manager
289.678.0694
dpalus@pinchin.com



EXECUTIVE SUMMARY

Hamilton-Wentworth Catholic District School Board (Client) retained Pinchin Ltd. (Pinchin) to conduct an asbestos building materials reassessment at the subject building.

The objective of the reassessment was to evaluate the condition and quantity of previously reported asbestos-containing materials (ACM), and develop corrective action plans as required for the purposes of long-term management. The results of this reassessment are not intended for construction, renovation, demolition or project tendering purposes.

Summary of Recommendations

The following is a summary of significant recommendations; refer to the body of the report for detailed recommendations:

- Perform a reassessment of asbestos materials on an annual basis.
- Perform a pre-construction assessment and remove all asbestos-containing materials (ACM) prior to alteration or maintenance work if ACM may be disturbed by the work.
- Follow appropriate safe work procedures when handling or disturbing asbestos.
- Sample any presumed ACM prior to alteration or maintenance work if presumed ACM may be disturbed by the work.

This Executive Summary is subject to the same standard limitations as contained in the report and must be read in conjunction with the entire report.



Asbestos Reassessment

Blessed Sacrament, 315 East 37th Street, Hamilton, Ontario
Hamilton-Wentworth Catholic District School Board

August 18, 2022
Pinchin File: 303992.004

TABLE OF CONTENTS

1.0	INTRODUCTION AND SCOPE	1
1.1	Scope of Assessment	1
2.0	BACKGROUND INFORMATION	1
2.1	Building Year of Construction and Additions	1
2.2	Existing Reports	1
3.0	FINDINGS	2
3.1	Excluded Asbestos Materials	2
3.2	Confirmed/Presumed Asbestos-Containing Materials and Confirmed Non-Asbestos Materials	3
4.0	RECOMMENDATIONS	9
4.1	General	9
4.2	Remedial Work	9
4.3	On-going Management and Maintenance	9
5.0	TERMS AND LIMITATIONS	10
6.0	REFERENCES	10

APPENDICES

APPENDIX I	Asbestos Analytical Certificates
APPENDIX II	Location List
APPENDIX III	Hazardous Materials Summary / Sample Log Report
APPENDIX IV	All Data Report
APPENDIX V	Drawings



Asbestos Reassessment

Blessed Sacrament, 315 East 37th Street, Hamilton, Ontario
Hamilton-Wentworth Catholic District School Board

August 18, 2022
Pinchin File: 303992.004

1.0 INTRODUCTION AND SCOPE

Hamilton-Wentworth Catholic District School Board (Client) retained Pinchin Ltd. (Pinchin) to conduct an asbestos building materials reassessment at Blessed Sacrament located at 315 East 37th Street, Hamilton, Ontario.

The reassessment was performed by Matt Pitman, Project Technologist on May 11, 2022.

The objectives of the reassessment were to document the locations, quantities and conditions of previously identified asbestos-containing building materials and develop corrective action plans as required. This reassessment is only to be used for the purposes of long-term management and routine maintenance. The results of this reassessment are not to be used for construction, renovation, demolition or project tendering purposes.

1.1 Scope of Assessment

The objective of the reassessment was to evaluate the condition and quantity of previously reported asbestos-containing materials (ACM's), and develop corrective action plans as required.

Refer to the Asbestos Building Materials Reassessment Methodology report and Annex A dated 2022, Pinchin File 303992.004, for the methodology used during the reassessment.

2.0 BACKGROUND INFORMATION

2.1 Building Year of Construction and Additions

Item	Details
Year of Construction	1953
Year(s) of Additions	1956, 1958, 1962, 1971, and 1985

2.2 Existing Reports

2.2.1 Review of Previous Reports

Pinchin previously prepared the following report, which has been reviewed and relied upon as part of this assessment:

- Asbestos Assessment, Blessed Sacrament, 315 East 37th Street, Hamilton, Ontario, September 2018, Prepared by Pinchin Ltd., Pinchin File: 224334.
- Asbestos Reassessment, Blessed Sacrament, 315 East 37th Street, Hamilton, Ontario, September 2019, Prepared by Pinchin Ltd., Pinchin File: 243241.



Asbestos Reassessment

Blessed Sacrament, 315 East 37th Street, Hamilton, Ontario
Hamilton-Wentworth Catholic District School Board

August 18, 2022
Pinchin File: 303992.004

- Asbestos Reassessment, Blessed Sacrament, 315 East 37th Street, Hamilton, Ontario, May 2020, Prepared by Pinchin Ltd., Pinchin File: 272113.
- Asbestos Reassessment, Blessed Sacrament, 315 East 37th Street, Hamilton, Ontario, June 2021, Prepared by Pinchin Ltd., Pinchin File: 286533.001.

3.0 FINDINGS

The following section summarizes the findings of the reassessment and provides a general description of the asbestos materials identified. For details on quantities, assessment, sample numbers, friability, condition, and locations of asbestos materials; refer to the Hazardous Materials Summary / Sample Log Report and All Data Report in Appendices III and IV.

Previous analytical sample results have been relied upon and were included in the original asbestos assessment report completed by MTE Consultants Inc. Additional samples results where collected by Pinchin have been included in Appendix I.

3.1 Excluded Asbestos Materials

A number of materials which might contain asbestos were not sampled during this reassessment due to limitations in scope and methodology. Where present, these materials are assumed to contain asbestos until otherwise proven by sampling and analysis. These materials are not shown on the drawings in Appendix V. Excluded materials presumed to contain asbestos include:

Material	Friability
Roofing, felts and tar	Non-friable
Concrete floor levelling compound	Non-friable
Elevator and lift brakes	Non-friable
Electrical components or wiring within control centers, breakers, motors or lights, insulation on wiring	Non-friable
Vermiculite in concrete block wall cavities	Friable
Adhesives and duct mastics	Non-friable
Caulking and butyl seals	Non-friable
Fibre reinforced paints and coatings	Non-friable
Paper products	Non-friable

Material	Friability
Soffit and fascia boards	Non-friable
Mechanical packing, ropes and gaskets	Non-friable
Vinyl baseboards	Non-friable
Exterior cladding	Non-friable
Fire resistant doors or metal clad finishes	Non-friable
Stucco, plaster or other cementitious parge coatings	Potentially friable
Vibration dampers on HVAC equipment	Non-friable
Ceramic tile thin-set	Non-friable

3.2 Confirmed/Presumed Asbestos-Containing Materials and Confirmed Non-Asbestos Materials



This section includes materials that have been confirmed asbestos-containing by sample analysis or presumed asbestos-containing by visual identification. Refer to the drawings in Appendix V for the locations of confirmed and presumed ACMs indicated via hatching or symbols. The locations of samples from the historical assessments performed by Pinchin have been included on the drawings.

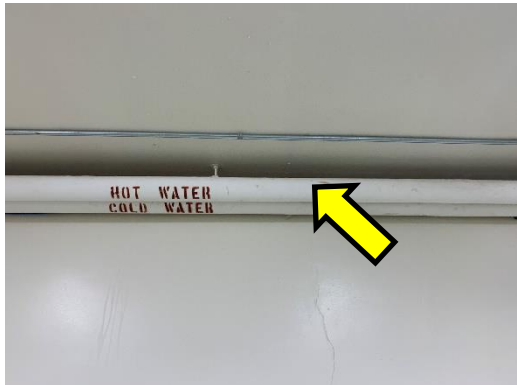

Material and Application	Asbestos Type/Friability	Photo
Parging cement is present on pipe fittings (elbows, valves, tees, hangers etc.).	Chrysotile/Friable	

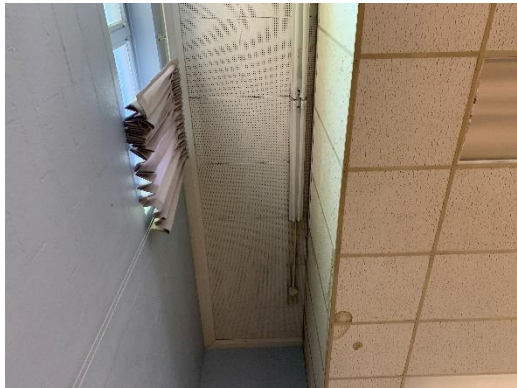
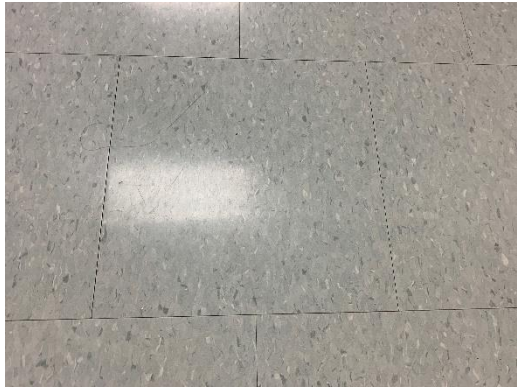
Material and Application	Asbestos Type/Friability	Photo
Parging cement is present as firestopping at outer perimeter hatch penetration in the Boiler Room (Location 1001).	Presumed/Potentially Friable	
A white corrugated paper insulation (trade name Aircell) is present on pipes.	Chrysotile/Friable	
Sweatwrap insulation (brown layered paper) is present on straight sections of pipes.	None	
Remaining pipes are either uninsulated or insulated with non-asbestos horsehair, fibreglass, or elastomeric insulation (Armaflex).	None	
Ducts are either uninsulated or insulated with non-asbestos fibreglass.	None	
Mechanical equipment is either uninsulated or insulated with non-asbestos fibreglass.	None	
24"x48" lay-in ceiling tiles, with a right-angled fissure and pinhole pattern are present.	Assumed other than chrysotile/Non-friable	

Material and Application	Asbestos Type/Friability	Photo
Remaining ceiling tiles were determined to be non-asbestos by sample analysis or are presumed to be non-asbestos based on the date of manufacture determined from the date stamp applied to the top of the tiles or the age of the materials determined from the age of the building renovation.	None	
Smooth plaster present on walls and ceilings does not contain asbestos.	None	
Textured plaster present on bulkheads and ceilings in Classrooms (Locations 1011-1021) does not contain asbestos.	None	
Asbestos-containing textured plaster is present on ceilings of the Kindergarten (Location 1042).	Chrysotile/Potentially friable	

Material and Application	Asbestos Type/Friability	Photo
Asbestos in drywall joint compound was banned in Canada in 1980. Any drywall joint compound in the building that was installed after 1986 (1980 plus a reasonable non-compliance period based on our experience) is assumed to contain no asbestos.	None	
Transite board is present as acoustic ceiling tiles and acoustic panels.	Presumed/Non-friable	
Vinyl floor tiles, 12"x12", light grey streaks, are present.	Presumed/Non-friable (tile) Presumed/Non-friable (mastic)	

Material and Application	Asbestos Type/Friability	Photo
Vinyl floor tiles, 12"x12", pink and white, are present.	Presumed/Non-friable (tile) Presumed/Non-friable (mastic)	
Vinyl floor tiles, 12"x12", light brown with light/dark streaks, are present.	Presumed/Non-friable (tile) Presumed/Non-friable (mastic)	
Vinyl floor tiles, 12"x12", white with black streaks, are present.	Presumed/Non-friable (tile) Presumed/Non-friable (mastic)	
Vinyl floor tiles, 12"x12", brown with white streaks, are present.	Presumed/Non-friable (tile) Presumed/Non-friable (mastic)	

Material and Application	Asbestos Type/Friability	Photo
Vinyl floor tiles, 12"x12", beige with light fleck, are present.	Presumed/Non-friable (tile) Presumed/Non-friable (mastic)	
Vinyl floor tiles, 12"x12", beige with pale marbling, are present.	Presumed/Non-friable (tile) Presumed/Non-friable (mastic)	
<p>Remaining vinyl floor tiles were presumed to be non-asbestos based on sample analysis or the historical knowledge of the date of installation.</p> <p>Mastic underneath new vinyl floor tiles is presumed to contain asbestos until further sampling proves otherwise.</p>	None (tile) Presumed/Non-friable (mastic)	
Asbestos-containing caulking present around doors was confirmed by previous sampling. The location of the caulking is unknown and is not present on the drawings.	Confirmed/Non-friable	

Material and Application	Asbestos Type/Friability	Photo
Gold mastic is present as a sink undercoating.	Presumed/Non-Friable	

4.0 RECOMMENDATIONS

4.1 General

Perform a detailed intrusive assessment prior to building renovation or demolition operations. The assessment should include; destructive testing (i.e. coring and/or removal of building finishes and components), sampling of other hazardous materials (lead, mercury, PCBs, mould, etc.), and materials not tested in this study (i.e. excluded asbestos materials).

4.2 Remedial Work

There is no remedial work recommended.

4.3 On-going Management and Maintenance

The following recommendations are made regarding on-going management and maintenance work involving the asbestos materials identified.

4.3.1 Asbestos

Maintain the Asbestos Management Program (AMP).

Perform a reassessment of asbestos materials on an annual basis.

Remove asbestos-containing materials (ACM) prior to alteration or maintenance work if ACM may be disturbed by the work. Follow appropriate asbestos precautions for the classification of work being performed.

Sample presumed ACM prior to alteration or maintenance work if the presumed ACM may be disturbed by the work.



Asbestos Reassessment

Blessed Sacrament, 315 East 37th Street, Hamilton, Ontario
Hamilton-Wentworth Catholic District School Board

August 18, 2022
Pinchin File: 303992.004

Update the asbestos inventory report upon completion of any abatement and removal of asbestos-containing materials.

5.0 TERMS AND LIMITATIONS

This work was performed subject to the Terms and Limitations presented or referenced in the proposal for this project.

Information provided by Pinchin is intended for Client use only. Pinchin will not provide results or information to any party unless disclosure by Pinchin is required by law. Any use by a third party of reports or documents authored by Pinchin or any reliance by a third party on or decisions made by a third party based on the findings described in said documents, is the sole responsibility of such third parties. Pinchin accepts no responsibility for damages suffered by any third party as a result of decisions made or actions conducted. No other warranties are implied or expressed.

6.0 REFERENCES

The following legislation and documents were referenced in completing the assessment and this report:

1. Asbestos on Construction Projects and in Buildings and Repair Operations, Ontario Regulation 278/05.
2. Designated Substances, Ontario Regulation 490/09.

\\pinchin.com\ham\Job\303000s\0303992.000 HWCDSB,Various2022Projects,ASB,CONS\0303992.004
HWCDSB,AllFacilities,2022,ASB,REASSMT\Deliverables\Elementary\Blessed Sacrament\Report\303992.004 Blessed Sacrament ACM Reassessment Report HWCDSB Aug
18 2022.docx

Template: Master Report for Asbestos Reassessment, HAZ, April 23, 2019

APPENDIX I
Asbestos Analytical Certificates



Bulk Asbestos Analysis

By Polarized Light Microscopy
EPA Method: 600/R-93/116 and 600/M4-82-020

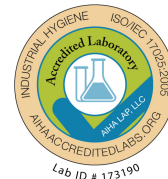

Customer: Pinchin Ltd.
6-875 Main St West
Suite 200
Hamilton, Ontario L8S 4P9

Attn: Leslie Cantar
Stephen Holmquist

Project: Blessed Sacrament; 315 E 37th St, Hamilton, ON

Lab Order ID: 51814301
Analysis ID: 51814301_PLM
Date Received: 6/8/2018
Date Reported: 6/9/2018
Date Amended: 6/18/2018

Sample ID	Description	Asbestos	Fibrous Components	Non-Fibrous Components	Attributes
Lab Sample ID	Lab Notes				Treatment
0013A	Pipe insulation, Sweatwrap, Loc:1006, Lower Corridor	None Detected	98% Cellulose	2% Other	Black, Brown Fibrous Homogeneous
51814301PLM_1					Ashed, Dissolved
0013B	Pipe insulation, Sweatwrap, Loc:1006, Lower Corridor	None Detected	98% Cellulose	2% Other	Black, Brown Fibrous Homogeneous
51814301PLM_2					Ashed, Dissolved
0013C	Pipe insulation, Sweatwrap, Loc:1006, Lower Corridor	None Detected	98% Cellulose	2% Other	Black, Brown Fibrous Homogeneous
51814301PLM_3					Ashed, Dissolved
0014A	Lay-in ceiling tile, 2x4 fewer long fissure and random pinhole, Loc:1037, Girls' Chan	None Detected	45% Cellulose 35% Mineral Wool	10% Perlite 10% Other	White Fibrous Homogeneous
51814301PLM_4					Ashed, Dissolved
0014B	Lay-in ceiling tile, 2x4 fewer long fissure and random pinhole, Loc:1037, Girls' Chan	None Detected	45% Cellulose 35% Mineral Wool	10% Perlite 10% Other	White Fibrous Homogeneous
51814301PLM_5					Ashed, Dissolved
0014C	Lay-in ceiling tile, 2x4 fewer long fissure and random pinhole, Loc:1039, Kitchen	None Detected	45% Cellulose 35% Mineral Wool	10% Perlite 10% Other	White Fibrous Homogeneous
51814301PLM_6					Ashed, Dissolved

Disclaimer: Due to the nature of the EPA 600 method, asbestos may not be detected in samples containing low levels of asbestos. We strongly recommend that analysis of floor tiles, vermiculite, and/or heterogeneous soil samples be conducted by TEM for confirmation of "None Detected" by PLM. This report relates only to the samples tested and may not be reproduced, except in full, without the written approval of SAL. This report may not be used by the client to claim product endorsement by NVLAP or any other agency of the U.S. government. Analytical uncertainty available upon request. Scientific Analytical Institute participates in the NVLAP Proficiency Testing program. Unless otherwise noted blank sample correction was not performed. Estimated MDL is 0.1%.

Philip Szabo (6)

Analyst

Approved Signatory

Client: Contact: Address: Phone: Fax: Email:	Pinchin Ltd. Leslie Cantar 6-875 Main St W, Hamilton, ON 289-237-4294 905-577-6207 lcantar@pinchin.com ; sholmquist@pinchin.com	*Instructions: Use Column "B" for your contact info To See an Example Click the bottom Example Tab.	51814301
Project: Client Notes: P.O. #: Date Submitted: Analysis: TurnAroundTime:	Blessed Sacrament Stop positive on all samples. Perform gravimetric reduction on third vinyl floor tile if first two are ND. 315 E 37th St, Hamilton, ON 224334 06-07-2018 PLM BULK EPA 600 24 Hours	Begin Samples with a "<<" above the first sample and end with a ">>" below the last sample. Only Enter your data on the first sheet "Sheet1" Note: Data 1 and Data 2 are optional fields that do not show up on the official report, however they will be included in the electronic data returned to you to facilitate your reintegration of the report data.	

Sample Number	Data 1 (Lab use only)	Sample Description	Data 2 (Lab use only)
<<			
0013A		Pipe insulation, Sweatwrap, Loc:1006,Lower Corridor	
0013B		Pipe insulation, Sweatwrap, Loc:1006,Lower Corridor	
0013C		Pipe insulation, Sweatwrap, Loc:1006,Lower Corridor	
0014A		Lay-in ceiling tile, 2x4 fewer long fissure and random pinhole, Loc:1037, Girls' Change Room	
0014B		Lay-in ceiling tile, 2x4 fewer long fissure and random pinhole, Loc:1037, Girls' Change Room	
0014C		Lay-in ceiling tile, 2x4 fewer long fissure and random pinhole, Loc:1039, Kitchen	
>>			

Accepted ☒

Rejected ☐

Shelton 6/8 1030A



Bulk Asbestos Analysis

By Polarized Light Microscopy
EPA Method: 600/R-93/116 and 40 CFR, Part 763, Subpart E,
App.E



Customer: Pinchin Ltd.
6-875 Main St West
Suite 200
Hamilton, Ontario L8S 4P9

Attn: Emily Balfour
Michael Maiorana

Project: 230748,315 E 37th St, Hamilton, Ontario,Hamilton-Wentworth Catholic School
Board,Blessed Sacrament Elementary School

Lab Order ID: 71918648
Analysis ID: 71918648_PLM
Date Received: 7/16/2019
Date Reported: 7/18/2019

Sample ID	Description	Asbestos	Fibrous Components	Non-Fibrous Components	Attributes
Lab Sample ID	Lab Notes				Treatment
S0015A - A	Textured Plaster on Ceiling, Classroom, Location 1015	None Detected		100% Other	White Non Fibrous Heterogeneous
71918648PLM_1	texture				Crushed
S0015A - B	Textured Plaster on Ceiling, Classroom, Location 1015	None Detected		100% Other	Gray Non Fibrous Heterogeneous
71918648PLM_11	base				Crushed
S0015B - A	Textured Plaster on Ceiling, Classroom, Location 1016	None Detected		100% Other	White Non Fibrous Heterogeneous
71918648PLM_2	texture				Crushed
S0015B - B	Textured Plaster on Ceiling, Classroom, Location 1016	None Detected		100% Other	Gray Non Fibrous Heterogeneous
71918648PLM_12	base				Crushed
S0015C - A	Textured Plaster on Ceiling, Classroom, Location 1017	None Detected		100% Other	White Non Fibrous Heterogeneous
71918648PLM_3	texture				Crushed
S0015C - B	Textured Plaster on Ceiling, Classroom, Location 1017	None Detected		100% Other	Gray Non Fibrous Heterogeneous
71918648PLM_13	base				Crushed
S0015D - A	Textured Plaster on Ceiling, Classroom, Location 1013	None Detected		100% Other	White Non Fibrous Heterogeneous
71918648PLM_4	texture				Crushed
S0015D - B	Textured Plaster on Ceiling, Classroom, Location 1013	None Detected		100% Other	Gray Non Fibrous Heterogeneous
71918648PLM_14	base				Crushed

Disclaimer: Due to the nature of the EPA 600 method, asbestos may not be detected in samples containing low levels of asbestos. We strongly recommend that analysis of floor tiles, vermiculite, and/or heterogeneous soil samples be conducted by TEM for confirmation of "None Detected" by PLM. This report relates only to the samples tested and may not be reproduced, except in full, without the written approval of SAL. This report may not be used by the client to claim product endorsement by NVLAP or any other agency of the U.S. government. Analytical uncertainty available upon request. Scientific Analytical Institute participates in the NVLAP Proficiency Testing program. Unless otherwise noted blank sample correction was not performed. Estimated MDL is 0.1%.

Heather Davide (20)

Analyst

Approved Signatory



Bulk Asbestos Analysis

By Polarized Light Microscopy
EPA Method: 600/R-93/116 and 40 CFR, Part 763, Subpart E,
App.E



Customer: Pinchin Ltd.
6-875 Main St West
Suite 200
Hamilton, Ontario L8S 4P9

Attn: Emily Balfour
Michael Maiorana

Project: 230748,315 E 37th St, Hamilton, Ontario, Hamilton-Wentworth Catholic School
Board, Blessed Sacrament Elementary School

Lab Order ID: 71918648
Analysis ID: 71918648_PLM
Date Received: 7/16/2019
Date Reported: 7/18/2019

Sample ID	Description	Asbestos	Fibrous Components	Non-Fibrous Components	Attributes
Lab Sample ID	Lab Notes				Treatment
S0015E - A	Textured Plaster on Ceiling, Classroom, Location 1021	None Detected		100% Other	White Non Fibrous Heterogeneous
71918648PLM_5	texture				Crushed
S0015E - B	Textured Plaster on Ceiling, Classroom, Location 1021	None Detected		100% Other	Gray Non Fibrous Heterogeneous
71918648PLM_15	base				Crushed
S0015F - A	Textured Plaster on Ceiling, Classroom, Location 1014	None Detected		100% Other	White Non Fibrous Heterogeneous
71918648PLM_6	texture				Crushed
S0015F - B	Textured Plaster on Ceiling, Classroom, Location 1014	None Detected		100% Other	Gray Non Fibrous Heterogeneous
71918648PLM_16	base				Crushed
S0015G - A	Textured Plaster on Ceiling, Classroom, Location 1011	None Detected		100% Other	White Non Fibrous Heterogeneous
71918648PLM_7	texture				Crushed
S0015G - B	Textured Plaster on Ceiling, Classroom, Location 1011	None Detected		100% Other	Gray Non Fibrous Heterogeneous
71918648PLM_17	base				Crushed
S0016A - A	Texture Coat on Ceiling, Kindergarten, Location 1042	15% Chrysotile		65% Other 20% Perlite	White Non Fibrous Heterogeneous
71918648PLM_8	texture				Teased, Crushed
S0016A - B	Texture Coat on Ceiling, Kindergarten, Location 1042	None Detected		100% Other	Gray Non Fibrous Heterogeneous
71918648PLM_18	base				Crushed

Disclaimer: Due to the nature of the EPA 600 method, asbestos may not be detected in samples containing low levels of asbestos. We strongly recommend that analysis of floor tiles, vermiculite, and/or heterogeneous soil samples be conducted by TEM for confirmation of "None Detected" by PLM. This report relates only to the samples tested and may not be reproduced, except in full, without the written approval of SAL. This report may not be used by the client to claim product endorsement by NVLAP or any other agency of the U.S. government. Analytical uncertainty available upon request. Scientific Analytical Institute participates in the NVLAP Proficiency Testing program. Unless otherwise noted blank sample correction was not performed. Estimated MDL is 0.1%.

Heather Davide (20)

Analyst

Approved Signatory



Bulk Asbestos Analysis

By Polarized Light Microscopy
EPA Method: 600/R-93/116 and 40 CFR, Part 763, Subpart E,
App.E



Customer: Pinchin Ltd.
6-875 Main St West
Suite 200
Hamilton, Ontario L8S 4P9

Attn: Emily Balfour
Michael Maiorana

Lab Order ID: 71918648
Analysis ID: 71918648_PLM
Date Received: 7/16/2019
Date Reported: 7/18/2019

Project: 230748,315 E 37th St, Hamilton, Ontario, Hamilton-Wentworth Catholic School Board, Blessed Sacrament Elementary School

Sample ID	Description	Asbestos	Fibrous Components	Non-Fibrous Components	Attributes
Lab Sample ID	Lab Notes				Treatment
S0016B - A	Texture Coat on Ceiling, Kindergarten, Location 1042	Not Analyzed			
71918648PLM_9	texture				
S0016B - B	Texture Coat on Ceiling, Kindergarten, Location 1042	None Detected		100% Other	Gray Non Fibrous Heterogeneous
71918648PLM_19	base				Crushed
S0016C - A	Texture Coat on Ceiling, Kindergarten, Location 1042	Not Analyzed			
71918648PLM_10	texture				
S0016C - B	Texture Coat on Ceiling, Kindergarten, Location 1042	None Detected		100% Other	Gray Non Fibrous Heterogeneous
71918648PLM_20	base				Crushed

Disclaimer: Due to the nature of the EPA 600 method, asbestos may not be detected in samples containing low levels of asbestos. We strongly recommend that analysis of floor tiles, vermiculite, and/or heterogeneous soil samples be conducted by TEM for confirmation of "None Detected" by PLM. This report relates only to the samples tested and may not be reproduced, except in full, without the written approval of SAI. This report may not be used by the client to claim product endorsement by NVLAP or any other agency of the U.S. government. Analytical uncertainty available upon request. Scientific Analytical Institute participates in the NVLAP Proficiency Testing program. Unless otherwise noted blank sample correction was not performed. Estimated MDL is 0.1%.

Heather Davide (20)

Analyst

Approved Signatory

7/19/18048

Version 1-15-2012

Client: Contact: Address: Phone: Fax: Email: Project: Client Notes: P.O. #. Date Submitted: Analysis: TurnAroundTime:	Pinchin Ltd. Emily Balfour 6-875 Main Street West, Suite 200, Hamilton ON L8S 4P9 905-577-6206 905-577-6207 ebalfour@pinchin.com mmaiorana@pinchin.com 230748,315 E 37th St, Hamilton, Ontario,Hamilton-Wentworth Catholic School Board,Blessed Sacrament Elementary School 230748 July 15,2015 PLM - Stop Positive 4days	<p align="center">*Instructions:</p> <p align="center"><i>Use Column "B" for your contact info</i></p> <p align="center"><i>To See an Example Click the bottom Example Tab.</i></p> <p align="center">Enter samples between "<<" and ">>"</p> <p align="center">Begin Samples with a "<<" above the first sample and end with a ">>" below the last sample. Only Enter your data on the first sheet "Sheet1"</p> <p align="center"><i>Note: Data 1 and Data 2 are optional fields that do not show up on the official report, however they will be included in the electronic data returned to you to facilitate your reintegration of the report data.</i></p>	<p align="center">Invoice to:</p> <p align="center">ap@pinchin.com</p> <div align="center">  <p>Scientific Analytical Institute</p> </div> <p align="center">4604 Dundas Dr. Greensboro, NC 27407 Phone: 336.292.3888 Fax: 336.292.3313 Email: lab@sailab.com</p>
--	--	--	---

Sample Number	Data 1 (Lab use only)	Sample Description	Data 2 (Lab use only)
<<			
S0015A		Textured Plaster on Ceiling, Classroom, Location 1015	
S0015B		Textured Plaster on Ceiling, Classroom, Location 1016	
S0015C		Textured Plaster on Ceiling, Classroom, Location 1017	
S0015D		Textured Plaster on Ceiling, Classroom, Location 1013	
S0015E		Textured Plaster on Ceiling, Classroom, Location 1021	
S0015F		Textured Plaster on Ceiling, Classroom, Location 1014	
S0015G		Textured Plaster on Ceiling, Classroom, Location 1011	
S0016A		Texture Coat on Ceiling, Kindergarten, Location 1042	
S0016B		Texture Coat on Ceiling, Kindergarten, Location 1042	
S0016C		Texture Coat on Ceiling, Kindergarten, Location 1042	
>>			

*By Bulley
7/16/11 30R*

Accepted ☒

Rejected ☐

APPENDIX II
Location List

Client: Hamilton-Wentworth Catholic District Sch
 Building Name: Blessed Sacrament School
 Survey Date: 2018-06-06

Site: 315 E 37th Street, Hamilton, ON
 Last Re-Assessment: 2022-05-11

Location No.	Name or Description	Area ft ²	Floor No.	Bldg. Phase	Notes
1	Presumed Asbestos-containing Materials	0	1	A	
1001	Boiler Room	0	1	A	
1002	Storage	0	1	A	
1003	Library	0	1	A	
1004	Staff Room	0	1	A	
1005	Corridor	0	1	A	
1006	Corridor	0	1	A	
1007	Corridor Gym	0	1	A	
1008	Corridor	0	1	A	
1009	Office	0	1	A	
1010	Principals Office	0	1	A	
1011	Classroom, room no. 1	0	1	A	
1012	Classroom, room no. 2	0	1	A	
1013	Classroom, room no. 3	0	1	A	
1014	Classroom, room no. 4	0	1	A	
1015	Classroom, room no. 5	0	1	A	
1016	Classroom, room no. 6	0	1	A	
1017	Classroom, room no. 7	0	1	A	
1018	Classroom, room no. 8	0	1	A	
1019	Classroom, room no. 9	0	1	A	
1020	Classroom, room no. 10	0	1	A	
1021	Computer Lab	0	1	A	
1022	Conference Room	0	1	A	
1023	Spec. ED	0	1	A	
1024	Office	0	1	A	
1025	Classroom, room no. 12	0	1	A	
1026	Classroom, room no. 5	0	1	A	
1027	Storage	0	1	A	
1028	Girls Washroom	0	1	A	
1029	Boys Washroom	0	1	A	
1030	Language Arts	0	1	A	
1031	Language Arts Bathroom	0	1	A	
1032	Custodian Office/ Washroom	0	1	A	
1033	Boys Washroom	0	1	A	
1034	Kindergarten	0	1	A	
1035	Kindergarten	0	1	A	
1036	Storage	0	1	A	
1037	Girls Washroom	0	1	A	
1038	Gymnasium	0	1	A	
1039	Kitchen	0	1	A	
1041	Boys Change Room	0	1	A	
1042	Kindergarten	0	1	A	
1043	Stairwell	0	1	A	
1044	Custodian	0	1	A	
1045	Library Washroom	0	1	A	
1046	Staff Washroom	0	1	A	
1047	Staff Washroom	0	1	A	
1048	Elevator Mechanical Room	0	1	A	Formerly girl's washroom
1049	Janitors Closet	0	1	A	
1050	Janitors Closet	0	1	A	
1051	Custodian Closet	0	1	A	
2001	Child Care Centre, room no. 18	0	2	A	Renovated in 2018 - includes Locations 2002-2013
2002	Classroom, room no. 19	0	2	A	NO ACCESS - Amalgamated into Location 2001
2003	Hallway	0	2	A	NO ACCESS - Amalgamated into Location 2001
2004	Classroom, room no. 16	0	2	A	NO ACCESS - Amalgamated into Location 2001
2005	Classroom	0	2	A	NO ACCESS - Amalgamated into Location 2001
2006	Boys Washroom	0	2	A	NO ACCESS - Amalgamated into Location 2001
2007	Classroom, room no. 16	0	2	A	NO ACCESS - Amalgamated into Location 2001
2008	Classroom, room no. 17	0	2	A	NO ACCESS - Amalgamated into Location 2001
2009	Girls Washroom	0	2	A	NO ACCESS - Amalgamated into Location 2001
2010	Math Room	0	2	A	NO ACCESS - Amalgamated into Location 2001
2011	Custodian	0	2	A	NO ACCESS - Amalgamated into Location 2001

Location No.	Name or Description	Area ft ²	Floor No.	Bldg. Phase	Notes
2012	Storage	0	2	A	NO ACCESS - Amalgamated into Location 2001
2013	Book Storage	0	2	A	NO ACCESS - Amalgamated into Location 2001

APPENDIX III

Hazardous Materials Summary / Sample Log Report

Client: Hamilton-Wentworth Catholic District Sch

Site: 315 E 37th Street, Hamilton, ON

Building Name: Blessed Sacrament School

Survey Date: 2018-06-06

HAZMAT	Sample No	System/Component/Material/Sample Description	Locations	Bldg. Phase	LF	SF	EA	%	Type	Positive	Friability
Asbestos	V0001	Ceiling Acoustic Tile Ceiling Tiles (lay-in) 2'x4' Long Fissures And Random Pinholes	1002,1003,1006,1022,1032,1035,1036,1037,1039	A	0	30	0	100	None Detected	No	
Asbestos	S0002	Piping Aircell Aircell Pipe Insulation Aircell Pipe Insulation	1002,1004,1005,1006,1008,1015,1016,1017,1018 1020,1046,1050,1051	A	513	0	0	100	Chrysotile	Yes	F
Asbestos	S0003	Piping All Parging Cement Parging Cement Fitting Parging Cement Fitting	1002,1005,1006,1007,1008,1013,1023,1028,1036 1038,1039,1044,1048	A	0	0	148	0	Chrysotile	Yes	F
Asbestos	V0004	Ceiling Drywall Compound On Ceiling (listed As Plaster In Mte Report)	1045	A	0	0	0	100	None Detected	No	
Asbestos	S0005	Ceiling, Wall, Ceiling, Wall Bulkhead Plaster	1002,1006,1025,1026,1028,1029,1030,1031,1032 1033,1034,1035,1037,1042,1044,1045,1046,1047 1048,1050,1051,2001	A	0	265	0	100	None Detected	No	
Asbestos	S0006	Ceiling, Wall Texture Coat Hard Texture Coat, 2014 PI-01	1,1005	A	0	0	0	100	None Detected	No	
Asbestos	S0007	Ceiling Texture Coat	1,1012	A	0	0	0	100	None Detected	No	
Asbestos	S0010	Ceiling Plaster Plaster Sample PI-05 (2014) Plaster Sample PI-05 (2014)	1010	A	0	0	0	100	None Detected	No	
Asbestos	S0011	Ceiling Texture Coat Soft Plaster/ Texture Coat/ Stucco Sampled For Mte 1228036, 2012	1	A	0	0	0	0	None Detected	No	
Asbestos	S0013	Piping Rain Water Leader Sweatwrap	1006,1026	A	40	0	0	0	None Detected	No	
Asbestos	S0014	Ceiling Acoustic Tile Ceiling Tiles (lay-in) 2'x4' Fewer Fissures 2'x4' Fewer Long Fissure And Random Fissure	1022,1023,1024,1030,1036,1037,1039,1041,1048	A	0	64	0	100	None Detected	No	
Asbestos	S0015 ABCDEFG	Ceiling Bulkhead Plaster	1009,1011,1013,1014,1015,1016,1017,1018,1019 1020,1021	A	0	0	0	100	None Detected	No	
Asbestos	S0016 ABC	Ceiling Plaster	1042	A	0	0	0	100	Chrysotile	Yes	PF
Asbestos	V9000	Floor Mastic (hwcdsb Sample Agat 18h397049)	1038	A	0	0	0	0	Confirmed Asbestos	Yes	NF
Asbestos	V9000	Other Door Caulking Perimeter - Agat#16h147314	1	A	0	0	0	100	Confirmed Asbestos	Yes	NF
Asbestos	V9000	Piping Aircell	1014	A	20	0	0	0	Confirmed Asbestos	Yes	F
Asbestos	V9000	Piping Parging Cement	1016,1029	A	0	0	14	0	Confirmed Asbestos	Yes	F
Asbestos	V9500	Ceiling Acoustic Tile Ceiling Tiles (lay-in) 2' X 4' Pinhole And Right-angled Fissures	1041	A	0	0	2	0	Presumed Asbestos	Yes	PF
Asbestos	V9500	Ceiling Acoustic Tile Cement Product 2'x2' Perforated Transite, 2'x2' Ceiling Tiles, 2'x2' Perforated Transite	1002,1003,1005,1008,1028,1049	A	0	8490	6	0	Presumed Asbestos	Yes	NF
Asbestos	V9500	Floor Mastic Floor Tile Mastic, Underneath New Tiles, Vinyl Floor Tile Mastic	1006,1008,1009,1010,1011,1012,1013,1014,1015 1016,1017,1018,1019,1021,1025,1032,1034,1035	A	0	0	0	100	Presumed Asbestos	Yes	NF

HAZMAT	Sample No	System/Component/Material/Sample Description	Locations	Bldg. Phase	LF	SF	EA	%	Type	Positive	Friability
			2001								
Asbestos	V9500	Floor All Vinyl Floor Tile And Mastic 12"x12" Beige With Light Fleck, 12"x12" Beige With Pale Marbling, 12"x12" Brown With White Streaks, 12"x12" Light Brown With Light/dark Streaks, 12"x12" Light Grey Streaks, 12"x12" Pink And White, 12"x12" White With Black Streaks	1002,1022,1023,1024,1026,1030,1031,1036,1037 1039,1041,1042,1044,1046,1047	A	0	0	0	100	Presumed Asbestos	Yes	NF
Asbestos	V9500	Other Window Caulking Perimeter - Agat#16h147314	1	A	0	0	0	100	Presumed Asbestos	Yes	NF
Asbestos	V9500	Other Electrical Equipment Cement Product	1	A	0	0	0	100	Presumed Asbestos	Yes	NF
Asbestos	V9500	Other Sink Mastic, Gold	1039	A	0	0	2	0	Presumed Asbestos	Yes	NF
Asbestos	V9500	Other Roof Roofing Material	1	A	0	0	0	100	Presumed Asbestos	Yes	NF
Asbestos	V9500	Other Electrical Equipment Textile	1	A	0	0	0	100	Presumed Asbestos	Yes	NF
Asbestos	V9500	Piping Aircell Presumed Present Above Ceiling/in Concealed Areas	1047	A	0	0	0	100	Presumed Asbestos	Yes	F
Asbestos	V9500	Wall Acoustic Tile Cement Product 2'x2' Perforated	1038	A	0	0	0	100	Presumed Asbestos	Yes	NF
Asbestos	V9500	Wall Firestopping (cementitious) Parging Cement At Outer Perimeter Hatch Penetration Through Wall	1001	A	6	0	0	0	Presumed Asbestos	Yes	F
Asbestos	V9500	Wall Vermiculite Presumed Within Cavities	1	A	0	0	0	100	Presumed Asbestos	Yes	F
Asbestos	V0000	Ceiling Acoustic Tile Ceiling Tiles (lay-in)	1031	A	0	0	0	100	Non Asbestos	No	
Asbestos	V0000	Ceiling Acoustic Tile Ceiling Tiles (lay-in) 2'x2' Short Fissure Random Pinhole (2012)	1006	A	0	0	0	100	Non Asbestos	No	
Asbestos	V0000	Ceiling Ceiling Tiles (lay-in) 2'x4' Short Fissure Random Pinhole	1005,1007	A	0	0	0	100	Non Asbestos	No	
Asbestos	V0000	Ceiling Acoustic Tile Ceiling Tiles (lay-in) 2'x4' Short Fissure Random Pinhole (2013)	1004	A	0	0	0	100	Non Asbestos	No	
Asbestos	V0000	Ceiling Acoustic Tile Ceiling Tiles (lay-in) 2'x4' Short Fissure Random Pinhole (2014 Stamp)	1045	A	0	20	0	0	Non Asbestos	No	
Asbestos	V0000	Ceiling Acoustic Tile Ceiling Tiles (lay-in) 2'x4' Short Fissure With Random Pinhole	1008	A	0	0	0	100	Non Asbestos	No	
Asbestos	V0000	Ceiling Acoustic Tile Ceiling Tiles (lay-in) 2013	1010,1015,1016,1020,1043	A	0	0	0	100	Non Asbestos	No	
Asbestos	V0000	Ceiling Acoustic Tile Ceiling Tiles (lay-in) 2x4 Pinhole And Crescent Fleck (installed	2001	A	0	0	0	100	Non Asbestos	No	

HAZMAT	Sample No	System/Component/Material/Sample Description	Locations	Bldg. Phase	LF	SF	EA	%	Type	Positive	Friability
		2018)									
Asbestos	V0000	Ceiling Ceiling Tiles (lay-in) Appear To Be Fibreglass From Below, No Access Due To Contents	1041	A	0	10	0	0	Non Asbestos	No	
Asbestos	V0000	Ceiling Bulkhead Drywall And Joint Compound New	1034	A	0	0	0	100	Non Asbestos	No	
Asbestos	V0000	Ceiling Drywall And Joint Compound New	2001	A	0	0	0	0	Non Asbestos	No	
Asbestos	V0000	Ceiling Plaster	1029	A	0	0	0	100	Non Asbestos	No	
Asbestos	V0000	Floor Mastic (hwcdsb Sample Agat 19h455603)	1020	A	0	0	0	100	Non Asbestos	No	
Asbestos	V0000	Floor Vinyl Floor Tile 12"x12" Grey Dense Fleck (2016 Install)	1010,1013,1014,1015,1016,1017	A	0	0	0	100	Non Asbestos	No	
Asbestos	V0000	Floor Vinyl Floor Tile 12"x12" Grey Dense Fleck (installed 2016)	1009	A	0	0	0	100	Non Asbestos	No	
Asbestos	V0000	Floor Vinyl Floor Tile 12"x12" Grey Oatmeal	1008	A	0	0	0	100	Non Asbestos	No	
Asbestos	V0000	Floor Vinyl Floor Tile (no Mastic) 12"x12" Grey Dense Fleck (2016 Install)	1011,1012,1018,1019,1020,1021,1025	A	0	0	0	100	Non Asbestos	No	
Asbestos	V0000	Floor Vinyl Floor Tile (no Mastic) 12"x12" Grey With White (2014 Install)	1006	A	0	0	0	100	Non Asbestos	No	
Asbestos	V0000	Floor Vinyl Floor Tile (no Mastic) 12"x12" White Beige Marble (install Date)	1032,1034,1035	A	0	0	0	100	Non Asbestos	No	
Asbestos	V0000	Floor Vinyl Floor Tile (no Mastic) 12x12 Grey With Dark Grey And White Fleck	2001	A	0	0	0	0	Non Asbestos	No	
Asbestos	V0000	Wall Drywall And Joint Compound	1004	A	0	0	0	100	Non Asbestos	No	
Asbestos	V0000	Wall Masonry	1	A	0	0	0	0	Non Asbestos	No	

Legend:

Sample number		Units			
S####	Asbestos sample collected	SF	Square feet	NF	Non Friable material.
L####	Paint sample collected	LF	Linear feet	F	Friable material
P####	PCB sample collected	EA	Each	PF	Potentially Friable material
M####	Mould sample collected	%	Percentage		
V####	Material visually similar to numbered sample collected				
V0000	Known non Hazardous Material				
V9000	Material is visually identified as Hazardous Material				
V9500	Material is presumed to be Hazardous Material				
[Loc. No.]	Abated Material				

APPENDIX IV
All Data Report

ALL DATA REPORT

Client: Hamilton-Wentworth Catholic District Sch
Location: #1 : Presumed Asbestos-containing Materials
Survey Date: 2018-06-06

Site: Elementary
Floor: 1

Building Name: Blessed Sacrament School
Room #:
Last Re-Assessment: 2022-05-11

Area (sqft): 0

ASBESTOS																
System	Component	Material	Item	Covering	A*	V*	AP*	Good	Fair	Poor	Unit	Sample	Asbestos Type	Amount	Hazard	Friable
Ceiling ¹		Texture Coat, Soft plaster/ texture coat/ stucco sampled for MTE 1228036, 2012										S0011	None Detected		None	
Ceiling ²		Texture Coat, Soft texture, Paracel ID 1228036-1, July 9, 2012.			C	Y		100			%	S0007	None Detected	N.D.	None	
Ceiling ³		Texture Coat, Hard texture coat, 2014 PL-01			C	Y		100			%	S0006	None Detected		None	
Other	Door	Caulking, Perimeter - agat#16h147314			A	Y		100(7)			%	V9000	Confirmed Asbestos		Confirmed Asbestos	NF
Other	Electrical Equipment	Cement Product			B	Y		100(7)			%	V9500	Presumed Asbestos		Presumed Asbestos	NF
Other	Electrical Equipment	Textile			B	Y		100(7)			%	V9500	Presumed Asbestos		Presumed Asbestos	NF
Other	Roof	Roofing material			B	Y		100(7)			%	V9500	Presumed Asbestos		Presumed Asbestos	NF
Other	Window	Caulking, Perimeter - agat#16h147314			A	Y		100(7)			%	V9500	Presumed Asbestos		Presumed Asbestos	NF
Wall		Masonry			A	Y						V0000	Non-Asbestos		None	
Wall ⁴		Vermiculite, Presumed within cavities			D	N		100(7)			%	V9500	Presumed Asbestos		Presumed Asbestos	F

- 1 - Location unknown
- 2 - Location unknown.
- 3 - Sampling location unknown.
- 4 - Concrete block walls

ALL DATA REPORT

Client: Hamilton-Wentworth Catholic District Sch
Location: #1001 : Boiler Room
Survey Date: 2018-06-06

Site: Elementary
Floor: 1

Building Name: Blessed Sacrament School
Room #:
Last Re-Assessment: 2022-05-11

Area (sqft): 0

ASBESTOS																
System	Component	Material	Item	Covering	A*	V*	AP*	Good	Fair	Poor	Unit	Sample	Asbestos Type	Amount	Hazard	Friable
Floor		Concrete (poured)			B	Y										
Piping		Fibreglass		Polyvinyl chloride (PVC)	C	Y										
Piping		Fibreglass	Fitting	Polyvinyl chloride (PVC)	C	Y										
Structure	Deck	Steel			C	Y										
Structure	Deck	Concrete (poured)			C	Y										
Wall		Masonry			B	Y										
Wall		Firestopping (Cementitious), Parging cement at outer perimeter hatch penetration through wall			B	Y		6(7)			LF	V9500	Presumed Asbestos		Presumed Asbestos	F

Client: Hamilton-Wentworth Catholic District Sch
Location: #1002 : Storage
Survey Date: 2018-06-06

Site: Elementary
Floor: 1

Building Name: Blessed Sacrament School
Room #:
Last Re-Assessment: 2022-05-11

Area (sqft): 0

ASBESTOS																
System	Component	Material	Item	Covering	A*	V*	AP*	Good	Fair	Poor	Unit	Sample	Asbestos Type	Amount	Hazard	Friable
Ceiling	Acoustic Tile	Ceiling Tiles (lay-in), 2'x4' long fissure random pinhole			C	Y		100			%	V0001	None Detected		None	
Ceiling	Acoustic Tile	Cement Product, 2'x2' perforated Transite			C	N		350(7)			SF	V9500	Presumed Asbestos		Presumed Asbestos	NF
Floor	All	Vinyl Floor Tile and Mastic, 12"x12" light grey streaks			A	Y		100(7)			%	V9500	Presumed Asbestos		Presumed Asbestos	NF
Piping		Aircell			B	Y		60(7)			LF	V0002	Chrysotile	50-75%	Confirmed Asbestos	F
Piping	All	Fibreglass			B	Y										
Piping ¹	All	Parging Cement	Fitting		C	Y		19(7)			EA	V0003	Chrysotile	50-75%	Confirmed Asbestos	F
Wall		Plaster			B	Y		200			SF	V0005	None Detected		None	
Wall	All	Masonry			A	Y										

1 - At side stairs

ALL DATA REPORT

Client: Hamilton-Wentworth Catholic District Sch
Location: #1003 : Library
Survey Date: 2018-06-06

Site: Elementary
Floor: 1

Building Name: Blessed Sacrament School
Room #:
Last Re-Assessment: 2022-05-11

Area (sqft): 0

ASBESTOS																
System	Component	Material	Item	Covering	A*	V*	AP*	Good	Fair	Poor	Unit	Sample	Asbestos Type	Amount	Hazard	Friable
Ceiling	Acoustic Tile	Ceiling Tiles (lay-in), 2'x4' long fissure random pinhole			C	Y		100			%	V0001	None Detected		None	
Ceiling	Acoustic Tile	Cement Product, 2'x2' perforated Transite			C	Y		2100(7)			SF	V9500	Presumed Asbestos		Presumed Asbestos	NF
Floor		Wood			A	Y										
Wall		Masonry			A	Y										

Client: Hamilton-Wentworth Catholic District Sch
Location: #1004 : Staff Room
Survey Date: 2018-06-06

Site: Elementary
Floor: 1

Building Name: Blessed Sacrament School
Room #:
Last Re-Assessment: 2022-05-11

Area (sqft): 0

ASBESTOS																
System	Component	Material	Item	Covering	A*	V*	AP*	Good	Fair	Poor	Unit	Sample	Asbestos Type	Amount	Hazard	Friable
Ceiling	Acoustic Tile	Ceiling Tiles (lay-in), 2'x4' short fissure random pinhole (2013)			C	Y		100			%	V0000	Non-Asbestos		None	
Floor ¹		Wood			A	Y										
Piping		Fibreglass			C	Y										
Piping		Fibreglass	Fitting		C	Y										
Piping ²		Aircell			A	Y		30(5)			LF	V0002	Chrysotile	50-75%	Confirmed Asbestos	F
Wall		Wood			A	Y										
Wall		Drywall and joint compound			A	Y		100			%	V0000	Non-Asbestos		None	

1 - Laminate

2 - In corridor near washroom

ALL DATA REPORT

Client: Hamilton-Wentworth Catholic District Sch
Location: #1005 : Corridor
Survey Date: 2018-06-06

Site: Elementary
Floor: 1

Building Name: Blessed Sacrament School
Room #:
Last Re-Assessment: 2022-05-11

Area (sqft): 0

ASBESTOS																
System	Component	Material	Item	Covering	A*	V*	AP*	Good	Fair	Poor	Unit	Sample	Asbestos Type	Amount	Hazard	Friable
Ceiling		Ceiling Tiles (lay-in), 2'x4' short fissure random pinhole			C	Y		100			%	V0000	Non-Asbestos		None	
Ceiling	Acoustic Tile	Cement Product, 2'x2' ceiling tiles			C	Y		3000(7)			SF	V9500	Presumed Asbestos		Presumed Asbestos	NF
Floor		Terrazzo			A	Y		100			%					
Piping		Parging Cement	Fitting		C	N		28(7)			EA	V0003	Chrysotile	50-75%	Confirmed Asbestos	F
Piping		Aircell	ALL		C	N		80(7)			LF	V0002	Chrysotile	50-75%	Confirmed Asbestos	F
Piping		Aircell	Fitting		C	N		10(7)			LF	V0002	Chrysotile	50-75%	Confirmed Asbestos	F
Wall		Plaster			A	Y		100			%	V0006	None Detected		None	

Client: Hamilton-Wentworth Catholic District Sch
Location: #1006 : Corridor
Survey Date: 2018-06-06

Site: Elementary
Floor: 1

Building Name: Blessed Sacrament School
Room #:
Last Re-Assessment: 2022-05-11

Area (sqft): 0

ASBESTOS																
System	Component	Material	Item	Covering	A*	V*	AP*	Good	Fair	Poor	Unit	Sample	Asbestos Type	Amount	Hazard	Friable
Ceiling	Acoustic Tile	Ceiling Tiles (lay-in), 2'x2' short fissure random pinhole (2012)			C	Y		100			%	V0000	Non-Asbestos		None	
Ceiling	Acoustic Tile	Ceiling Tiles (lay-in), 2'x4' long fissure random pinhole			C	Y		100			%	V0001	None Detected		None	
Floor		Mastic, Floor tile mastic			D	N		100(7)			%	V9500	Presumed Asbestos		Presumed Asbestos	NF
Floor		Vinyl Floor Tile (No Mastic), 12"x12" grey with white (2014 install)			A	Y		100			%	V0000	Non-Asbestos		None	
Piping		Fibreglass	All Pipe		C	N		100			%					
Piping		Fibreglass	Fitting		C	N		100			%					
Piping		Parging Cement			C	N		12(7)			EA	V0003	Chrysotile	50-75%	Confirmed Asbestos	F
Piping		Aircell			C	N		10(7)			LF	V0002	Chrysotile	50-75%	Confirmed Asbestos	F
Piping	Rain Water Leader	Sweatwrap			C	N		20			LF	S0013	None Detected		None	
Wall		Plaster			A	Y		100			%	V0005	None Detected		None	
Wall		Masonry			A	Y					%					

ALL DATA REPORT

Client: Hamilton-Wentworth Catholic District Sch
Location: #1007 : Corridor Gym
Survey Date: 2018-06-06

Site: Elementary
Floor: 1

Building Name: Blessed Sacrament School
Room #:
Last Re-Assessment: 2022-05-11

Area (sqft): 0

ASBESTOS																
System	Component	Material	Item	Covering	A*	V*	AP*	Good	Fair	Poor	Unit	Sample	Asbestos Type	Amount	Hazard	Friable
Ceiling		Ceiling Tiles (lay-in), 2'x4' short fissure random pinhole			C	Y		100			%	V0000	Non-Asbestos		None	
Floor		Terrazzo			A	Y		100			%					
Piping		Parging Cement	Fitting		C	N		40(7)			EA	V0003	Chrysotile	50-75%	Confirmed Asbestos	F
Wall		Masonry			A	Y										

Client: Hamilton-Wentworth Catholic District Sch
Location: #1008 : Corridor
Survey Date: 2018-06-06

Site: Elementary
Floor: 1

Building Name: Blessed Sacrament School
Room #:
Last Re-Assessment: 2022-05-11

Area (sqft): 0

ASBESTOS																
System	Component	Material	Item	Covering	A*	V*	AP*	Good	Fair	Poor	Unit	Sample	Asbestos Type	Amount	Hazard	Friable
Ceiling	Acoustic Tile	Ceiling Tiles (lay-in), 2'x4' short fissure with random pinhole			C	Y		100			%	V0000	Non-Asbestos		None	
Ceiling	Acoustic Tile	Cement Product, 2'x2' ceiling tiles			C	N		3000(7)			SF	V9500	Presumed Asbestos		Presumed Asbestos	NF
Floor		Vinyl Floor Tile and Mastic, 9"x9" beige with green streaks			A	Y		100			%	V9500	[None]		[Abated]	
Floor		Vinyl Floor Tile and Mastic, 9"x9" green with white streaks			A	Y		100			%	V9500	[None]		[Abated]	
Floor		Mastic			D	N		100(7)			%	V9500	Presumed Asbestos		Presumed Asbestos	NF
Floor		Vinyl Floor Tile, 12"x12" grey oatmeal			A	Y		100			%	V0000	Non-Asbestos		None	
Piping		Parging Cement	Fitting		C	N		16(7)			EA	S0003	Chrysotile	50-75%	Confirmed Asbestos	F
Piping		Aircell	Straight		C	N		248(7)			LF	S0002	Chrysotile	50-75%	Confirmed Asbestos	F
Wall		Masonry			A	Y		100			%					

ALL DATA REPORT

Client: Hamilton-Wentworth Catholic District Sch
Location: #1009 : Office
Survey Date: 2018-06-06

Site: Elementary
Floor: 1

Building Name: Blessed Sacrament School
Room #:
Last Re-Assessment: 2022-05-11

Area (sqft): 0

ASBESTOS																
System	Component	Material	Item	Covering	A*	V*	AP*	Good	Fair	Poor	Unit	Sample	Asbestos Type	Amount	Hazard	Friable
Ceiling		Plaster, Textured			C	Y						V0015	None Detected	N.D.	None	
Floor		Mastic			D	N		100(7)			%	V9500	Presumed Asbestos		Presumed Asbestos	NF
Floor		Vinyl Floor Tile, 12"x12" grey dense fleck (installed 2016)			A	Y		100			%	V0000	Non-Asbestos		None	
Wall		Masonry			A	Y										
Wall ¹		Drywall (no compound)			A	Y										

1 - No drywall joint compound

Client: Hamilton-Wentworth Catholic District Sch
Location: #1010 : Principals Office
Survey Date: 2018-06-06

Site: Elementary
Floor: 1

Building Name: Blessed Sacrament School
Room #:
Last Re-Assessment: 2022-05-11

Area (sqft): 0

ASBESTOS																
System	Component	Material	Item	Covering	A*	V*	AP*	Good	Fair	Poor	Unit	Sample	Asbestos Type	Amount	Hazard	Friable
Ceiling		Ceiling Tiles (lay-in), 2013			C	Y		100			%	V0000	Non-Asbestos		None	
Ceiling		Plaster, Plaster sample PL-05 (2014)			C	Y		100			%	S0010	None Detected		None	
Floor		Mastic			D	N		100(7)			%	V9500	Presumed Asbestos		Presumed Asbestos	NF
Floor		Vinyl Floor Tile, 12"x12" grey dense fleck (2016 install)			A	Y		100			%	V0000	Non-Asbestos		None	
Wall		Masonry			A	Y										
Wall ¹		Drywall (no compound)			A	Y										

1 - No drywall joint compound

ALL DATA REPORT

Client: Hamilton-Wentworth Catholic District Sch
Location: #1011 : Classroom
Survey Date: 2018-06-06

Site: Elementary
Floor: 1

Building Name: Blessed Sacrament School
Room #: 1
Last Re-Assessment: 2022-05-11

Area (sqft): 0

ASBESTOS																
System	Component	Material	Item	Covering	A*	V*	AP*	Good	Fair	Poor	Unit	Sample	Asbestos Type	Amount	Hazard	Friable
Ceiling		Plaster, Textured			C	Y		100			%	S0015G	None Detected	N.D.	None	
Floor		Mastic			D	N		100(7)			%	V9500	Presumed Asbestos		Presumed Asbestos	NF
Floor		Vinyl Floor Tile (No Mastic), 12"x12" grey dense fleck (2016 install)			A	Y		100			%	V0000	Non-Asbestos		None	
Wall		Masonry			A	Y										

Client: Hamilton-Wentworth Catholic District Sch
Location: #1012 : Classroom
Survey Date: 2018-06-06

Site: Elementary
Floor: 1

Building Name: Blessed Sacrament School
Room #: 2
Last Re-Assessment: 2022-05-11

Area (sqft): 0

ASBESTOS																
System	Component	Material	Item	Covering	A*	V*	AP*	Good	Fair	Poor	Unit	Sample	Asbestos Type	Amount	Hazard	Friable
Ceiling		Plaster, PL-03 (2014)			C	Y		100			%	V0007	None Detected	N.D.	None	
Floor		Mastic			D	N		100(7)			%	V9500	Presumed Asbestos		Presumed Asbestos	NF
Floor		Vinyl Floor Tile (No Mastic), 12"x12" grey dense fleck (2016 install)			A	Y		100			%	V0000	Non-Asbestos		None	
Piping		Fibreglass		Polyvinyl chloride (PVC)	C	Y										
Piping		Not Insulated			C	Y										
Wall		Masonry			A	Y										

ALL DATA REPORT

Client: Hamilton-Wentworth Catholic District Sch
Location: #1013 : Classroom
Survey Date: 2018-06-06

Site: Elementary
Floor: 1

Building Name: Blessed Sacrament School
Room #: 3
Last Re-Assessment: 2022-05-11

Area (sqft): 0

ASBESTOS																
System	Component	Material	Item	Covering	A*	V*	AP*	Good	Fair	Poor	Unit	Sample	Asbestos Type	Amount	Hazard	Friable
Ceiling		Plaster, Textured			C	Y		100			%	S0015D	None Detected	N.D.	None	
Floor		Mastic			D	N		100(7)			%	V9500	Presumed Asbestos		Presumed Asbestos	NF
Floor		Vinyl Floor Tile, 12"x12" grey dense fleck (2016 install)			A	Y		100			%	V0000	Non-Asbestos		None	
Piping		Fibreglass			C	Y										
Piping		Parging Cement	Fitting		B	Y		1(7)			EA	V0003	Chrysotile	50-75%	Confirmed Asbestos	F
Wall		Masonry			A	Y										

Client: Hamilton-Wentworth Catholic District Sch
Location: #1014 : Classroom
Survey Date: 2018-06-06

Site: Elementary
Floor: 1

Building Name: Blessed Sacrament School
Room #: 4
Last Re-Assessment: 2022-05-11

Area (sqft): 0

ASBESTOS																
System	Component	Material	Item	Covering	A*	V*	AP*	Good	Fair	Poor	Unit	Sample	Asbestos Type	Amount	Hazard	Friable
Ceiling		Plaster, Textured			C	Y		100			%	S0015F	None Detected	N.D.	None	
Floor		Mastic			D	N		100(7)			%	V9500	Presumed Asbestos		Presumed Asbestos	NF
Floor		Vinyl Floor Tile, 12"x12" grey dense fleck (2016 install)			A	Y		100			%	V0000	Non-Asbestos		None	
Piping		Aircell			B	Y		20(7)			LF	V9000	Confirmed Asbestos		Confirmed Asbestos	F
Wall		Masonry			A	Y										

ALL DATA REPORT

Client: Hamilton-Wentworth Catholic District Sch
Location: #1015 : Classroom
Survey Date: 2018-06-06

Site: Elementary
Floor: 1

Building Name: Blessed Sacrament School
Room #: 5
Last Re-Assessment: 2022-05-11

Area (sqft): 0

ASBESTOS																
System	Component	Material	Item	Covering	A*	V*	AP*	Good	Fair	Poor	Unit	Sample	Asbestos Type	Amount	Hazard	Friable
Ceiling		Ceiling Tiles (lay-in), 2013			C	Y		100			%	V0000	Non-Asbestos		None	
Ceiling		Plaster, Textured			C	Y		100			%	S0015A	None Detected	N.D.	None	
Ceiling	Bulkhead	Plaster, Textured			C	Y		100			%	V0015	None Detected	N.D.	None	
Floor		Vinyl Floor Tile and Mastic, 9"x9" beige with green streaks			A	Y		100			%	V9500	[None]		[Abated]	
Floor		Vinyl Floor Tile and Mastic, 9"x9" green with white streaks			A	Y		100			%	V9500	[None]		[Abated]	
Floor		Mastic			D	N		100(7)			%	V9500	Presumed Asbestos		Presumed Asbestos	NF
Floor		Vinyl Floor Tile, 12"x12" grey dense fleck (2016 install)			A	Y						V0000	Non-Asbestos		None	
Piping		Aircell, Presumed in bulkhead			C	N		100(7)			%	V0002	Chrysotile	50-75%	Confirmed Asbestos	F
Wall		Masonry			A	Y										

ALL DATA REPORT

Client: Hamilton-Wentworth Catholic District Sch
Location: #1016 : Classroom
Survey Date: 2018-06-06

Site: Elementary
Floor: 1

Building Name: Blessed Sacrament School
Room #: 6
Last Re-Assessment: 2022-05-11

Area (sqft): 0

ASBESTOS																
System	Component	Material	Item	Covering	A*	V*	AP*	Good	Fair	Poor	Unit	Sample	Asbestos Type	Amount	Hazard	Friable
Ceiling		Plaster, Textured			C	N		100			%	S0015B	None Detected	N.D.	None	
Ceiling	Acoustic Tile	Ceiling Tiles (lay-in), 2013			C	Y						V0000	Non-Asbestos		None	
Ceiling	Bulkhead	Texture Coat			C	Y		100			%	V0015	None Detected	N.D.	None	
Floor		Mastic			D	N		100(7)			%	V9500	Presumed Asbestos		Presumed Asbestos	NF
Floor		Vinyl Floor Tile, 12"x12" grey dense fleck (2016 install)			A	Y						V0000	Non-Asbestos		None	
Piping		Parging Cement	Fitting		C	N		1(7)			EA	V9000	Confirmed Asbestos		Confirmed Asbestos	F
Piping ¹		Aircell			C	N		8(7)			LF	V0002	Chrysotile	50-75%	Confirmed Asbestos	F
Wall		Masonry			A	Y										

1 - In bulkhead

ALL DATA REPORT

Client: Hamilton-Wentworth Catholic District Sch
Location: #1017 : Classroom
Survey Date: 2018-06-06

Site: Elementary
Floor: 1

Building Name: Blessed Sacrament School
Room #: 7
Last Re-Assessment: 2022-05-11

Area (sqft): 0

ASBESTOS																
System	Component	Material	Item	Covering	A*	V*	AP*	Good	Fair	Poor	Unit	Sample	Asbestos Type	Amount	Hazard	Friable
Ceiling		Plaster, Textured			C	Y		100			%	S0015C	None Detected	N.D.	None	
Ceiling	Bulkhead	Plaster, Textured			C	Y		100			%	V0015	None Detected	N.D.	None	
Floor		Mastic			D	N		100(7)			%	V9500	Presumed Asbestos		Presumed Asbestos	NF
Floor		Vinyl Floor Tile, 12"x12" grey dense fleck (2016 install)			A	Y		100			%	V0000	Non-Asbestos		None	
Piping ¹		Aircell			C	N		6(7)			LF	V0002	Chrysotile	50-75%	Confirmed Asbestos	F
Wall		Masonry			A	Y										

1 - In bulkhead

Client: Hamilton-Wentworth Catholic District Sch
Location: #1018 : Classroom
Survey Date: 2018-06-06

Site: Elementary
Floor: 1

Building Name: Blessed Sacrament School
Room #: 8
Last Re-Assessment: 2022-05-11

Area (sqft): 0

ASBESTOS																
System	Component	Material	Item	Covering	A*	V*	AP*	Good	Fair	Poor	Unit	Sample	Asbestos Type	Amount	Hazard	Friable
Ceiling		Plaster, Textured			C	Y		100			%	V0015	None Detected	N.D.	None	
Floor		Mastic			D	N		100(7)			%	V9500	Presumed Asbestos		Presumed Asbestos	NF
Floor		Vinyl Floor Tile (No Mastic), 12"x12" grey dense fleck (2016 install)			A	Y		100			%	V0000	Non-Asbestos		None	
Piping		Fibreglass		Polyvinyl chloride (PVC)	C	Y										
Piping		Aircell			C	N		6(7)			LF	V0002	Chrysotile	50-75%	Confirmed Asbestos	F
Wall		Masonry			A	Y										

ALL DATA REPORT

Client: Hamilton-Wentworth Catholic District Sch
Location: #1019 : Classroom
Survey Date: 2018-06-06

Site: Elementary
Floor: 1

Building Name: Blessed Sacrament School
Room #: 9
Last Re-Assessment: 2022-05-11

Area (sqft): 0

ASBESTOS																
System	Component	Material	Item	Covering	A*	V*	AP*	Good	Fair	Poor	Unit	Sample	Asbestos Type	Amount	Hazard	Friable
Ceiling		Plaster, Textured			C	Y		100			%	V0015	None Detected	N.D.	None	
Ceiling	Bulkhead	Plaster, Textured			C	Y		100			%	V0015	None Detected	N.D.	None	
Floor		Mastic			D	N		100(7)			%	V9500	Presumed Asbestos		Presumed Asbestos	NF
Floor		Vinyl Floor Tile (No Mastic), 12"x12" grey dense fleck (2016 install)			A	Y		100			%	V0000	Non-Asbestos		None	
Wall		Masonry			A	Y										

Client: Hamilton-Wentworth Catholic District Sch
Location: #1020 : Classroom
Survey Date: 2018-06-06

Site: Elementary
Floor: 1

Building Name: Blessed Sacrament School
Room #: 10
Last Re-Assessment: 2022-05-11

Area (sqft): 0

ASBESTOS																
System	Component	Material	Item	Covering	A*	V*	AP*	Good	Fair	Poor	Unit	Sample	Asbestos Type	Amount	Hazard	Friable
Ceiling		Ceiling Tiles (lay-in), 2013										V0000	Non-Asbestos		None	
Ceiling		Plaster, Textured			C	Y		100			%	V0015	None Detected	N.D.	None	
Ceiling	Bulkhead	Plaster, Textured			C	Y		100			%	V0015	None Detected	N.D.	None	
Floor		Mastic, (HWCDSD sample AGAT 19H455603)			D	N		100			%	V0000	Non-Asbestos		None	
Floor		Vinyl Floor Tile (No Mastic), 12"x12" grey dense fleck (2016 install)			A	Y		100			%	V0000	Non-Asbestos		None	
Piping ¹		Aircell			C	N		10(7)			LF	V0002	Chrysotile	50-75%	Confirmed Asbestos	F
Wall		Masonry			A	Y										
Wall		Masonry			A	Y										

1 - In bulkhead

ALL DATA REPORT

Client: Hamilton-Wentworth Catholic District Sch
Location: #1021 : Computer Lab
Survey Date: 2018-06-06

Site: Elementary
Floor: 1

Building Name: Blessed Sacrament School
Room #:
Last Re-Assessment: 2022-05-11

Area (sqft): 0

ASBESTOS																
System	Component	Material	Item	Covering	A*	V*	AP*	Good	Fair	Poor	Unit	Sample	Asbestos Type	Amount	Hazard	Friable
Ceiling		Plaster, Textured			C	Y		100			%	S0015E	None Detected	N.D.	None	
Ceiling	Bulkhead	Plaster, Textured			C	Y		100			%	V0015	None Detected	N.D.	None	
Floor		Mastic			D	N		100(7)			%	V9500	Presumed Asbestos		Presumed Asbestos	NF
Floor		Vinyl Floor Tile (No Mastic), 12"x12" grey dense fleck (2016 install)			A	Y		100			%	V0000	Non-Asbestos		None	
Wall		Masonry			A	Y										

Client: Hamilton-Wentworth Catholic District Sch
Location: #1022 : Conference Room
Survey Date: 2018-06-06

Site: Elementary
Floor: 1

Building Name: Blessed Sacrament School
Room #:
Last Re-Assessment: 2022-05-11

Area (sqft): 0

ASBESTOS																
System	Component	Material	Item	Covering	A*	V*	AP*	Good	Fair	Poor	Unit	Sample	Asbestos Type	Amount	Hazard	Friable
Ceiling		Ceiling Tiles (lay-in), 2'x4' long fissure with random pinhole			C	Y		100			%	V0001	None Detected		None	
Ceiling		Ceiling Tiles (lay-in), 2'x4' long fissure with random pinhole			C	Y		100			%	V0014	None Detected		None	
Floor		Vinyl Floor Tile and Mastic, 12"x12" pink and white			A	Y		100(7)			%	V9500	Presumed Asbestos		Presumed Asbestos	NF
Piping		Fibreglass		Polyvinyl chloride (PVC)	C	N										
Wall		Masonry			A	Y										
Wall ¹		Drywall (no compound)			A	Y										

1 - No drywall joint compound

ALL DATA REPORT

Client: Hamilton-Wentworth Catholic District Sch
Location: #1023 : Spec. ED
Survey Date: 2018-06-06

Site: Elementary
Floor: 1

Building Name: Blessed Sacrament School
Room #:
Last Re-Assessment: 2022-05-11

Area (sqft): 0

ASBESTOS																
System	Component	Material	Item	Covering	A*	V*	AP*	Good	Fair	Poor	Unit	Sample	Asbestos Type	Amount	Hazard	Friable
Ceiling		Ceiling Tiles (lay-in), 2'x4' long fissure with random pinhole			C	Y		100			%	V0014	None Detected		None	
Floor		Vinyl Floor Tile and Mastic, 12"x12" pink and white			A	Y		100(7)			%	V9500	Presumed Asbestos		Presumed Asbestos	NF
Piping		Fibreglass		Polyvinyl chloride (PVC)	C	N										
Piping		Parging Cement	Fitting		C	N		6(7)			EA	V0003	Chrysotile	50-75%	Confirmed Asbestos	F
Wall		Masonry			A	Y										
Wall ¹		Drywall (no compound)			A	Y										

1 - No drywall joint compound

Client: Hamilton-Wentworth Catholic District Sch
Location: #1024 : Office
Survey Date: 2018-06-06

Site: Elementary
Floor: 1

Building Name: Blessed Sacrament School
Room #:
Last Re-Assessment: 2022-05-11

Area (sqft): 0

ASBESTOS																
System	Component	Material	Item	Covering	A*	V*	AP*	Good	Fair	Poor	Unit	Sample	Asbestos Type	Amount	Hazard	Friable
Ceiling	Acoustic Tile	Ceiling Tiles (lay-in), 2'x4' long fissure with random pinhole			C	Y		100			%	V0014	None Detected		None	
Floor		Vinyl Floor Tile and Mastic, 12"x12" pink and white			A	Y		100(7)			%	V9500	Presumed Asbestos		Presumed Asbestos	NF
Wall		Masonry			A	Y										
Wall ¹		Drywall (no compound)			A	Y										

1 - No drywall joint compound

ALL DATA REPORT

Client: Hamilton-Wentworth Catholic District Sch
Location: #1025 : Classroom
Survey Date: 2018-06-06

Site: Elementary
Floor: 1

Building Name: Blessed Sacrament School
Room #: 12
Last Re-Assessment: 2022-05-11

Area (sqft): 0

ASBESTOS																
System	Component	Material	Item	Covering	A*	V*	AP*	Good	Fair	Poor	Unit	Sample	Asbestos Type	Amount	Hazard	Friable
Ceiling		Plaster			C	Y		100			%	V0005	None Detected		None	
Ceiling	Bulkhead	Plaster			C	Y		100			%	V0005	None Detected		None	
Floor		Mastic, Vinyl floor tile mastic			D	N		100(7)			%	V9500	Presumed Asbestos		Presumed Asbestos	NF
Floor		Vinyl Floor Tile (No Mastic), 12"x12" grey dense fleck (2016 install)			A	Y		100			%	V0000	Non-Asbestos		None	
Piping		Aircell														
Wall		Masonry			A	Y										

Client: Hamilton-Wentworth Catholic District Sch
Location: #1026 : Classroom
Survey Date: 2018-06-06

Site: Elementary
Floor: 1

Building Name: Blessed Sacrament School
Room #: 5
Last Re-Assessment: 2022-05-11

Area (sqft): 0

ASBESTOS																
System	Component	Material	Item	Covering	A*	V*	AP*	Good	Fair	Poor	Unit	Sample	Asbestos Type	Amount	Hazard	Friable
Ceiling		Plaster			C	Y		100			%	V0005	None Detected		None	
Ceiling	Bulkhead	Plaster			C	Y		100			%	V0005	None Detected		None	
Floor		Vinyl Floor Tile and Mastic, 9"x9" turquoise with black and white streaks			D	N		100			%	V9500	[None]		[Abated]	
Floor		Vinyl Floor Tile and Mastic, 9"x9" grey with white streaks			D	N		100			%	V9500	[None]		[Abated]	
Floor		Vinyl Floor Tile and Mastic			A	Y		100(7)			%	V9500	Presumed Asbestos		Presumed Asbestos	NF
Piping ¹					C	N		20			LF	V0013	None Detected		None	
Wall		Masonry			A	Y										

1 - Bulkhead

ALL DATA REPORT

Client: Hamilton-Wentworth Catholic District Sch
Location: #1027 : Storage
Survey Date: 2018-06-06

Site: Elementary
Floor: 1

Building Name: Blessed Sacrament School
Room #:
Last Re-Assessment: 2022-05-11

Area (sqft): 0

ASBESTOS																
System	Component	Material	Item	Covering	A*	V*	AP*	Good	Fair	Poor	Unit	Sample	Asbestos Type	Amount	Hazard	Friable
Floor		Vinyl Floor Tile and Mastic, 9x9 brown with brown and white streaks										V9500	[None]		[Abated]	
Floor		Terrazzo														
Piping		Fibreglass			B	Y										

Client: Hamilton-Wentworth Catholic District Sch
Location: #1028 : Girls Washroom
Survey Date: 2018-06-06

Site: Elementary
Floor: 1

Building Name: Blessed Sacrament School
Room #:
Last Re-Assessment: 2022-05-11

Area (sqft): 0

ASBESTOS																
System	Component	Material	Item	Covering	A*	V*	AP*	Good	Fair	Poor	Unit	Sample	Asbestos Type	Amount	Hazard	Friable
Ceiling		Plaster			C	Y		100			%	V0005	None Detected		None	
Ceiling	Acoustic Tile	Cement Product, 2'x2' perforated Transite			C	Y		6(7)			EA	V9500	Presumed Asbestos		Presumed Asbestos	NF
Floor		Terrazzo			A	Y										
Piping		Fibreglass			C	N										
Piping		Parging Cement	Fitting		C	Y		2(7)			EA	V0003	Chrysotile	50-75%	Confirmed Asbestos	F
Wall		Plaster			C	Y		100			%	S0005	None Detected		None	

ALL DATA REPORT

Client: Hamilton-Wentworth Catholic District Sch
Location: #1029 : Boys Washroom
Survey Date: 2018-06-06

Site: Elementary
Floor: 1

Building Name: Blessed Sacrament School
Room #:
Last Re-Assessment: 2022-05-11

Area (sqft): 0

ASBESTOS																
System	Component	Material	Item	Covering	A*	V*	AP*	Good	Fair	Poor	Unit	Sample	Asbestos Type	Amount	Hazard	Friable
Ceiling		Plaster			C	Y		100			%	V0000	Non-Asbestos		None	
Floor		Ceramic Tiles			A	Y										
Floor		Terrazzo			A	Y										
Piping		Fibreglass		Polyvinyl chloride (PVC)	C	Y										
Piping		Parging Cement	Fitting		C	Y		13(7)			EA	V9000	Confirmed Asbestos		Confirmed Asbestos	F
Wall		Plaster		Ceramic Tiles	C	Y		100			%	V0005	None Detected		None	

Client: Hamilton-Wentworth Catholic District Sch
Location: #1030 : Language Arts
Survey Date: 2018-06-06

Site: Elementary
Floor: 1

Building Name: Blessed Sacrament School
Room #:
Last Re-Assessment: 2022-05-11

Area (sqft): 0

ASBESTOS																
System	Component	Material	Item	Covering	A*	V*	AP*	Good	Fair	Poor	Unit	Sample	Asbestos Type	Amount	Hazard	Friable
Ceiling		Plaster, Plaster ceiling			C	N		100			%	V0005	None Detected		None	
Ceiling	Acoustic Tile	Ceiling Tiles (lay-in)			C	Y		100			%	V0014	None Detected		None	
Floor		Vinyl Floor Tile and Mastic, 12"x12" light brown with light/dark streaks			A	Y		100(7)			%	V9500	Presumed Asbestos		Presumed Asbestos	NF
Piping		Fibreglass		Polyvinyl chloride (PVC)	C	N										
Wall		Plaster			A	Y		100			%	V0005	None Detected		None	

ALL DATA REPORT

Client: Hamilton-Wentworth Catholic District Sch
Location: #1031 : Language Arts Bathroom
Survey Date: 2018-06-06

Site: Elementary
Floor: 1

Building Name: Blessed Sacrament School
Room #:
Last Re-Assessment: 2022-05-11

Area (sqft): 0

ASBESTOS																
System	Component	Material	Item	Covering	A*	V*	AP*	Good	Fair	Poor	Unit	Sample	Asbestos Type	Amount	Hazard	Friable
Ceiling		Plaster, Plaster ceiling			C	N		100			%	V0005	None Detected		None	
Ceiling	Acoustic Tile	Ceiling Tiles (lay-in)			C	Y		100			%	V0000	Non-Asbestos		None	
Floor		Vinyl Floor Tile and Mastic, 12"x12" light brown with light/dark streaks			A	Y		100(7)			%	V9500	Presumed Asbestos		Presumed Asbestos	NF
Piping		Fibreglass		Polyvinyl chloride (PVC)	C	N										
Wall		Plaster			A	Y		100			%	V0005	None Detected		None	

Client: Hamilton-Wentworth Catholic District Sch
Location: #1032 : Custodian Office/ Washroom
Survey Date: 2018-06-06

Site: Elementary
Floor: 1

Building Name: Blessed Sacrament School
Room #:
Last Re-Assessment: 2022-05-11

Area (sqft): 0

ASBESTOS																
System	Component	Material	Item	Covering	A*	V*	AP*	Good	Fair	Poor	Unit	Sample	Asbestos Type	Amount	Hazard	Friable
Ceiling		Plaster			C	Y		100			%	S0005	None Detected		None	
Ceiling	Acoustic Tile	Ceiling Tiles (lay-in), 2'x4' fissure with random pinhole			C	Y		100			%	V0001	None Detected		None	
Floor		Terrazzo			B	Y										
Floor		Mastic, Floor tile mastic			D	N		100(7)			%	V9500	Presumed Asbestos		Presumed Asbestos	NF
Floor		Vinyl Floor Tile (No Mastic), 12"x12" white beige marble (install date)			B	Y		100			%	V0000	Non-Asbestos		None	
Wall		Plaster			B	Y		100			%	S0005	None Detected		None	
Wall		Masonry			B	Y										
Wall ¹		Drywall (no compound)			B	Y										

1 - No compound

ALL DATA REPORT

Client: Hamilton-Wentworth Catholic District Sch
Location: #1033 : Boys Washroom
Survey Date: 2018-06-06

Site: Elementary
Floor: 1

Building Name: Blessed Sacrament School
Room #:
Last Re-Assessment: 2022-05-11

Area (sqft): 0

ASBESTOS																
System	Component	Material	Item	Covering	A*	V*	AP*	Good	Fair	Poor	Unit	Sample	Asbestos Type	Amount	Hazard	Friable
Ceiling		Plaster			C	Y		100			%	S0005	None Detected		None	
Floor		Terrazzo			A	Y										
Wall		Masonry			A	Y										

Client: Hamilton-Wentworth Catholic District Sch
Location: #1034 : Kindergarten
Survey Date: 2018-06-06

Site: Elementary
Floor: 1

Building Name: Blessed Sacrament School
Room #:
Last Re-Assessment: 2022-05-11

Area (sqft): 0

ASBESTOS																
System	Component	Material	Item	Covering	A*	V*	AP*	Good	Fair	Poor	Unit	Sample	Asbestos Type	Amount	Hazard	Friable
Ceiling		Plaster			C	Y						V0005	None Detected		None	
Ceiling	Bulkhead	Drywall and joint compound, New			C	Y		100			%	V0000	Non-Asbestos		None	
Floor		Mastic, Floor tile mastic			D	N		100(7)			%	V9500	Presumed Asbestos		Presumed Asbestos	NF
Floor		Vinyl Floor Tile (No Mastic), 12"x12" white beige marble (install date)			B	Y		100			%	V0000	Non-Asbestos		None	
Wall		Masonry			B	Y										

ALL DATA REPORT

Client: Hamilton-Wentworth Catholic District Sch
Location: #1035 : Kindergarten
Survey Date: 2018-06-06

Site: Elementary
Floor: 1

Building Name: Blessed Sacrament School
Room #:
Last Re-Assessment: 2022-05-11

Area (sqft): 0

ASBESTOS																
System	Component	Material	Item	Covering	A*	V*	AP*	Good	Fair	Poor	Unit	Sample	Asbestos Type	Amount	Hazard	Friable
Ceiling		Ceiling Tiles (lay-in)			C	Y		30			SF	V0001	None Detected		None	
Ceiling		Plaster			C	Y						V0005	None Detected		None	
Floor		Ceramic Tiles			A	Y										
Floor		Mastic, Floor tile mastic			D	N		100(7)			%	V9500	Presumed Asbestos		Presumed Asbestos	NF
Floor		Vinyl Floor Tile (No Mastic), 12"x12" white beige marble (install date)			A	Y		100			%	V0000	Non-Asbestos		None	
Wall		Masonry			A	Y										

Client: Hamilton-Wentworth Catholic District Sch
Location: #1036 : Storage
Survey Date: 2018-06-06

Site: Elementary
Floor: 1

Building Name: Blessed Sacrament School
Room #:
Last Re-Assessment: 2022-05-11

Area (sqft): 0

ASBESTOS																
System	Component	Material	Item	Covering	A*	V*	AP*	Good	Fair	Poor	Unit	Sample	Asbestos Type	Amount	Hazard	Friable
Ceiling	Acoustic Tile	Ceiling Tiles (lay-in)			C	Y		100			%	V0001	None Detected		None	
Ceiling	Acoustic Tile	Ceiling Tiles (lay-in)			C	Y		100			%	V0014	None Detected		None	
Floor		Vinyl Floor Tile and Mastic, 12"x12" light brown with light/dark streaks			A	Y		100(7)			%	V9500	Presumed Asbestos		Presumed Asbestos	NF
Piping		Fibreglass		Polyvinyl chloride (PVC)	C	N										
Piping		Parging Cement	Fitting		C	N		1(7)			EA	V0003	Chrysotile	50-75%	Confirmed Asbestos	F
Wall		Masonry			A	Y										

ALL DATA REPORT

Client: Hamilton-Wentworth Catholic District Sch
Location: #1037 : Girls Washroom
Survey Date: 2018-06-06

Site: Elementary
Floor: 1

Building Name: Blessed Sacrament School
Room #:
Last Re-Assessment: 2022-05-11

Area (sqft): 0

ASBESTOS																
System	Component	Material	Item	Covering	A*	V*	AP*	Good	Fair	Poor	Unit	Sample	Asbestos Type	Amount	Hazard	Friable
Ceiling	Acoustic Tile	Ceiling Tiles (lay-in), 1999 date stamp			C	Y		100			%	V0001	None Detected		None	
Ceiling	Acoustic Tile	Ceiling Tiles (lay-in), 2'x4' fewer long fissure and random fissure			C	Y		100			%	S0014	None Detected		None	
Floor		Vinyl Floor Tile and Mastic, 12"x12" white with black streaks			A	Y		100(7)			%	V9500	Presumed Asbestos		Presumed Asbestos	NF
Floor		Terrazzo			A	Y										
Wall		Plaster			A	Y		100			%	S0005	None Detected		None	
Wall		Masonry			A	Y										

Client: Hamilton-Wentworth Catholic District Sch
Location: #1038 : Gymnasium
Survey Date: 2018-06-06

Site: Elementary
Floor: 1

Building Name: Blessed Sacrament School
Room #:
Last Re-Assessment: 2022-05-11

Area (sqft): 0

ASBESTOS																
System	Component	Material	Item	Covering	A*	V*	AP*	Good	Fair	Poor	Unit	Sample	Asbestos Type	Amount	Hazard	Friable
Floor		Mastic, (HWCDDB sample AGAT 18H397049)			A	Y						V9000	Confirmed Asbestos		Confirmed Asbestos	NF
Piping		Fibreglass		Polyvinyl chloride (PVC)	C	N										
Piping		Parging Cement	Fitting		C	Y		5(7)			EA	V0003	Chrysotile	50-75%	Confirmed Asbestos	F
Structure		Concrete (poured)			C	Y										
Wall		Masonry			A	Y										
Wall	Acoustic Tile	Cement Product, 2'x2' Perforated			C	Y		100(7)			%	V9500	Presumed Asbestos		Presumed Asbestos	NF

ALL DATA REPORT

Client: Hamilton-Wentworth Catholic District Sch
Location: #1039 : Kitchen
Survey Date: 2018-06-06

Site: Elementary
Floor: 1

Building Name: Blessed Sacrament School
Room #:
Last Re-Assessment: 2022-05-11

Area (sqft): 0

ASBESTOS																
System	Component	Material	Item	Covering	A*	V*	AP*	Good	Fair	Poor	Unit	Sample	Asbestos Type	Amount	Hazard	Friable
Ceiling	Acoustic Tile	Ceiling Tiles (lay-in), 2'x4' fewer fissures			C	Y		40			SF	S0014	None Detected		None	
Ceiling	Acoustic Tile	Ceiling Tiles (lay-in)			C	Y		100			%	V0001	None Detected		None	
Floor		Vinyl Floor Tile and Mastic, 12"x12" light brown with light/dark streaks			A	Y		100(7)			%	V9500	Presumed Asbestos		Presumed Asbestos	NF
Other	Sink	Mastic, Gold			A	Y		2(7)			EA	V9500	Presumed Asbestos		Presumed Asbestos	NF
Piping		Fibreglass		Polyvinyl chloride (PVC)	C	N										
Piping		Parging Cement	Fitting		C	N		3(7)			EA	V0003	Chrysotile	50-75%	Confirmed Asbestos	F
Wall		Masonry			A	Y										

Client: Hamilton-Wentworth Catholic District Sch
Location: #1041 : Boys Change Room
Survey Date: 2018-06-06

Site: Elementary
Floor: 1

Building Name: Blessed Sacrament School
Room #:
Last Re-Assessment: 2022-05-11

Area (sqft): 0

ASBESTOS																
System	Component	Material	Item	Covering	A*	V*	AP*	Good	Fair	Poor	Unit	Sample	Asbestos Type	Amount	Hazard	Friable
Ceiling		Ceiling Tiles (lay-in), Appear to be fibreglass from below, no access due to contents			C	Y		10			SF	V0000	Non-Asbestos		None	
Ceiling		Ceiling Tiles (lay-in)			C	Y		24			SF	V0014	None Detected		None	
Ceiling ¹	Acoustic Tile	Ceiling Tiles (lay-in), 2' x 4' pinhole and right-angled fissures			C	Y		2(7)			EA	V9500	Presumed Asbestos		Presumed Asbestos	PF
Floor		Vinyl Floor Tile and Mastic, 12"x12" brown with white streaks			A	Y		100(7)			%	V9500	Presumed Asbestos		Presumed Asbestos	NF
Floor		Terrazzo			A	Y										
Wall		Masonry			A	Y										

1 - Inaccessible for sampling due to stored contents (desks)

ALL DATA REPORT

Client: Hamilton-Wentworth Catholic District Sch
Location: #1042 : Kindergarten
Survey Date: 2018-06-06

Site: Elementary
Floor: 1

Building Name: Blessed Sacrament School
Room #:
Last Re-Assessment: 2022-05-11

Area (sqft): 0

ASBESTOS																
System	Component	Material	Item	Covering	A*	V*	AP*	Good	Fair	Poor	Unit	Sample	Asbestos Type	Amount	Hazard	Friable
Ceiling		Plaster, Textured			C	Y		33(7)			%	S0016ABC	Chrysotile	10-25%	Confirmed Asbestos	PF
Floor		Vinyl Floor Tile and Mastic, 12"x12" beige with light fleck			A	Y		100(7)			%	V9500	Presumed Asbestos		Presumed Asbestos	NF
Wall		Plaster			A	Y		100			%	V0005	None Detected		None	
Wall		Masonry			A	Y										

Client: Hamilton-Wentworth Catholic District Sch
Location: #1043 : Stairwell
Survey Date: 2018-06-06

Site: Elementary
Floor: 1

Building Name: Blessed Sacrament School
Room #:
Last Re-Assessment: 2022-05-11

Area (sqft): 0

ASBESTOS																
System	Component	Material	Item	Covering	A*	V*	AP*	Good	Fair	Poor	Unit	Sample	Asbestos Type	Amount	Hazard	Friable
Ceiling		Ceiling Tiles (lay-in), 2013			C	Y		100			%	V0000	Non-Asbestos		None	
Floor		Terrazzo			A	Y										

ALL DATA REPORT

Client: Hamilton-Wentworth Catholic District Sch
Location: #1044 : Custodian
Survey Date: 2018-06-06

Site: Elementary
Floor: 1

Building Name: Blessed Sacrament School
Room #:
Last Re-Assessment: 2022-05-11

Area (sqft): 0

ASBESTOS																
System	Component	Material	Item	Covering	A*	V*	AP*	Good	Fair	Poor	Unit	Sample	Asbestos Type	Amount	Hazard	Friable
Ceiling		Plaster			C	Y		100			%	S0005	None Detected		None	
Floor		Vinyl Floor Tile and Mastic, 12"x12" light brown with light/dark streaks			A	Y		100(7)			%	V9500	Presumed Asbestos		Presumed Asbestos	NF
Piping		Fibreglass		Polyvinyl chloride (PVC)	C	Y										
Piping		Parging Cement	Fitting		C	Y		5(7)			EA	V0003	Chrysotile	50-75%	Confirmed Asbestos	F
Wall		Masonry			A	Y										

Client: Hamilton-Wentworth Catholic District Sch
Location: #1045 : Library Washroom
Survey Date: 2018-06-06

Site: Elementary
Floor: 1

Building Name: Blessed Sacrament School
Room #:
Last Re-Assessment: 2022-05-11

Area (sqft): 0

ASBESTOS																
System	Component	Material	Item	Covering	A*	V*	AP*	Good	Fair	Poor	Unit	Sample	Asbestos Type	Amount	Hazard	Friable
Ceiling		Plaster			C	Y		100			%	V0005	None Detected		None	
Ceiling		Drywall Compound, Joint compound sampled as plaster (2013)			C	Y		100			%	V0004	None Detected		None	
Ceiling	Acoustic Tile	Ceiling Tiles (lay-in), 2'x4' short fissure random pinhole (2014 stamp)			C	Y		20			SF	V0000	Non-Asbestos		None	
Floor		Wood			A	Y										
Wall		Masonry			A	Y										

ALL DATA REPORT

Client: Hamilton-Wentworth Catholic District Sch
Location: #1046 : Staff Washroom
Survey Date: 2018-06-06

Site: Elementary
Floor: 1

Building Name: Blessed Sacrament School
Room #:
Last Re-Assessment: 2022-05-11

Area (sqft): 0

ASBESTOS																
System	Component	Material	Item	Covering	A*	V*	AP*	Good	Fair	Poor	Unit	Sample	Asbestos Type	Amount	Hazard	Friable
Ceiling		Plaster			C	Y		100			%	V0005	None Detected		None	
Floor		Vinyl Floor Tile and Mastic, 12"x12" beige with pale marbling			B	Y		100(7)			%	V9500	Presumed Asbestos		Presumed Asbestos	NF
Floor		Ceramic Tiles			A	Y										
Piping		Fibreglass		Polyvinyl chloride (PVC)	C	Y										
Piping		Aircell			D	N		100(7)			%	V0002	Chrysotile	50-75%	Confirmed Asbestos	F
Wall		Plaster			A	Y		100			%	S0005	None Detected		None	

Client: Hamilton-Wentworth Catholic District Sch
Location: #1047 : Staff Washroom
Survey Date: 2018-06-06

Site: Elementary
Floor: 1

Building Name: Blessed Sacrament School
Room #:
Last Re-Assessment: 2022-05-11

Area (sqft): 0

ASBESTOS																
System	Component	Material	Item	Covering	A*	V*	AP*	Good	Fair	Poor	Unit	Sample	Asbestos Type	Amount	Hazard	Friable
Ceiling		Plaster			C	Y		100			%	V0005	None Detected		None	
Floor		Vinyl Floor Tile and Mastic, 12"x12" beige with pale marbling			B	Y		100(7)			%	V9500	Presumed Asbestos		Presumed Asbestos	NF
Floor		Ceramic Tiles			A	Y										
Piping		Fibreglass		Polyvinyl chloride (PVC)	C	Y										
Piping		Aircell, Presumed present above ceiling/in concealed areas			D	N		100(7)			%	V9500	Presumed Asbestos		Presumed Asbestos	F
Wall		Plaster			A	Y		100			%	V0005	None Detected		None	

ALL DATA REPORT

Client: Hamilton-Wentworth Catholic District Sch
Location: #1048 : Elevator Mechanical Room
Survey Date: 2018-06-06

Site: Elementary
Floor: 1

Building Name: Blessed Sacrament School
Room #:
Last Re-Assessment: 2022-05-11

Area (sqft): 0

ASBESTOS																
System	Component	Material	Item	Covering	A*	V*	AP*	Good	Fair	Poor	Unit	Sample	Asbestos Type	Amount	Hazard	Friable
Ceiling	Acoustic Tile	Ceiling Tiles (lay-in)			C	Y		100			%	V0014	None Detected		None	
Floor		Terrazzo			A	Y										
Piping		Parging Cement	Fitting		C	N		10(7)			EA	V0003	Chrysotile	50-75%	Confirmed Asbestos	F
Wall		Plaster			C	Y		100			%	V0005	None Detected		None	
Wall		Masonry			A	Y										

Formerly girl's washroom

Client: Hamilton-Wentworth Catholic District Sch
Location: #1049 : Janitors Closet
Survey Date: 2018-06-06

Site: Elementary
Floor: 1

Building Name: Blessed Sacrament School
Room #:
Last Re-Assessment: 2022-05-11

Area (sqft): 0

ASBESTOS																
System	Component	Material	Item	Covering	A*	V*	AP*	Good	Fair	Poor	Unit	Sample	Asbestos Type	Amount	Hazard	Friable
Ceiling	Acoustic Tile	Cement Product, 2'x2' Perforated Transite			C	Y		40(7)			SF	V9500	Presumed Asbestos		Presumed Asbestos	NF
Floor		Vinyl Floor Tile and Mastic, 9"x9" beige streaks			A	Y		100			%	V9500	[None]		[Abated]	
Piping		Fibreglass		Polyvinyl chloride (PVC)	C	N										
Wall		Masonry			A	Y										

ALL DATA REPORT

Client: Hamilton-Wentworth Catholic District Sch
Location: #1050 : Janitors Closet
Survey Date: 2018-06-06

Site: Elementary
Floor: 1

Building Name: Blessed Sacrament School
Room #:
Last Re-Assessment: 2022-05-11

Area (sqft): 0

ASBESTOS																
System	Component	Material	Item	Covering	A*	V*	AP*	Good	Fair	Poor	Unit	Sample	Asbestos Type	Amount	Hazard	Friable
Ceiling		Plaster			C	Y		50			SF	V0005	None Detected		None	
Floor		Terrazzo			A	Y										
Piping		Aircell, Within bulkhead			C	N		30(7)			LF	V0002	Chrysotile	50-75%	Confirmed Asbestos	F
Wall		Masonry			A	Y										

Client: Hamilton-Wentworth Catholic District Sch
Location: #1051 : Custodian Closet
Survey Date: 2018-06-06

Site: Elementary
Floor: 1

Building Name: Blessed Sacrament School
Room #:
Last Re-Assessment: 2022-05-11

Area (sqft): 0

ASBESTOS																
System	Component	Material	Item	Covering	A*	V*	AP*	Good	Fair	Poor	Unit	Sample	Asbestos Type	Amount	Hazard	Friable
Ceiling		Plaster			C	Y		15			SF	V0005	None Detected		None	
Floor		Terrazzo			A	Y										
Piping		Aircell			B	Y		15(7)			LF	V0002	Chrysotile	50-75%	Confirmed Asbestos	F
Wall		Masonry			A	Y										

ALL DATA REPORT

Client: Hamilton-Wentworth Catholic District Sch
Location: #2001 : Child Care Centre
Survey Date: 2018-06-06

Site: Elementary
Floor: 2

Building Name: Blessed Sacrament School
Room #: 18
Last Re-Assessment: 2022-05-11

Area (sqft): 0

ASBESTOS																
System	Component	Material	Item	Covering	A*	V*	AP*	Good	Fair	Poor	Unit	Sample	Asbestos Type	Amount	Hazard	Friable
Ceiling		Drywall and joint compound, new			C	Y						V0000	Non-Asbestos		None	
Ceiling		Plaster			C	Y						V0005	None Detected		None	
Ceiling	Acoustic Tile	Ceiling Tiles (lay-in), 2x4 pinhole and crescent fleck (installed 2018)			C	Y		100			%	V0000	Non-Asbestos		None	
Ceiling	Bulkhead	Plaster			C	Y						V0005	None Detected		None	
Floor		Terrazzo			A	Y										
Floor		Mastic, Underneath new tiles			D	N		100(7)			%	V9500	Presumed Asbestos		Presumed Asbestos	NF
Floor		Vinyl Floor Tile (No Mastic), 12x12 grey with dark grey and white fleck			A	Y						V0000	Non-Asbestos		None	
Wall		Masonry, Concrete block			A	Y										

Renovated in 2018 - includes Locations 2002-2013

ALL DATA REPORT

Client: Hamilton-Wentworth Catholic District Sch
Location: #2002 : Classroom
Survey Date: 2018-06-06

Site: Elementary
Floor: 2

Building Name: Blessed Sacrament School
Room #: 19
Last Re-Assessment: 2022-05-11

Area (sqft): 0

ASBESTOS - NO ACCESS																
System	Component	Material	Item	Covering	A*	V*	AP*	Good	Fair	Poor	Unit	Sample	Asbestos Type	Amount	Hazard	Friable

Amalgamated into Location 2001

Client: Hamilton-Wentworth Catholic District Sch
Location: #2003 : Hallway
Survey Date: 2018-06-06

Site: Elementary
Floor: 2

Building Name: Blessed Sacrament School
Room #:
Last Re-Assessment: 2022-05-11

Area (sqft): 0

ASBESTOS - NO ACCESS																
System	Component	Material	Item	Covering	A*	V*	AP*	Good	Fair	Poor	Unit	Sample	Asbestos Type	Amount	Hazard	Friable

Amalgamated into Location 2001

ALL DATA REPORT

Client: Hamilton-Wentworth Catholic District Sch
Location: #2004 : Classroom
Survey Date: 2018-06-06

Site: Elementary
Floor: 2

Building Name: Blessed Sacrament School
Room #: 16
Last Re-Assessment: 2022-05-11

Area (sqft): 0

ASBESTOS - NO ACCESS																
System	Component	Material	Item	Covering	A*	V*	AP*	Good	Fair	Poor	Unit	Sample	Asbestos Type	Amount	Hazard	Friable

Amalgamated into Location 2001

Client: Hamilton-Wentworth Catholic District Sch
Location: #2005 : Classroom
Survey Date: 2018-06-06

Site: Elementary
Floor: 2

Building Name: Blessed Sacrament School
Room #:
Last Re-Assessment: 2022-05-11

Area (sqft): 0

ASBESTOS - NO ACCESS																
System	Component	Material	Item	Covering	A*	V*	AP*	Good	Fair	Poor	Unit	Sample	Asbestos Type	Amount	Hazard	Friable

Amalgamated into Location 2001

ALL DATA REPORT

Client: Hamilton-Wentworth Catholic District Sch
Location: #2006 : Boys Washroom
Survey Date: 2018-06-06

Site: Elementary
Floor: 2

Building Name: Blessed Sacrament School
Room #:
Last Re-Assessment: 2022-05-11

Area (sqft): 0

ASBESTOS - NO ACCESS																
System	Component	Material	Item	Covering	A*	V*	AP*	Good	Fair	Poor	Unit	Sample	Asbestos Type	Amount	Hazard	Friable

Amalgamated into Location 2001

Client: Hamilton-Wentworth Catholic District Sch
Location: #2007 : Classroom
Survey Date: 2018-06-06

Site: Elementary
Floor: 2

Building Name: Blessed Sacrament School
Room #: 16
Last Re-Assessment: 2022-05-11

Area (sqft): 0

ASBESTOS - NO ACCESS																
System	Component	Material	Item	Covering	A*	V*	AP*	Good	Fair	Poor	Unit	Sample	Asbestos Type	Amount	Hazard	Friable

Amalgamated into Location 2001

ALL DATA REPORT

Client: Hamilton-Wentworth Catholic District Sch
Location: #2008 : Classroom
Survey Date: 2018-06-06

Site: Elementary
Floor: 2

Building Name: Blessed Sacrament School
Room #: 17
Last Re-Assessment: 2022-05-11

Area (sqft): 0

ASBESTOS - NO ACCESS																
System	Component	Material	Item	Covering	A*	V*	AP*	Good	Fair	Poor	Unit	Sample	Asbestos Type	Amount	Hazard	Friable

Amalgamated into Location 2001

Client: Hamilton-Wentworth Catholic District Sch
Location: #2009 : Girls Washroom
Survey Date: 2018-06-06

Site: Elementary
Floor: 2

Building Name: Blessed Sacrament School
Room #:
Last Re-Assessment: 2022-05-11

Area (sqft): 0

ASBESTOS - NO ACCESS																
System	Component	Material	Item	Covering	A*	V*	AP*	Good	Fair	Poor	Unit	Sample	Asbestos Type	Amount	Hazard	Friable

Amalgamated into Location 2001

ALL DATA REPORT

Client: Hamilton-Wentworth Catholic District Sch
Location: #2010 : Math Room
Survey Date: 2018-06-06

Site: Elementary
Floor: 2

Building Name: Blessed Sacrament School
Room #:
Last Re-Assessment: 2022-05-11

Area (sqft): 0

ASBESTOS - NO ACCESS																
System	Component	Material	Item	Covering	A*	V*	AP*	Good	Fair	Poor	Unit	Sample	Asbestos Type	Amount	Hazard	Friable

Amalgamated into Location 2001

Client: Hamilton-Wentworth Catholic District Sch
Location: #2011 : Custodian
Survey Date: 2018-06-06

Site: Elementary
Floor: 2

Building Name: Blessed Sacrament School
Room #:
Last Re-Assessment: 2022-05-11

Area (sqft): 0

ASBESTOS - NO ACCESS																
System	Component	Material	Item	Covering	A*	V*	AP*	Good	Fair	Poor	Unit	Sample	Asbestos Type	Amount	Hazard	Friable

Amalgamated into Location 2001

ALL DATA REPORT

Client: Hamilton-Wentworth Catholic District Sch
Location: #2012 : Storage
Survey Date: 2018-06-06

Site: Elementary
Floor: 2

Building Name: Blessed Sacrament School
Room #:
Last Re-Assessment: 2022-05-11

Area (sqft): 0

ASBESTOS - NO ACCESS																
System	Component	Material	Item	Covering	A*	V*	AP*	Good	Fair	Poor	Unit	Sample	Asbestos Type	Amount	Hazard	Friable

Amalgamated into Location 2001

Client: Hamilton-Wentworth Catholic District Sch
Location: #2013 : Book Storage
Survey Date: 2018-06-06

Site: Elementary
Floor: 2

Building Name: Blessed Sacrament School
Room #:
Last Re-Assessment: 2022-05-11

Area (sqft): 0

ASBESTOS - NO ACCESS																
System	Component	Material	Item	Covering	A*	V*	AP*	Good	Fair	Poor	Unit	Sample	Asbestos Type	Amount	Hazard	Friable

Amalgamated into Location 2001

Legend:



Sample number		Units		Other	
S####	Asbestos sample collected	SF	Square feet	A	Access
V####	Material visually similar to numbered sample collected	LF	Linear feet	V	Visible
V0000	Known non-asbestos material	EA	Each	AP	Air Plenum
V9000	Visually identified as an asbestos material	%	Percentage	F	Friable material
V9500	Material is presumed to be an asbestos material			NF	Non Friable material
				PF	Potentially Friable material

Access	
A	Accessible to all building occupants
B	Accessible to maintenance and operations staff without a ladder
C	Accessible to maintenance and operations staff with a ladder. Also rarely entered, locked areas
D	Not normally accessible

Condition	
Good	No visible damage or deterioration
Fair	Minor, repairable damage, cracking, delamination or deterioration
Poor	Irreparable damage or deterioration with exposed and missing material

Visible	
Y	The material is visible when standing on the floor of the room, without the removal or opening of other building components (e.g. ceiling tiles or access panels).
N	The material is not visible to view when standing on the floor of the room and requires the removal of a building component (e.g. ceilings tiles or access panels) to view and access. Includes rarely entered crawlspaces, attic spaces, etc. Observations will be limited to the extent visible from the access points.

Air Plenum	
Yes or No	The material is in a return air plenum or in a direct airstream or there is evidence of air erosion (e.g. duct for heating or cooling blowing directly on or across an ACM). This field is only completed where Air Plenum consideration is required by regulation.

Colour Coding	
	The material is known to contain regulated concentrations of asbestos; either by analytical results or visible identification (use of the V9000 code).
	The material is presumed to contain asbestos; based on visual appearances; typically a material known to historically contain asbestos; however, not sampled due to limited access or the destructive nature of the sampling.

Action					
(1)	Clean up of ACM Debris	(2)	Precautions for Access Which may Disturb ACM Debris	(3)	ACM removal
(4)	Precautions for Work Which may Disturb ACM in Poor Condition	(5)	Proactive ACM removal (Minimum repair required for fair condition)	(6)	ACM repair
(7)	Management program and surveillance				

APPENDIX V
Drawings

NOT ALL KNOWN OR SUSPECTED ASBESTOS BUILDING MATERIALS MAY BE DEPICTED ON THE DRAWING. REFER TO THE ASBESTOS REASSESSMENT REPORT FOR A COMPLETE LIST OF KNOWN AND SUSPECTED ASBESTOS BUILDING MATERIALS.

LEGEND IS COLOUR DEPENDENT.
NON-COLOUR COPIES MAY ALTER INTERPRETATION.

BASE PLAN PROVIDED BY CLIENT.

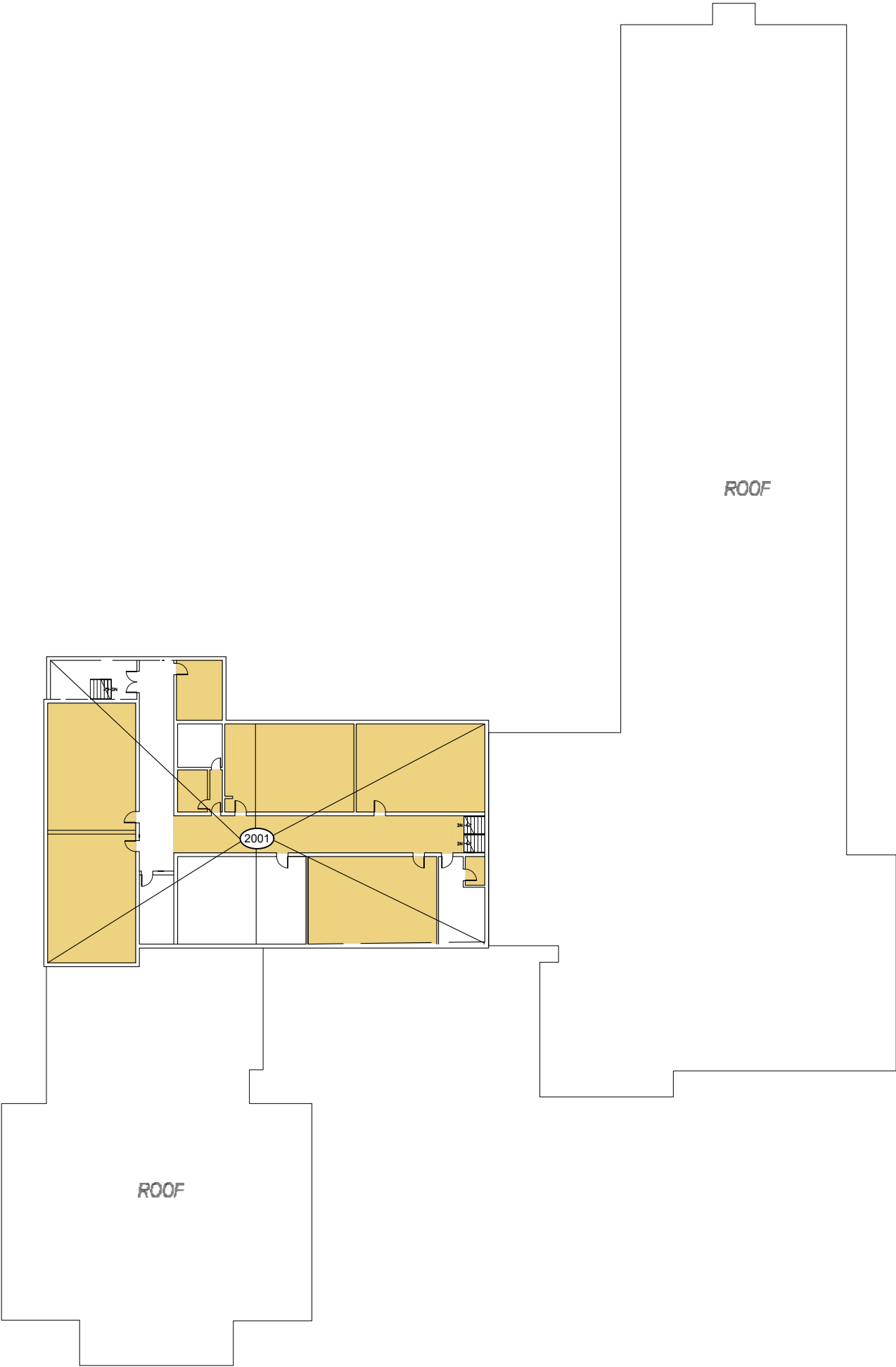

905-577-6206 www.pinchin.com

- LEGEND:
- (X) LOCATION NUMBER
 - ⊙ ASBESTOS BULK SAMPLE
- ASBESTOS-CONTAINING MATERIALS:
- VINYL FLOOR TILE & MASTIC
 - TRANSITE PANELING
 - PIPE INSULATION
 - FIRESTOPPING
 - SINK UNDERCOATING
 - MASTIC
 - CEILING TILES
 - TEXTURED PLASTER CEILING

CLIENT:



Hamilton-Wentworth
Catholic District School Board
Believing, Achieving, Serving

LOCATION:
BLESSED SACRAMENT
315 E 37TH STREET
HAMILTON, ONTARIO

TITLE:
ASBESTOS REASSESSMENT
SECOND FLOOR

DATE: AUGUST 2022	PROJECT # : 303992.004
DRAWN BY: EB	2 OF 2
CHECKED BY: EB	
SCALE: NTS	

NOT ALL KNOWN OR SUSPECTED ASBESTOS BUILDING MATERIALS MAY BE DEPICTED ON THE DRAWING. REFER TO THE ASBESTOS REASSESSMENT REPORT FOR A COMPLETE LIST OF KNOWN AND SUSPECTED ASBESTOS BUILDING MATERIALS.

LEGEND IS COLOUR DEPENDENT. NON-COLOUR COPIES MAY ALTER INTERPRETATION.

BASE PLAN PROVIDED BY CLIENT.

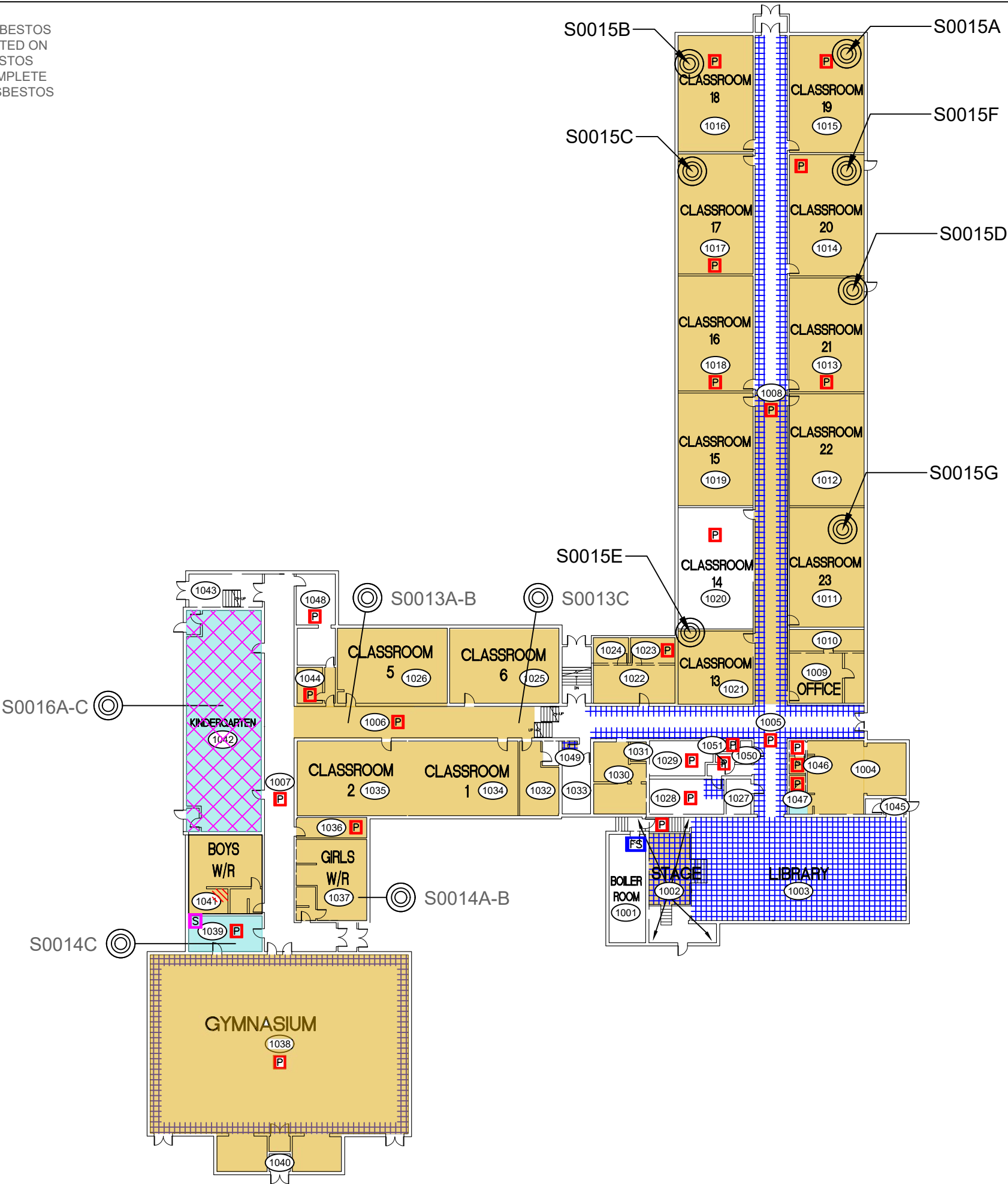

905-577-6206 www.pinchin.com

LEGEND:

- (X) LOCATION NUMBER
- ⊙ ASBESTOS BULK SAMPLE
- ASBESTOS-CONTAINING MATERIALS:
- VINYL FLOOR TILE & MASTIC
- TRANSITE PANELING
- PIPE INSULATION
- FIRESTOPPING
- SINK UNDERCOATING
- MASTIC
- CEILING TILES
- TEXTURED PLASTER CEILING

CLIENT:



Hamilton-Wentworth
Catholic District School Board
Believing, Achieving, Serving

LOCATION:

BLESSED SACRAMENT
315 E 37TH STREET
HAMILTON, ONTARIO

TITLE:

ASBESTOS REASSESSMENT
FIRST FLOOR

DATE:

AUGUST 2022

PROJECT # :

303992.004

DRAWN BY:

EB

CHECKED BY:

EB

SCALE:

NTS

DRAWING:

1 OF 2