



Asbestos Reassessment

St. Thomas More
1045 Upper Paradise Road,
Hamilton, Ontario

Prepared for:

**Hamilton-Wentworth Catholic
District School Board**

90 Mulberry Street
Hamilton, Ontario, L8N 3R9

December 30, 2021

Pinchin File: 286533.001



Asbestos Reassessment

St. Thomas More, 1045 Upper Paradise Road, Hamilton, Ontario
Hamilton-Wentworth Catholic District School Board

December 30, 2021
Pinchin File: 286533.001

Issued to: Hamilton-Wentworth Catholic District
School Board

Issued on: December 30, 2021

Pinchin File: 286533.001

Issuing Office: Hamilton, ON

Pinchin Contact: Michael Maiorana, Senior Project Manager
289.678.0697
mmaiorana@pinchin.com



Author:

Emily Balfour
Project Technologist
365.889.5147
ebalfour@pinchin.com

Reviewer:

Leslie Heywood, B.Eng.Mgt
Project Manager
289.237.4294
lheywood@pinchin.com



EXECUTIVE SUMMARY

Hamilton-Wentworth Catholic District School Board (Client) retained Pinchin Ltd. (Pinchin) to conduct an asbestos building materials reassessment at the subject building.

The objective of the reassessment was to evaluate the condition and quantity of previously reported asbestos-containing materials (ACM), and develop corrective action plans as required for the purposes of long-term management. The results of this reassessment are not intended for construction, renovation, demolition or project tendering purposes.

Summary of Recommendations

The following is a summary of significant recommendations; refer to the body of the report for detailed recommendations:

- Review and update the asbestos record for the site on an annual basis.
- Perform a pre-construction assessment and sample or remove any presumed asbestos-containing materials (ACM) prior to alteration or maintenance work if ACM may be disturbed by the work.
- Sample any presumed ACM prior to alteration or maintenance work if presumed ACM may be disturbed by the work.

This Executive Summary is subject to the same standard limitations as contained in the report and must be read in conjunction with the entire report.



Asbestos Reassessment

St. Thomas More, 1045 Upper Paradise Road, Hamilton, Ontario
Hamilton-Wentworth Catholic District School Board

December 30, 2021
Pinchin File: 286533.001

TABLE OF CONTENTS

1.0	INTRODUCTION AND SCOPE	1
1.1	Scope of Assessment	1
2.0	BACKGROUND INFORMATION	1
2.1	Building Year of Construction and Additions	1
2.2	Existing Reports	1
3.0	FINDINGS	2
3.1	Excluded Asbestos Materials	2
3.2	Confirmed/Presumed Asbestos-Containing Materials and Confirmed Non-Asbestos Materials	3
4.0	RECOMMENDATIONS	7
4.1	General	7
4.2	Remedial Work	7
4.3	On-going Management and Maintenance	7
5.0	TERMS AND LIMITATIONS	7
6.0	REFERENCES	8

APPENDICES

APPENDIX I	Asbestos Analytical Certificates
APPENDIX II	Location List
APPENDIX III	Hazardous Materials Summary / Sample Log Report
APPENDIX IV	All Data Report
APPENDIX V	Drawings



1.0 INTRODUCTION AND SCOPE

Hamilton-Wentworth Catholic District School Board (Client) retained Pinchin Ltd. (Pinchin to review and update the asbestos building materials assessment for St. Thomas More, located at 1045 Upper Paradise Road, Hamilton, Ontario.

The most recent reassessment was performed by Emily Balfour, Project Technologist on August 1, 2019. This report has been updated based on review of asbestos management records from the Client. There are no changes to report.

The objectives of the reassessment were to document the locations, quantities and conditions of previously identified asbestos-containing building materials, and develop corrective action plans as required. This reassessment is only to be used for the purposes of long-term management and routine maintenance. The results of this reassessment are not to be used for construction, renovation, demolition or project tendering purposes.

1.1 Scope of Assessment

The objective of the reassessment was to evaluate the condition and quantity of previously reported asbestos-containing materials (ACM's), and develop corrective action plans as required.

Additional objectives included sampling of presumed asbestos-containing vinyl floor tiles and mastic.

Refer to the Asbestos Building Materials Reassessment Methodology report and Annex A dated 2019, Pinchin File 243241, for the methodology used during the reassessment.

2.0 BACKGROUND INFORMATION

2.1 Building Year of Construction and Additions

Item	Details
Year of Construction	1992
Year(s) of Additions	2014

2.2 Existing Reports

2.2.1 Review of Previous Reports

Pinchin previously prepared the following report, which has been reviewed and relied upon as part of this assessment:



- Asbestos Assessment, St. Thomas More, 1045 Upper Paradise Road, Hamilton, Ontario, September 2018, Prepared by Pinchin Ltd., Pinchin File: 224334.

3.0 FINDINGS

The following section summarizes the findings of the reassessment and provides a general description of the asbestos materials identified. For details on quantities, assessment, sample numbers, friability, condition, and locations of asbestos materials; refer to the Hazardous Materials Summary / Sample Log Report and All Data Report in Appendices III and IV, respectively.

3.1 Excluded Asbestos Materials



A number of materials which might contain asbestos were not sampled during this reassessment due to limitations in scope and methodology. Where present, these materials are assumed to contain asbestos until otherwise proven by sampling and analysis. These materials are not shown on the drawings in Appendix V. Excluded materials presumed to contain asbestos include:



Material	Friability
Elevator and lift brakes	Non-friable
Firestopping	Potentially friable
Electrical components or wiring within control centers, breakers, motors or lights, insulation on wiring	Non-friable
Moulded plastic components (laboratory bench tops)	Non-friable
Vermiculite in concrete block wall cavities	Friable
Adhesives and duct mastics	Non-friable
Caulking and butyl seals	Non-friable
Paper products	Non-friable
Mechanical packing, ropes and gaskets	Non-friable
Vinyl baseboards	Non-friable
Exterior cladding	Non-friable

3.2 Confirmed/Presumed Asbestos-Containing Materials and Confirmed Non-Asbestos Materials

This section includes materials that have been confirmed asbestos-containing by sample analysis or presumed asbestos-containing by visual identification. The locations of samples from the current assessment, performed by Pinchin, have been included on the drawings in Appendix V.

Material and Application	Asbestos Type/Friability	Photo
Non-asbestos containing fireproofing is present on structural steel including beams, trusses, joists, corrugated steel deck, concrete deck, columns.	None	
Pipes are either uninsulated or insulated with non-asbestos fibreglass or elastomeric insulation (Armaflex).	None	
Ducts are either uninsulated or insulated with non-asbestos fibreglass (foil-faced or canvas).	None	
Mechanical equipment is either uninsulated or insulated with non-asbestos fibreglass.	None	
All ceiling tiles are presumed to be non-asbestos based on the date of manufacture determined from the date stamp applied to the top of the tiles or the age of the materials determined from the age of the building or the renovation	None	

Material and Application	Asbestos Type/Friability	Photo
Asbestos in drywall joint compound was banned in Canada in 1980. Drywall joint compound in the building was installed after 1986 (1980 plus a reasonable non-compliance period based on our experience) and is assumed to contain no asbestos.	None	
Vinyl floor tiles, 12"x12", pink dense fleck, are present.	None (tile) None (mastic)	
Vinyl floor tiles, 12"x12", green dense fleck, are present.	None (tile) None (mastic)	
Vinyl floor tiles, 12"x12", pink with pink and white lines, are present.	None (tile) None (mastic)	

Material and Application	Asbestos Type/Friability	Photo
Vinyl floor tiles, 12"x12", pink with pink and grey fleck, are present.	None (tile) None (mastic)	
Vinyl floor tiles, 12"x12", white with blue and black streak, are present.	None (tile) None (mastic)	
Vinyl floor tiles, 12"x12", beige with brown and white streak, are present.	None (tile) None (mastic)	

Material and Application	Asbestos Type/Friability	Photo
Vinyl floor tiles, 12"x12", black with white streak, are present.	None (tile) None (mastic)	
Vinyl floor tiles, 12"x12", pink marble, are present.	None (tile) None (mastic)	
Vinyl floor tiles, 12"x12", beige with brown fleck, are present.	None (tile) None (mastic)	
Vinyl floor tiles in the 2014 addition were presumed to be non-asbestos based on historical knowledge of the date of installation.	None	



4.0 RECOMMENDATIONS

4.1 General

Perform a detailed intrusive assessment prior to building renovation or demolition operations. The assessment should include; destructive testing (i.e. coring and/or removal of building finishes and components), sampling of other hazardous materials (lead, mercury, PCBs, mould, etc.), and materials not tested in this study (i.e. excluded asbestos materials).

4.2 Remedial Work

There is no remedial work recommended.

4.3 On-going Management and Maintenance

The following recommendations are made regarding on-going management and maintenance work involving the asbestos materials identified.

4.3.1 Asbestos

Maintain the Asbestos Management Program (AMP). Update the asbestos record on an annual basis.

Sample presumed ACM prior to alteration or maintenance work if the presumed ACM may be disturbed by the work.

Update the asbestos inventory report upon completion of any abatement and removal of asbestos-containing materials.

5.0 TERMS AND LIMITATIONS

This work was performed subject to the Terms and Limitations presented or referenced in the proposal for this project.

Information provided by Pinchin is intended for Client use only. Pinchin will not provide results or information to any party unless disclosure by Pinchin is required by law. Any use by a third party of reports or documents authored by Pinchin or any reliance by a third party on or decisions made by a third party based on the findings described in said documents, is the sole responsibility of such third parties. Pinchin accepts no responsibility for damages suffered by any third party as a result of decisions made or actions conducted. No other warranties are implied or expressed.



Asbestos Reassessment

St. Thomas More, 1045 Upper Paradise Road, Hamilton, Ontario
Hamilton-Wentworth Catholic District School Board

December 30, 2021
Pinchin File: 286533.001

6.0 REFERENCES

The following legislation and documents were referenced in completing the assessment and this report:

1. Asbestos on Construction Projects and in Buildings and Repair Operations, Ontario Regulation 278/05.
2. Designated Substances, Ontario Regulation 490/09.

\\pinchin.com\ham\Job\286000s\0286533.000 HWCDSB, Various 2021 Projects, ASB, CONS\0286533.001 HWCDSB, All Facilities, 2021, ASB, REASSMT\Deliverables\2018 Updates\St Thomas More\286553.001 St. Thomas More ACM Reassessment Report HWCDSB December 30 2021.docx

Template: Master Report for Asbestos Reassessment, HAZ, April 23, 2019

APPENDIX I
Asbestos Analytical Certificates



Bulk Asbestos Analysis

By Polarized Light Microscopy
EPA Method: 600/R-93/116 and 40 CFR, Part 763, Subpart E,
App.E



Customer: Pinchin Ltd.
6-875 Main St West
Suite 200
Hamilton, Ontario L8S 4P9

Attn: Emily Balfour
Michael Maiorana

Lab Order ID: 71920806
Analysis ID: 71920806_PLM
Date Received: 8/7/2019
Date Reported: 8/16/2019

Project: 230748,1045 Upper Paradise Road, Hamilton, Ontario,Hamilton-Wentworth Catholic School Board,St. Thomas More

Sample ID	Description	Asbestos	Fibrous Components	Non-Fibrous Components	Attributes
Lab Sample ID	Lab Notes				Treatment
S0001A - A	Vinyl floor tile, 12x12 pink dense fleck, Location 1001	None Detected		100% Other	Pink Non Fibrous Heterogeneous
71920806PLM_1	tile				Dissolved
S0001A - B	Vinyl floor tile, 12x12 pink dense fleck, Location 1001	None Detected		100% Other	Black Non Fibrous Heterogeneous
71920806PLM_10	mastic				Dissolved
S0001B - A	Vinyl floor tile, 12x12 green dense fleck, Location 1001	None Detected		100% Other	Green Non Fibrous Heterogeneous
71920806PLM_2	tile				Dissolved
S0001B - B	Vinyl floor tile, 12x12 green dense fleck, Location 1001	None Detected		100% Other	Black Non Fibrous Heterogeneous
71920806PLM_11	mastic				Dissolved
S0001C - A	Vinyl floor tile, 12x12 pink with pink and white lines, Location 1001	None Detected		100% Other	Pink Non Fibrous Heterogeneous
71920806PLM_3	tile				Dissolved
S0001C - B	Vinyl floor tile, 12x12 pink with pink and white lines, Location 1001	None Detected		100% Other	Black Non Fibrous Heterogeneous
71920806PLM_12	mastic				Dissolved
S0002A - A	Vinyl floor tile, 12x12 pink with pink and grey fleck, Location 1001	None Detected		100% Other	Pink Non Fibrous Heterogeneous
71920806PLM_4	tile				Dissolved
S0002A - B	Vinyl floor tile, 12x12 pink with pink and grey fleck, Location 1001	None Detected		100% Other	Yellow Non Fibrous Heterogeneous
71920806PLM_13	mastic				Dissolved

Disclaimer: Due to the nature of the EPA 600 method, asbestos may not be detected in samples containing low levels of asbestos. We strongly recommend that analysis of floor tiles, vermiculite, and/or heterogeneous soil samples be conducted by TEM for confirmation of "None Detected" by PLM. This report relates only to the samples tested and may not be reproduced, except in full, without the written approval of SAL. This report may not be used by the client to claim product endorsement by NVLAP or any other agency of the U.S. government. Analytical uncertainty available upon request. Scientific Analytical Institute participates in the NVLAP Proficiency Testing program. Unless otherwise noted blank sample correction was not performed. Estimated MDL is 0.1%.

Jalen Moore (18)

Analyst

Approved Signatory



Bulk Asbestos Analysis

By Polarized Light Microscopy
EPA Method: 600/R-93/116 and 40 CFR, Part 763, Subpart E,
App.E



Customer: Pinchin Ltd.
6-875 Main St West
Suite 200
Hamilton, Ontario L8S 4P9

Attn: Emily Balfour
Michael Maiorana

Lab Order ID: 71920806
Analysis ID: 71920806_PLM
Date Received: 8/7/2019
Date Reported: 8/16/2019

Project: 230748,1045 Upper Paradise Road, Hamilton, Ontario,Hamilton-Wentworth Catholic School Board,St. Thomas More

Sample ID	Description	Asbestos	Fibrous Components	Non-Fibrous Components	Attributes
Lab Sample ID	Lab Notes				Treatment
S0002B - A	Vinyl floor tile, 12x12 white with blue and black streak, Location 1001	None Detected		100% Other	White Non Fibrous Heterogeneous
71920806PLM_5	tile				Dissolved
S0002B - B	Vinyl floor tile, 12x12 white with blue and black streak, Location 1001	None Detected		100% Other	Black Non Fibrous Heterogeneous
71920806PLM_14	mastic				Dissolved
S0002C - A	Vinyl floor tile, 12x12 beige with brown and white streak, Location 1001	None Detected		100% Other	Beige Non Fibrous Heterogeneous
71920806PLM_6	tile				Dissolved
S0002C - B	Vinyl floor tile, 12x12 beige with brown and white streak, Location 1001	None Detected		100% Other	Black Non Fibrous Heterogeneous
71920806PLM_15	mastic				Dissolved
S0003A - A	Vinyl floor tile, 12x12 black with white streak, Location 1001	None Detected		100% Other	Black Non Fibrous Heterogeneous
71920806PLM_7	tile				Dissolved
S0003A - B	Vinyl floor tile, 12x12 black with white streak, Location 1001	None Detected		100% Other	Black Non Fibrous Heterogeneous
71920806PLM_16	mastic				Dissolved
S0003B - A	Vinyl floor tile, 12x12 pink marble, Location 1001	None Detected		100% Other	Pink Non Fibrous Heterogeneous
71920806PLM_8	tile				Dissolved
S0003B - B	Vinyl floor tile, 12x12 pink marble, Location 1001	None Detected		100% Other	Black Non Fibrous Heterogeneous
71920806PLM_17	mastic				Dissolved

Disclaimer: Due to the nature of the EPA 600 method, asbestos may not be detected in samples containing low levels of asbestos. We strongly recommend that analysis of floor tiles, vermiculite, and/or heterogeneous soil samples be conducted by TEM for confirmation of "None Detected" by PLM. This report relates only to the samples tested and may not be reproduced, except in full, without the written approval of SAI. This report may not be used by the client to claim product endorsement by NVLAP or any other agency of the U.S. government. Analytical uncertainty available upon request. Scientific Analytical Institute participates in the NVLAP Proficiency Testing program. Unless otherwise noted blank sample correction was not performed. Estimated MDL is 0.1%.

Jalen Moore (18)

Analyst

Approved Signatory



Bulk Asbestos Analysis

By Polarized Light Microscopy
EPA Method: 600/R-93/116 and 40 CFR, Part 763, Subpart E,
App.E



Customer: Pinchin Ltd.
6-875 Main St West
Suite 200
Hamilton, Ontario L8S 4P9

Attn: Emily Balfour
Michael Maiorana

Lab Order ID: 71920806
Analysis ID: 71920806_PLM
Date Received: 8/7/2019
Date Reported: 8/16/2019

Project: 230748,1045 Upper Paradise Road, Hamilton, Ontario,Hamilton-Wentworth Catholic School Board,St. Thomas More

Sample ID	Description	Asbestos	Fibrous Components	Non-Fibrous Components	Attributes
Lab Sample ID	Lab Notes				Treatment
S0003C - A	Vinyl floor tile, 12x12 beige with brown fleck, Location 1001	None Detected		100% Other	Beige Non Fibrous Heterogeneous
71920806PLM_9	tile				Dissolved
S0003C - B	Vinyl floor tile, 12x12 beige with brown fleck, Location 1001	None Detected		100% Other	Black Non Fibrous Heterogeneous
71920806PLM_18	mastic				Dissolved

Disclaimer: Due to the nature of the EPA 600 method, asbestos may not be detected in samples containing low levels of asbestos. We strongly recommend that analysis of floor tiles, vermiculite, and/or heterogeneous soil samples be conducted by TEM for confirmation of "None Detected" by PLM. This report relates only to the samples tested and may not be reproduced, except in full, without the written approval of SAI. This report may not be used by the client to claim product endorsement by NVLAP or any other agency of the U.S. government. Analytical uncertainty available upon request. Scientific Analytical Institute participates in the NVLAP Proficiency Testing program. Unless otherwise noted blank sample correction was not performed. Estimated MDL is 0.1%.

Jalen Moore (18)

Analyst

Approved Signatory



Once
Ecol



71920806

Instructions:

Analyzed by: _____

Reviewed by: _____

Report Sent by: _____

**Pinchin Ltd. - Asbestos Laboratory
Internal Asbestos Bulk Sample Chain of Custody**

Client Name:	Hamilton-Wentworth Catholic School Board	Project Address:	1045 Upper Paradise Road, Hamilton, Ontario
Portfolio/Building No:	St. Thomas More	Pinchin File:	230748
Submitted by:	Emily Balfour	Email:	ebalfour@pinchin.com
CC Results to:	Michael Maiorana	CC Email:	mmaiorana@pinchin.com
Invoice to:	Accounts Payable	Invoice Email:	ap@pinchin.com
Date Submitted:	August 2 2019	Required by:	August 9 2019
# of Samples:	9	Priority:	5 Day Turnaround
Year of Building Construction (Mandatory Field):	1992		
Do NOT Stop on Positive (Sample Numbers):	S0001, S0002, S0003		
Pinchin Group Company (Mandatory Field):	Pinchin		

To be Completed by Lab Personnel Only:

Lab Reference #:		Time:	24 hour clock		
Received by:	AUG 06 2019	Date:	Month	Day	Year
Name(s) of Analyst(s):					

Sample Prefix	Sample No.	Sample Suffix	Sample Description/Location (Mandatory)
	S0001	A	Vinyl floor tile, 12x12 pink dense fleck, Location 1001
	S0001	B	Vinyl floor tile, 12x12 green dense fleck, Location 1001
	S0001	C	Vinyl floor tile, 12x12 pink with pink and white lines, Location 1001
	S0002	A	Vinyl floor tile, 12x12 pink with pink and grey fleck, Location 1001
	S0002	B	Vinyl floor tile, 12x12 white with blue and black streak, Location 1001
	S0002	C	Vinyl floor tile, 12x12 beige with brown and white streak, Location 1001

Accepted
Rejected

N. Kiang 8/7 10:30A

71920806

Sample Prefix	Sample No.	Sample Suffix	Sample Description/Location (Mandatory)
	S0003	A	Vinyl floor tile, 12x12 black with white streak, Location 1001
	S0003	B	Vinyl floor tile, 12x12 pink marble, Location 1001
	S0003	C	Vinyl floor tile, 12x12 beige with brown fleck, Location 1001

11920806

Version 1-15-2012

Client:	Pinchin Ltd.	*Instructions: Use Column "B" for your contact info To See an Example Click the bottom Example Tab. Enter samples between "<<" and ">>" Begin Samples with a "<<" above the first sample and end with a ">>" below the last sample. Only Enter your data on the first sheet "Sheet1" Note: Data 1 and Data 2 are optional fields that do not show up on the official report, however they will be included in the electronic data returned to you to facilitate your reintegration of the report data.	Invoice to: ap@pinchin.com  Scientific Analytical Institute 4604 Dundas Dr. Greensboro, NC 27407 Phone: 336.292.3888 Fax: 336.292.3313 Email: lab@saiiab.com
Contact:	Emily Balfour		
Address:	6-875 Main Street West, Suite 200, Hamilton ON L8S 4P9		
Phone:	905-577-6206		
Fax:	905-577-6207		
Email:	ebalfour@pinchin.com mmaiorana@pinchin.com 230748, 1045 Upper Paradise Road, Hamilton, Ontario, Hamilton- Wentworth Catholic School Board, St. Thomas More		
Project:			
Client Notes:			
P.O. #:	230748		
Date Submitted:	August 6, 2019		
Analysis:	PLM - Stop Positive EXCEPT S0001, S0002, S0003		
TurnAroundTime:	4days		

Sample Number	Data 1 (Lab use only)	Sample Description	Data 2 (Lab use only)
<<			
S0001A		Vinyl floor tile, 12x12 pink dense fleck, Location 1001	
S0001B		Vinyl floor tile, 12x12 green dense fleck, Location 1001	
S0001C		Vinyl floor tile, 12x12 pink with pink and white lines, Location 1001	
S0002A		Vinyl floor tile, 12x12 pink with pink and grey fleck, Location 1001	
S0002B		Vinyl floor tile, 12x12 white with blue and black streak, Location 1001	
S0002C		Vinyl floor tile, 12x12 beige with brown and white streak, Location 1001	
S0003A		Vinyl floor tile, 12x12 black with white streak, Location 1001	
S0003B		Vinyl floor tile, 12x12 pink marble, Location 1001	
S0003C		Vinyl floor tile, 12x12 beige with brown fleck, Location 1001	
>>			

APPENDIX II
Location List

Client:Hamilton-Wentworth Catholic District Sch

Building Name: St Thomas More

Surveyor: Matt Gibbs

Reassessment Surveyor: Emily Balfour

Site: 1045 Upper Paradise Road, Hamilton, ON

Survey Date:

Last Re-Assessment: 2019-08-01

Location No.	Name or Description	ft ²	Floor No.	Notes
1001	Entire Building	0		

APPENDIX III

Hazardous Materials Summary / Sample Log Report

Client: Hamilton-
Wentworth Catholic
District Sch

Site: 1045 Upper Paradise Road, Hamilton, ON

Building Name: St Thomas More

Surveyor: Matt Gibbs

Survey Date: 2018-08-27

HAZMAT	Sample No	System/Material/Sample Description	Locations	LF	SF	EA	%	Type	Positive
Asbestos	S0001 A	FLOOR VINYL FLOOR TILE AND MASTIC 12X12 PINK DENSE FLECK	1001	0	0	0	0	None Detected	No
Asbestos	S0002 A	FLOOR VINYL FLOOR TILE AND MASTIC 12X12 PINK WITH PINK AND GREY FLECK	1001	0	0	0	0	None Detected	No
Asbestos	S0003 A	FLOOR VINYL FLOOR TILE AND MASTIC 12X12 BLACK WITH WHITE STREAK	1001	0	0	0	0	None Detected	No
Asbestos	V9500	DUCT MASTIC	1001	0	0	0	100	Presumed Asbestos	Yes
Asbestos	V9500	FLOOR WALL COVERING VINYL BASEBOARDS AND ADHESIVE	1001	0	0	0	50	Presumed Asbestos	Yes
Asbestos	V9500	OTHER CAULKING	1001	0	0	0	33	Presumed Asbestos	Yes
Asbestos	V9500	OTHER TEXTILE	1001	0	0	0	25	Presumed Asbestos	Yes
Asbestos	V9500	PIPING GASKET	1001	0	0	0	20	Presumed Asbestos	Yes
Asbestos	V9500	WALL VERMICULITE/CONCRETE BLOCK WALLS	1001	0	0	0	17	Presumed Asbestos	Yes
Asbestos	V0000	CEILING CEILING TILES (LAY-IN)	1001	0	0	0	75	Non Asbestos	No
Asbestos	V0000	CEILING DRYWALL AND JOINT COMPOUND	1001	0	0	0	25	Non Asbestos	No
Asbestos	V0000	DUCT FIBREGLASS	1001	0	0	0	0	Non Asbestos	No
Asbestos	V0000	DUCT NOT INSULATED	1001	0	0	0	0	Non Asbestos	No
Asbestos	V0000	FLOOR CERAMIC TILES	1001	0	0	0	0	Non Asbestos	No
Asbestos	V0000	FLOOR TERRAZZO	1001	0	0	0	0	Non Asbestos	No
Asbestos	V0000	FLOOR VINYL FLOOR TILE AND MASTIC 12X12 GREEN DENSE FLECK (SAMPLE S0001B), 12X12 PINK WITH PINK AND WHITE LINES (SAMPLE S0001C), 12X12 WHITE WITH BLUE AND BLACK STREAK (SAMPLE S0002B), 12X12 BEIGE WITH BROWN AND WHITE STREAK (SAMPLE S0002C), 12X12 PINK MARBLE (SAMPLE S0003B), 12X12 BEIGE WITH BROWN FLECK (SAMPLE S0003C)	1001	0	0	0	0	Non Asbestos	No
Asbestos	V0000	MECHANICAL EQUIPMENT FIBREGLASS	1001	0	0	0	0	Non	No

HAZARDOUS MATERIALS SUMMARY / SAMPLE LOG

								Asbestos	
Asbestos	V0000	OTHER METAL	1001	0	0	0	0	Non Asbestos	No
Asbestos	V0000	PIPING FIBREGLASS	1001	0	0	0	0	Non Asbestos	No
Asbestos	V0000	PIPING NOT INSULATED	1001	0	0	0	0	Non Asbestos	No
Asbestos	V0000	STRUCTURE FIREPROOFING (FIBROUS)	1001	0	500	0	0	Non Asbestos	No
Asbestos	V0000	STRUCTURE METAL	1001	0	0	0	0	Non Asbestos	No
Asbestos	V0000	WALL DRYWALL AND JOINT COMPOUND	1001	0	0	0	25	Non Asbestos	No
Asbestos	V0000	WALL MASONRY	1001	0	0	0	75	Non Asbestos	No

APPENDIX IV
All Data Report

ALL DATA REPORT

Client: Hamilton-Wentworth Catholic District Sch
Location: #1001 : Entire Building
Surveyor: Matt Gibbs

Site: Secondary
Floor:
Survey Date: 2018-08-27

Building Name: St Thomas More
Room #:
Reassessment Surveyor: Emily Balfour

Area (sqft): 0
Last Re-Assessment: 2019-08-01

ASBESTOS															
System	Component	Material	Item	Covering	A*	V*	AP*	Good	Fair	Poor	Unit	Sample	Asbestos Type	Amount	Hazard
Ceiling	ACOUSTIC TILE	Ceiling Tiles (lay-in)	ALL		C	Y		75			%	V0000	Non-Asbestos		None
Ceiling		Drywall and joint compound	ALL		C	Y		25			%	V0000	Non-Asbestos		None
Duct		Fibreglass	ALL		C	N						V0000	Non-Asbestos		None
Duct		Not Insulated	ALL		C	N						V0000	Non-Asbestos		None
Duct		Mastic	ALL		C	N		100			%	V9500	Presumed Asbestos		Presumed Asbestos(NF)
Floor		Vinyl Floor Tile and Mastic, 12x12 pink dense fleck			A	Y						S0001A	None Detected	N.D.	None
Floor		Vinyl Floor Tile and Mastic, 12x12 green dense fleck (sample S0001B)			A	Y						V0000	Non-Asbestos		None
Floor		Vinyl Floor Tile and Mastic, 12x12 pink with pink and white lines (sample S0001C)			A	Y						V0000	Non-Asbestos		None
Floor		Vinyl Floor Tile and Mastic, 12x12 pink with pink and grey fleck			A	Y						S0002A	None Detected	N.D.	None
Floor		Vinyl Floor Tile and Mastic, 12x12 white with blue and black streak (sample S0002B)			A	Y						V0000	Non-Asbestos		None
Floor		Vinyl Floor Tile and Mastic, 12x12 beige with brown and white streak (sample S0002C)			A	Y						V0000	Non-Asbestos		None
Floor		Vinyl Floor Tile and Mastic, 12x12 black with white streak			A	Y						S0003A	None Detected	N.D.	None
Floor		Vinyl Floor Tile and Mastic, 12x12 pink marble (sample S0003B)			A	Y						V0000	Non-Asbestos		None
Floor		Vinyl Floor Tile and Mastic, 12x12 beige with brown fleck (sample S0003C)			A	Y						V0000	Non-Asbestos		None
Floor		Ceramic Tiles	ALL		A	Y						V0000	Non-Asbestos		None
Floor		Terrazzo	ALL		A	Y						V0000	Non-Asbestos		None
Floor		Wall covering, vinyl baseboards and adhesive			A	Y		100			%	V9500	Presumed Asbestos		Presumed Asbestos(NF)
Mechanical Equipment	All	Fibreglass	ALL		B	Y						V0000	Non-Asbestos		None
Other	Drain	Metal	ALL	Fibreglass	C	N						V0000	Non-Asbestos		None
Other	Electrical Equipment	Textile			D	N		100			%	V9500	Presumed Asbestos		Presumed Asbestos(NF)
Other		Caulking			A	Y		100			%	V9500	Presumed Asbestos		Presumed

ALL DATA REPORT

ASBESTOS															
System	Component	Material	Item	Covering	A*	V*	AP*	Good	Fair	Poor	Unit	Sample	Asbestos Type	Amount	Hazard
															Asbestos(NF)
Piping	All	Fibreglass	ALL		C	N						V0000	Non-Asbestos		None
Piping	All	Not Insulated	ALL		C	N						V0000	Non-Asbestos		None
Piping		Gasket			D	N		100			%	V9500	Presumed Asbestos		Presumed Asbestos(NF)
Structure	All	Metal	ALL		C	N						V0000	Non-Asbestos		None
Structure	Beam	Fireproofing (Fibrous)	ALL		C	Y		500			SF	V0000	Non-Asbestos		None
Wall		Drywall and joint compound	ALL		A	Y		25			%	V0000	Non-Asbestos		None
Wall		Masonry	ALL		A	Y		75			%	V0000	Non-Asbestos		None
Wall		Vermiculite/concrete block walls			D	N		100			%	V9500	Presumed Asbestos		Presumed Asbestos(F)

Legend:

Sample number		Units		Other	
S####	Sample collected.	SF	Square feet	SVM	Suspect Visible Mould
V####	Material is visually identified to be identical to S####	LF	Linear feet	A	Access
V0000	Known non hazardous material.	EA	Each	V	Visible
V9000	Material is visually identified to contain hazardous material.	%	Percentage	AP	Air Plenum
V9500	Material is presumed to contain hazardous material.			F	Friable material.
				NF	Non Friable material.

Access		Condition	
A	Accessible to all building occupants	Good	No visible damage or deterioration
B	Accessible to maintenance and operations staff without a ladder	Fair	Minor, repairable damage, cracking or deterioration.
C	Accessible to maintenance and operations staff with a ladder. Also rarely entered, locked areas.	Poor	Irreparable damage or deterioration with exposed and missing material.
D	Not normally accessible or without demolition		

APPENDIX V
Drawings



905-577-6206

www.pinchin.com

LEGEND:

- (X) LOCATION NUMBER
- ⊙ ASBESTOS BULK SAMPLE
- 2014 ADDITION

NOT ALL KNOWN OR SUSPECTED ASBESTOS BUILDING MATERIALS MAY BE DEPICTED ON THE DRAWING. REFER TO THE ASBESTOS REASSESSMENT REPORT FOR A COMPLETE LIST OF KNOWN AND SUSPECTED ASBESTOS BUILDING MATERIALS.

LEGEND IS COLOUR DEPENDENT. NON-COLOUR COPIES MAY ALTER INTERPRETATION.

BASE PLAN PROVIDED BY CLIENT.

CLIENT:



Hamilton-Wentworth
Catholic District School Board
Believing. Achieving. Serving

LOCATION:

ST. THOMAS MORE
1045 UPPER PARADISE ROAD
HAMILTON, ONTARIO

TITLE:

ASBESTOS REASSESSMENT
FLOOR LEVEL 1

DATE:

SEPTEMBER 2019

PROJECT # :

243241

DRAWN BY:

SR

DRAWING:

CHECKED BY:

E.B

SCALE:

NTS

1 OF 3

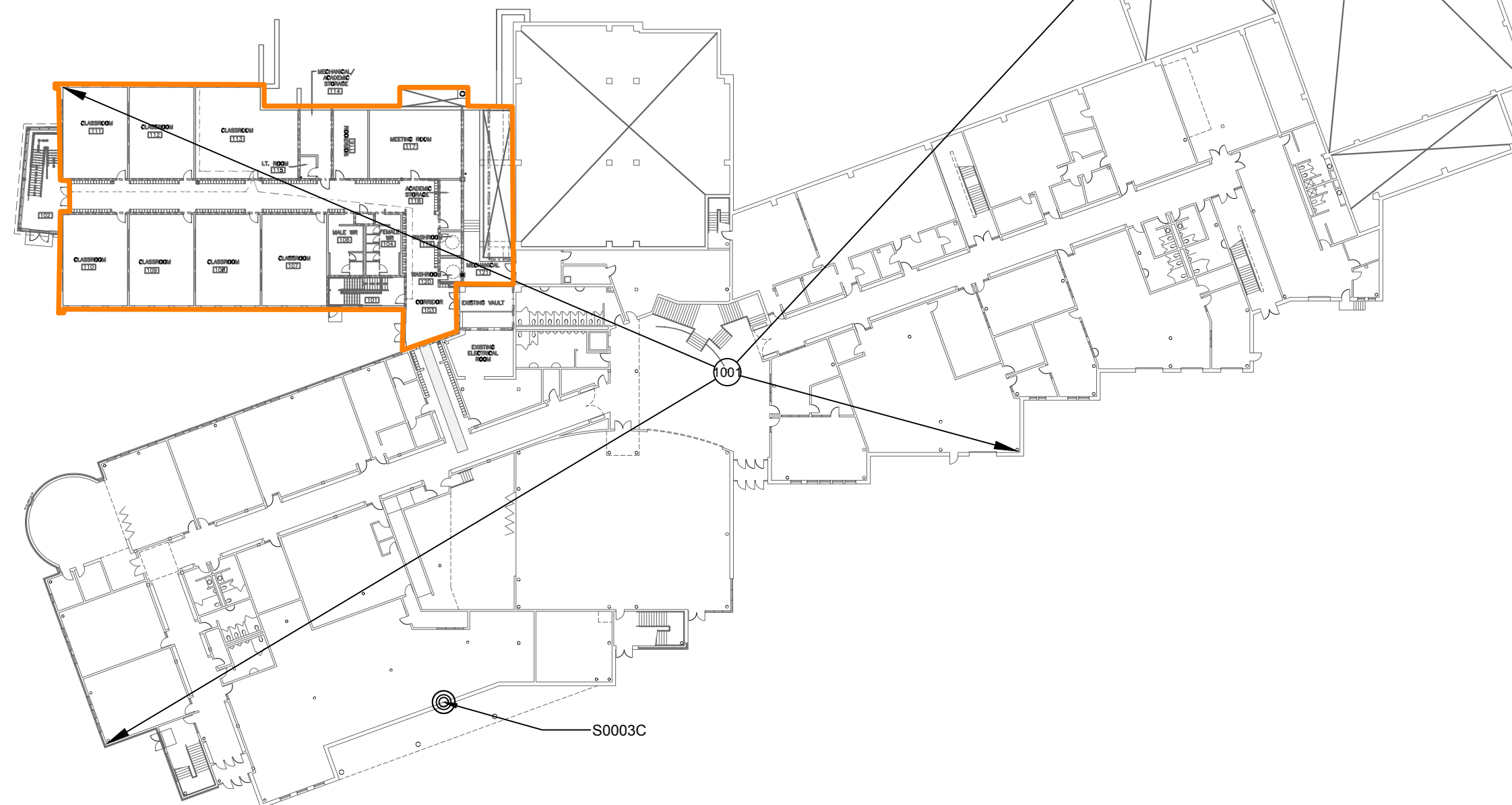

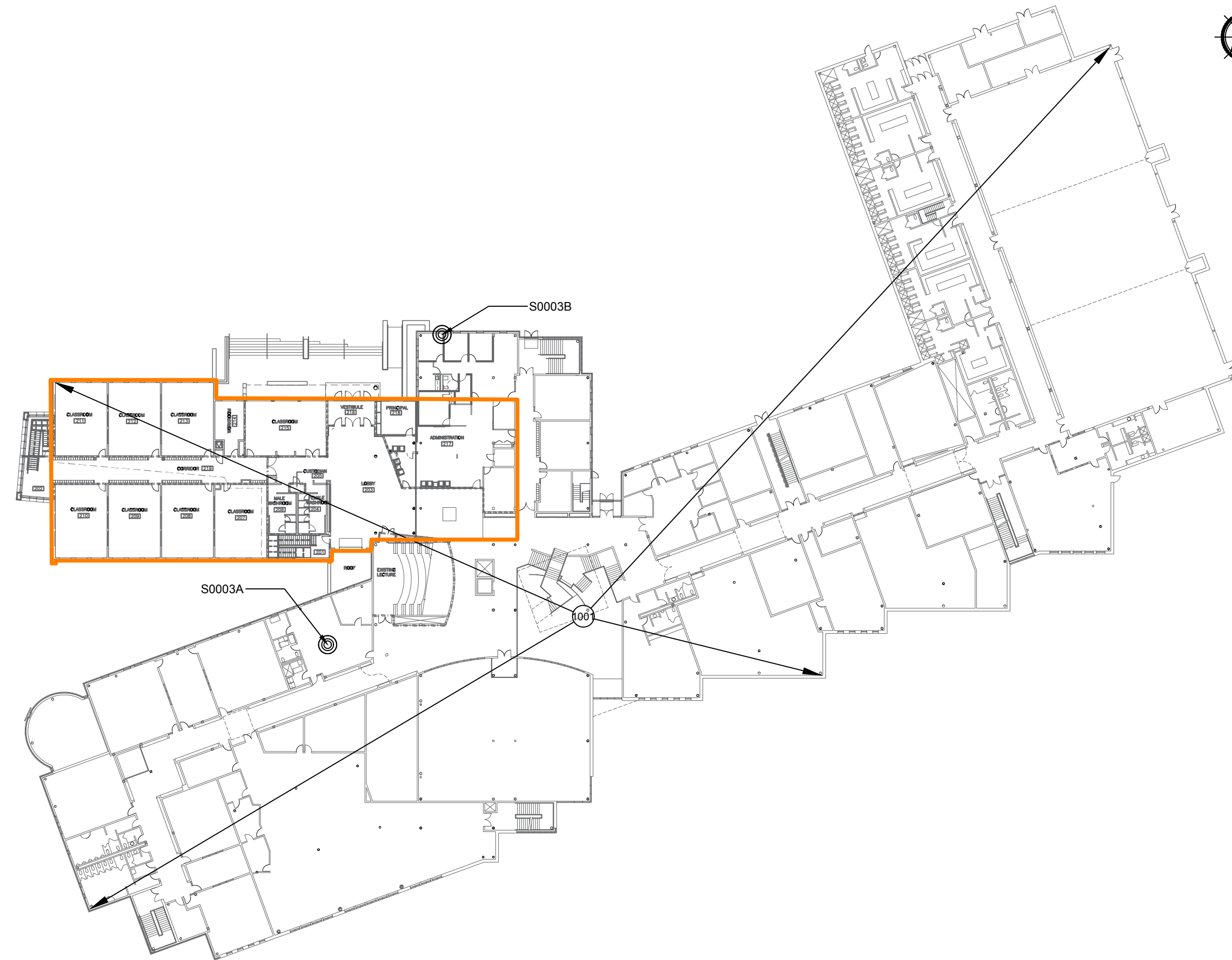

905-577-6206 www.pinchin.com

- LEGEND:
- (X) LOCATION NUMBER
 - ◎ ASBESTOS BULK SAMPLE
 - 2014 ADDITION

NOT ALL KNOWN OR SUSPECTED ASBESTOS BUILDING MATERIALS MAY BE DEPICTED ON THE DRAWING. REFER TO THE ASBESTOS REASSESSMENT REPORT FOR A COMPLETE LIST OF KNOWN AND SUSPECTED ASBESTOS BUILDING MATERIALS.

LEGEND IS COLOUR DEPENDENT. NON-COLOUR COPIES MAY ALTER INTERPRETATION.

BASE PLAN PROVIDED BY CLIENT.

CLIENT:



**Hamilton-Wentworth
Catholic District School Board**
Believing. Achieving. Serving

LOCATION:
ST. THOMAS MORE
1045 UPPER PARADISE ROAD
HAMILTON, ONTARIO

TITLE:

ASBESTOS REASSESSMENT
FLOOR LEVEL 2

DATE: AUGUST 2019	PROJECT # : 243241
DRAWN BY: SR	2 OF 3
CHECKED BY: E.B	
SCALE: NTS	



905-577-6206

www.pinchin.com

LEGEND:

- (X) LOCATION NUMBER
- ⊙ ASBESTOS BULK SAMPLE
- 2014 ADDITION

NOT ALL KNOWN OR SUSPECTED ASBESTOS BUILDING MATERIALS MAY BE DEPICTED ON THE DRAWING. REFER TO THE ASBESTOS REASSESSMENT REPORT FOR A COMPLETE LIST OF KNOWN AND SUSPECTED ASBESTOS BUILDING MATERIALS.

LEGEND IS COLOUR DEPENDENT. NON-COLOUR COPIES MAY ALTER INTERPRETATION.

BASE PLAN PROVIDED BY CLIENT.

CLIENT:



Hamilton-Wentworth
Catholic District School Board
Believing. Achieving. Serving

LOCATION:

ST. THOMAS MORE
1045 UPPER PARADISE ROAD
HAMILTON, ONTARIO

TITLE:

ASBESTOS REASSESSMENT
FLOOR LEVEL 3

DATE:

AUGUST 2019

PROJECT # :

243241

DRAWN BY:

SR

DRAWING:

CHECKED BY:

E.B

SCALE:

NTS

3 OF 3

